

imageRUNNER ADVANCE DX C5800 Series

POWERFUL PRODUCTIVITY FROM SECURE COLOUR A3 MULTIFUNCTION DEVICES



Canon Europe Ltd.
EU 2022-2024 Most Reliable A3 Brand



Canon uniFLOW OnJine
Outstanding Cloud Output Management Solution



Canon Europe Ltd.
EU 2022-24 Line of the Year

MAIN CONFIGURATION OPTIONS

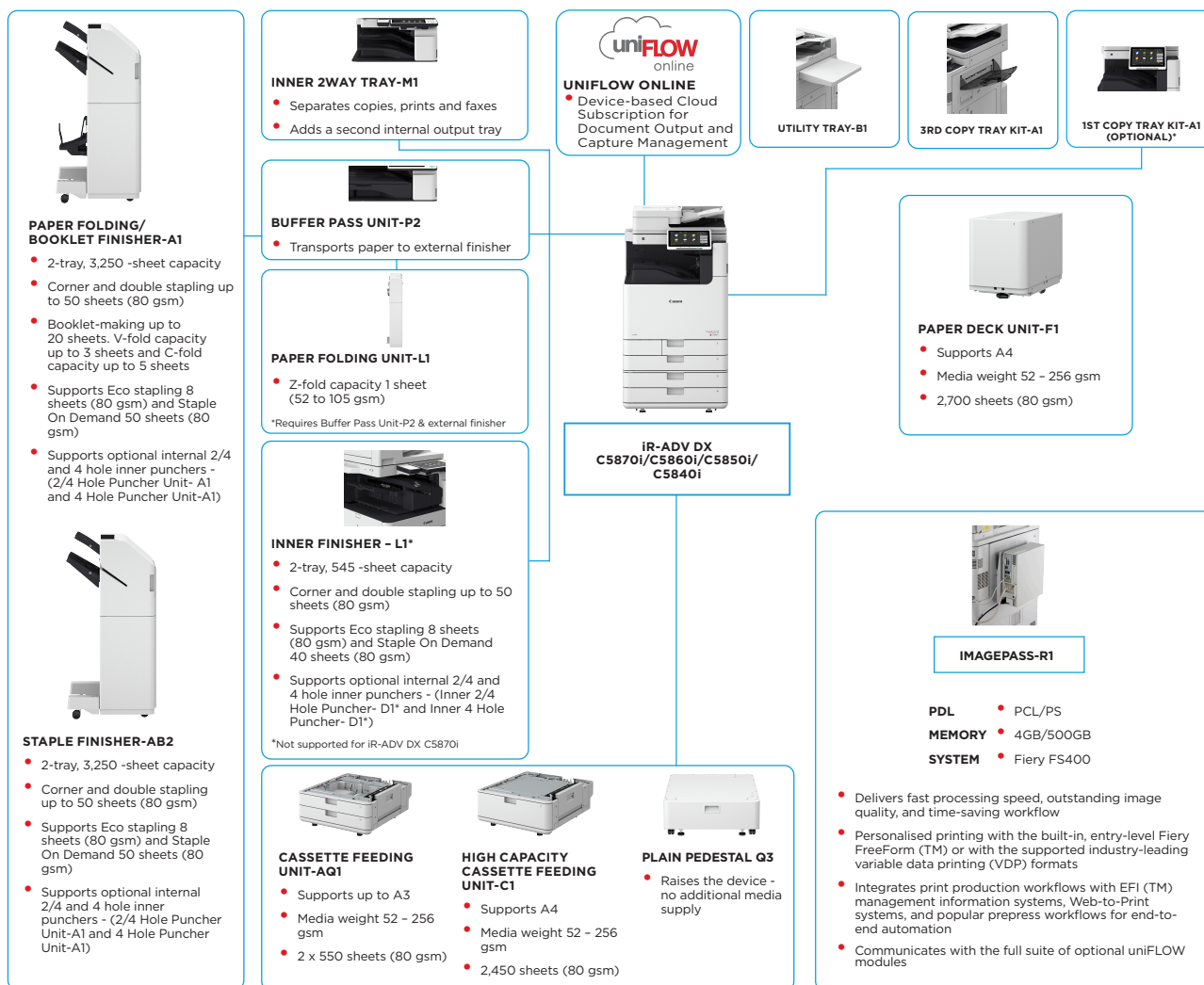

This flat configuration is for illustration purpose only. For a complete list of options and the exact compatibility relationships, please refer to the [online product configurator](#).

The Unified Firmware Platform (UFP) ensures that the latest feature upgrades and protection are available, for an enhanced user experience across the entire iR ADVANCE DX portfolio.

*To support Sustainability and save on raw materials required for plastics, 1st Copy Tray Kit-A1 is optional.

TECHNICAL SPECIFICATIONS

imageRUNNER ADVANCE DX C5800 Series

MAIN UNIT	A3 Color Laser Multifunctional Print, Copy, Scan, Send, Store and Optional Fax 1.8GHz Dual Core Processor	Fonts	PS fonts: 136 Roman PCL fonts: 93 Roman, 10 Bitmap fonts, 2 OCR fonts, Andale Mono WT J/K/S/T ^{†1} (Japanese, Korean, Simplified and Traditional Chinese), Barcode fonts ^{†2} ^{†1} Optional PCL International Font Set-A1 is required. ^{†2} Optional Barcode Printing Kit-D1 is required.
Machine type	Standard: 5.0GB RAM	Print Features	Secured Print, Secure Watermark, Header/Footer, Page Layout, Two-sided Printing, Mixed Paper Sizes/Orientations, Front/Back Covers, Toner Reduction, Poster Printing, Forced Hold printing, Print Date, Scheduled Printing, Printing Using a Virtual Printer
Core functions	Standard: (SSD) 256GB, Optional: (SSD) 256GB, 1TB	Operating System	UFRIL: Windows® 8.1/10/Server2012/Server2012 R2/Server2016/Server2019, Mac OS X(10.11 or later) PCL: Windows® 8.1/10/Server2012/Server2012 R2/Server2016/Server2019 PS: 8.1/10/Server2012/Server2012 R2/Server2016/Server2019, Mac OS X(10.11 or later) PPD: Windows® 8.1/10, Mac OS X(10.10 or later) As of Oct. 2020
Processor	10.1" TFT LCD WSVGA Color Touch panel (up to 90° tiltable)	COPY SPECIFICATIONS	
Control Panel	Standard: 1000Base-T/100Base-TX/10Base-T, Wireless LAN (IEEE 802.11 b/g/n); Optional: Bluetooth Low Energy	Copy Speed (BW & CL)	iR-ADV DX C5870i up to 70 ppm (A4, A5*, A5R, A6R), up to 36 ppm (A3), up to 42 ppm (A4R)
Memory	OTHERS Standard: USB 2.0 (Host) x1, USB 3.0 (Host) x1, USB 2.0 (Device) x1; Optional: Serial Interface, Copy Control Interface	*1 sided only	iR-ADV DX C5860i up to 60 ppm (A4, A5*, A5R, A6R), up to 32 ppm (A3), up to 36 ppm (A4R)
Storage	Standard: 1,200 sheets 100-sheet Multi-purpose tray x 1 550-sheet Paper cassette x 2 Maximum: 6,350 sheets (with High Capacity Cassette Feeding Unit-C1 + Paper Deck Unit-F1)	First-Copy-Out Time (A4, BW/CL)	iR-ADV DX C5850i up to 50 ppm (A4, A5*, A5R, A6R), up to 27 ppm (A3), up to 30 ppm (A4R)
Interface Connection	Maximum: 3,450 Sheets (with Staple Finisher-AB2 or Paper Folding/Booklet Finisher-A1 and 3rd Copy Tray Kit-A1)		iR-ADV DX C5840i up to 40 ppm (A4, A5*, A5R, A6R), up to 21 ppm (A3), up to 24 ppm (A4R)
Paper Supply Capacity (A4, 80gsm)	Collate, Group, Offset, Staple, Saddle Stitch, Hole Punch, Eco Staple, Staple On Demand, V-fold, C-fold, Z-fold [*] Finishing capabilities will vary depending on the options connected.	Copy resolution (dpi)	iR-ADV DX C5870i: Approx. 2.7 / 3.7 seconds or less
Paper output capacity (A4, 80gsm)	Multi-purpose tray: Thin, Plain, Recycled, Color, Heavy, Coated, Tracing, Bond, Transparency, Label, Pre-punched, Letterhead, Tab, Envelope	Multiple Copies	iR-ADV DX C5860i: Approx. 2.9 / 4.2 seconds or less
Finishing capabilities	Paper Cassette (Upper/Lower): Thin, Plain, Recycled, Color, Heavy, Bond, Transparency, Pre-punched, Letterhead, Envelope [*] [*] Envelope Feeder Attachment (standard) is required.	Copy Density	iR-ADV DX C5850i: Approx. 3.4 / 4.9 seconds or less
Supported Media Types	Supported Media Sizes	Magnification	iR-ADV DX C5840i: Approx. 4.1 / 6.1 seconds or less 600 x 600 Up to 999 copies Automatic or Manual (9 Levels) Variable zoom: 25% to 400% (1% Increments) Preset reduction/enlargement: 25%, 50%, 70%, 100%(1:1), 141%, 200%, 400%
Supported Media Sizes	Multi-purpose tray: Standard size: SRA3, A3, A4, A4R, A5, A5R, A6R, B4, B5, B5R Custom size: 98.0 x 139.7 mm to 320.0 x 457.2 mm Free Size: 98.0 x 139.7 mm to 320.0 x 457.2 mm Envelopes: COM10 No.10, Monarch, DL, ISO-C5 Envelope custom size: 98.0 x 90.0 mm to 320.0 x 457.2 mm	Copy Features	Preset R/E Ratios by Area, Two-Sided, Density Adjustment, Original Type Selection, Interrupt Mode, Book to Two Pages, Two-sided Original, Job Build, N on 1, Add Cover, Insert Sheets, Different Size Originals, Page Numbering, Copy Set Numbering, Sharpness, Erase Frame, Secure Watermark, Print Date, Gutter, Print & Check, Negative/Positive, Repeat Images, Merge Job Blocks, Mirror Image, Store in Mail Box, Superimpose Image, Copy ID Card, Skip Blank Pages, Free Size Original, Color Mode, Reserved Copy, Copy Sample
Supported Media Weights	Upper Cassette: Standard size: A4, A5, A5R, A6R, B5 Custom Size: 98.0 x 148.0 mm to 297.0 x 215.9 mm Envelopes: COM10 No.10, Monarch, DL, ISO-C5	SCAN SPECIFICATION	
Warm-up Time	Lower Cassette: Standard size: A3, A4, A4R, A5, A5R, A6R, B4, B5, B5R Custom size: 98.0 x 148.0 mm to 304.8 x 457.2 mm Envelopes: COM10 No.10, Monarch, DL, ISO-C5	Type	Single-pass Duplexing Automatic Document Feeder [*] [2-sided to 2-sided (Automatic)] [*] Detect Feeder Multi Sheet Feed is supported. up to 200 Sheets
Dimensions (W x D x H)	Multi-purpose tray: 52 to 300 gsm Paper Cassette (Upper/Lower): 52 to 256 gsm Duplex: 52 to 256 gsm Quick Startup Mode: 4 Seconds or Less [*] [*] Time from device power-on to when the copy icon appears and is enabled to operate on the touch panel display.	Document Feeder Paper Capacity (80 gsm)	Platen: Sheet, Book, and 3-Dimensional Objects
Installation Space (W x D)	From Sleep Mode: 7 Seconds or Less (iR-ADV DX C5870i) 6 Seconds or Less (iR-ADV DX C5860i/C5850i/C5840i) From Power On: 6 Seconds or less (with Quick Start Mode) [*] [*] Time from device power-on, until copy ready (not print reservation).	Acceptable Originals and weights	Document Feeder media weight: 1-sided scanning: 38 to 220 gsm (BW, CL) 2-sided scanning: 38 to 220 gsm (BW, CL) [*] An acceptable weights of A6R or smaller is 50 to 220gsm. Platen scanning size: up to 297.0 x 431.8 mm
Weight	iR-ADV DX C5870i/C5860i/C5850i/C5840i: Basic: 1,138 x 1,162 mm (Right Cover Open with Multi-purpose tray extended + Cassette Drawers Open) Fully Configured: 1,866 x 1,162 mm (Staple Finisher-AB2/Paper Folding/Booklet Finisher-A1 with the extension tray extended + Paper Deck Unit-F1 + Cassette Drawers open)	Supported media sizes	Document Feeder media size: A3, A4, A4R, A5, A5R, A6R, B4, B5, B5R, B6R Custom size: 70.0 x 139.7 mm to 304.8 x 431.8 mm
PRINT SPECIFICATIONS	iR-ADV DX C5870i: up to 70 ppm (A4, A5*, A5R, A6R*), up to 36 ppm (A3), up to 42 ppm (A4R)	Scan Speed (ipm: BW/CL; A4)	1-sided Scanning: 135/135 (300 x 300 dpi, send), 80/80 (600 x 600 dpi, copy), 2-sided Scanning: 270/270 (300 x 300 dpi, send), 160/90 (600 x 600 dpi, copy)
Print Speed (BW/CL)	iR-ADV DX C5860i: up to 60 ppm (A4, A5*, A5R, A6R*), up to 32 ppm (A3), up to 36 ppm (A4R)	Scan Resolution (dpi)	Scan for Copy: 600 x 600 Scan for Send: (Push) 600 x 600 (SMB/FTP/WebDAV/IFAX), (Pull) 600 x 600 Scan for Fax: 600 x 600
1 sided only	iR-ADV DX C5850i: up to 50 ppm (A4, A5, A5R, A6R*), up to 27 ppm (A3), up to 30 ppm (A4R)	Pull Scan Specifications	Color Network ScanGear2. For both TWAIN and WIA Supported OS: Windows® 8.1/10/Server2012/Server2012 R2/Server 2016 As of Mar. 2020
Print Resolution (dpi)	iR-ADV DX C5840i: up to 40 ppm (A4, A5*, A5R, A6R*), up to 21 ppm (A3), up to 24 ppm (A4R)	Scan Method	Push Scan, Pull Scan, Scan to Box, Scan to Advanced Space, Scan to Network, Scan to USB Memory Key, Scan to Mobile devices, Scan to cloud (uniFLOW Online - Optional)
Page description languages	1,200 x 1,200	SEND SPECIFICATIONS	
Direct Print	Standard: UFR II, PCL6, Adobe® PostScript®3™ Supported file types: PDF, EPS, TIFF/JPEG, and XPS	Destination	Standard: E-mail/Internet FAX (SMTP), SMB3.0, FTP, WebDAV, Mail Box Optional: Super G3 FAX, IP Fax
Printing from mobile and cloud	AirPrint, Mopria, Universal Print by Microsoft, Canon PRINT Business App, and uniFLOW Online (optional) A range of software and MEAP-based solutions are available to provide printing from mobile devices or internet-connected devices and cloud-based services depending on your requirements. Please contact your sales representative for further information.	Address Book	LDAP (2,000)/Local (1,600)/Speed dial (200)
		Send resolution (dpi)	Push: up to 600 x 600 Pull: up to 600 x 600
		Communication protocols	File: FTP(TCP/IP), SMB3.0 (TCP/IP), WebDAV E-mail/I-Fax: SMTP, POP3

TECHNICAL SPECIFICATIONS

imageRUNNER ADVANCE DX C5800 Series

File Format	TIFF, JPEG, PDF (Limited Color, Compact, Searchable, Apply policy, Optimize for Web, PDF/A-1b, Trace & Smooth, Encrypted, Device Signature, User Signature), XPS(Compact, Searchable, Device Signature, User Signature), Office Open XML (PowerPoint, Word)	ENVIRONMENTAL SPECIFICATIONS	
Universal Send Features	Original Type Selection, Two-sided Original, Book to Two Pages, Different-size Originals, Density Adjustment, Sharpness, Copy Ratio, Erase Frame, Job Build, Delayed Send, Preview, Job Done Notice, File Name, Subject/Message, Reply-to, E-mail Priority, TX Report, Original Content Orientation, Skip Blank Pages	Operating Environment	Temperature: 10 to 30 °C Humidity: 20 to 80 % RH (Relative Humidity) 220-240 V, 50/60 Hz, 6 A
FAX SPECIFICATIONS	(Optional)	Power source	Maximum: Approx. 2,000 W (iR-ADV DX C5870i) Approx. 1,800 W (iR-ADV DX C5860i/C5850i/C5840i) Copying (with DADF continuous scan): Approx. 943 W ^{*1} Standby: Approx. 53.4 W ^{*1} Sleep mode: Approx. 0.8 W ^{*2}
Maximum Number of Connection Lines	2 (2nd line optional)	Power consumption	^{*1} Reference value: measured one unit ^{*2} 0.8 W is not available in all circumstances due to certain settings.
Modem Speed	Super G3: 33.6 kbps G3: 14.4 kbps	Noise levels (BW/CL)	Typical Electricity Consumption (TEC)* : iR-ADV DX C5870i: 0.86 kWh iR-ADV DX C5860i: 0.71 kWh iR-ADV DX C5850i: 0.58 kWh iR-ADV DX C5840i: 0.46 kWh ^{* As per USA Energy Star 3.0}
Compression Method	MH, MR, MMR, JBIG		Sound Power Level (LWA,m) Active (BW) (1-sided) iR-ADV DX C5870i: 66 dB*, Kv 3 dB* iR-ADV DX C5860i: 64 dB*, Kv 3 dB* iR-ADV DX C5850i: 62 dB*, Kv 3 dB* iR-ADV DX C5840i: 61 dB*, Kv 3 dB*
Resolution (dpi)	400 x 400 (Ultra Fine), 200 x 400 (Super Fine), 200 x 200 (Fine), 200 x 100 (Normal)		^{* Reference value: measured only one unit with ISO7779, described with ISO9296 (2017)} Sound Pressure (LpAm) Bystander's position: Active (BW/CL) (1-sided) iR-ADV DX C5870i: 52 dB*/52 dB* iR-ADV DX C5860i: 50 dB*/51 dB* iR-ADV DX C5850i: 48 dB*/49 dB* iR-ADV DX C5840i: 47 dB*/47 dB*
Sending/Receiving Size	Sending: A3, A4, A4R, A5 ^{*1} , A5R ^{*1} , B4, B5 ^{*2} , B5R ^{*1} Receiving: A3, B4, A4, A4R, A5R, B5, B5R ^{*1} Sent as A4 ^{*2} Sent as B4 short		Stand-by iR-ADV DX C5870i/C5860i/C5850i: 23 dB* ^{* Reference value: measured only one unit with ISO7779, described with ISO9296 (2017)}
FAX memory	Up to 30,000 pages (2,000 jobs)	Standards	
Speed dials	Max. 200	CONSUMABLES	
Group dials/destinations	Max. 199 dials	Toner Cartridges	C-EXV 58 Toner BK/C/M/Y C-EXV 58L Toner C/M/Y
Sequential broadcast	Max. 256 addresses	Toner Yield (Estimated Yield @5% coverage)	C-EXV 58 Toner BK: 71,000 pages C-EXV 58 Toner C/M/Y: 60,000 pages C-EXV 58L Toner C/M/Y: 26,000 pages
Memory backup	Yes	SOFTWARE AND PRINTER MANAGEMENT	For detailed information please visit our website https://www.canon-europe.com/business/ Universal Login Manager (ULM) uniFLOW Online Express [*]
Fax Features	Sender's Name (TTI), Selecting the Telephone Line (when sending fax), Direct Send, Delayed Send, Preview, Job Done Notice, TX Report, Interrupt Transmission, Sequential Broadcasting, Password/Subaddress Sending, Confidential Mailbox, 2 on 1 Log	Tracking and reporting	^{* For more information, please refer to uniFLOW Online Express uniFLOW Online} iWEMC eMaintenance Content Delivery System Network ScanGear Canon Driver Configuration Tool MEAP (Multifunctional Embedded Application Platform) Kofax PowerPDF Advanced (Optional)
STORE SPECIFICATIONS		Remote management tools	
Mail Box (Number supported)	100 User Inboxes, 1 Memory RX Inbox, 50 Confidential Fax Inboxes Maximum 10,000 Pages (2,000 jobs) Stored	Scanning software	
Advanced Space	Communication Protocol: SMB or WebDAV Supported Client PC: Windows [*] 8.1/10 Concurrent Connections (Max.): SMB:64, WebDAV:3 Standard:16 GB (With option: max. 480GB)	Optimisation tools	
Advanced Space available disc space	Standard:16 GB (With option: max. 480GB)	Platform	
Advanced Space Features	Authentication for Advanced Space Log-in, Sort Function, Printing a PDF File with a Password, imageWARE Secure Audit Manager Support, Search, File Preview, Authentication Management, Open to public, URI TX, Backup/Restore	Document Publishing	
SECURITY SPECIFICATIONS		FIERY PRINT CONTROLLER SPECIFICATIONS (EMBEDDED)	
Authentication and Access Control (Activation is required)	User Authentication (Picture Login, Picture and PIN Login, Card Login [*] , Username and Password Login, Function Level Login, Mobile Login), Department ID Authentication (Department ID and PIN Login, Function Level Login), uniFLOW Online Express (PIN Login, Picture Login, Picture and PIN Login, Card Login [*] , Card and PIN Login, Username and Password Login, Department ID and PIN Login, Function Level Login), Access Management System (Access Control) [*] Card readers are optional, please refer to Hardware Accessories	Name	For full specifications & options, please visit the Canon website https://www.canon-europe.com/business/ Optional on all models imagePASS-R1 (Embedded)
Document Security	Print Security (Secure Print, Encrypted Secure Print, Forced Hold Printing, uniFLOW Secure Print [®]), Receive Data Security (Confidential Fax Inbox Forwarding Received Documents Automatically), Scan Security (Encrypted PDF, Device Signature PDF/XPS, User Signature PDF/XPS, Adobe LiveCycle [®] Rights Management ES2.5 Integration), BOX Security (Mail Box Password Protected, Advanced Space Access Control), Send Data Security (Setting for requesting password input per transmission, Restricted E-mail/File send functions, Confirming FAX number, Allow/Restrict Fax Driver Transmissions, Allow/Restrict Sending from History, S/MIME Support), Document Tracking (Secure Watermark) ^{*1} Requires uniFLOW Online / uniFLOW	Print Resolution (dpi)	1200 x 1200, 600 x 600
Network Security	TLS 1.3, IPsec, IEEE802.1X authentication, SNMP V3.0, Firewall Functionality (IP/MAC Address Filtering), Dual Network Support (Wired LAN/Wireless LAN, Wired LAN/Wired LAN), Disabling Unused Functions (Enabling/Disabling Protocols/Applications, Enabling/Disabling Remote UI, Enabling/Disabling USB Interface), G3 FAX separation from LAN, USB Port separation from LAN, Prohibit the execution of files stored in Advanced Box in the MFP, Scan and Send -Virus Concerns for E-mail Reception	Page Description Language(s)	Adobe PS3,PCL6
Device Security	Protecting SSD Data (SSD Data Encryption (FIPS140-2 Validated), SSD Lock, Standard SSD Initialize, Trusted Platform Module (TPM 2.0), Job Log Conceal Function, Protecting MFD Software Integrity, Checking MFD Software Integrity (Verify System at Startup, Runtime Intrusion Detection enabled with McAfee Embedded Control), HCD-PP [*] [*] Certification will follow post launch of this Series	Memory	4GB (1x4GB)
Device Management and Auditing	Administrator Password, Digital Certificate And Key Management, Audit Log, Cooperating with External Security Audit System (Security Information and Event Management), Image Data Logging, Security Policy Setting	Hard Disk Drive	500 GB SATA
		Processor Speed	Intel Pentium G4400 (3.3GHz)
		System	FS400
		PAPER SUPPLY OPTIONS	
		Cassette Feeding Unit-AQ1	Paper Capacity: 2 x 550 sheets (80 gsm) Paper Type: Thin, Plain, Recycled, Color, Heavy, Bond, Transparency, Pre-punched, Letterhead Paper Size: A3, A4, A4R, A5, A5R, A6R, B4, B5, B5R Custom size: 98.0 x 148.0 mm to 304.8 x 457.2 mm Paper Weight: 52 to 256 gsm Dimensions (W x D x H): 620 x 660 x 251 mm (attached to the main unit) Weight: Approx. 22 kg
		High Capacity Cassette Feeding Unit-C1	Paper Capacity: 2,450 sheets (80 gsm) Paper Type: Thin, Plain, Recycled, Color, Heavy, Bond, Pre-punched, Letterhead Paper Size: A4 Paper Weight: 52 to 256 gsm Dimensions (W x D x H): 620 x 660 x 251 mm (attached to the main unit) Weight: Approx. 29 kg
		Paper Deck Unit-F1	Paper Capacity: 2,700 sheets (80 gsm) Paper Type: Thin, Plain, Color, Recycled, Heavy, Pre-punched Paper Size: A4, B5 Paper Weight: 52 to 256 gsm Dimensions (W x D x H): 344 x 630 x 440 mm (attached to the main unit) Weight: Approx. 31 kg
		OUTPUT OPTIONS*	^{* Paper capacity may vary with different paper type/size.}
		1st Copy Tray Kit-A1	Capacity (with 80gsm paper): A4, A5, A5R, A6R, B5: 250 sheets SRA3, A3, A4R, B4, B5R: 100 sheets Paper Weight: 52 to 300 gsm

TECHNICAL SPECIFICATIONS

imageRUNNER ADVANCE DX C5800 Series

Inner 2way Tray-M1	<p>Tray Capacity (with 80 gsm paper) Upper tray: A4, A5, A5R, A6R, B5: 100 sheets SRA3, A3, A4R, B4, B5R: 50 sheets</p> <p>Lower tray: A4, A5, A5R, A6R, B5: 100 sheets SRA3, A3, A4R, B4, B5R: 100 sheets</p> <p>Paper Weight: 52 to 300 gsm Dimensions (W x D x H): 428 x 405 x 88 mm Weight: Approx. 0.7 kg</p>	Paper Folding Unit-L1	(Requires Buffer Pass Unit-P2 & external finisher) Paper size: A3, A4, B4 Z-fold Capacity: 1 sheet (52 to 105 gsm) Dimensions (W x D x H): 201 x 579 x 896 mm Weight: Approx. 12 kg
3rd Copy Tray Kit-A1	<p>Capacity (with 80gsm paper): A4, A5R, B5: 100 sheets A3, A4R, B4, B5R: 75 sheets</p> <p>Paper Weight: 52 to 300 gsm Dimensions (W x D x H): 442 x 373 x 176 mm (attached to the main unit, when the extension tray is extended) Weight: 0.5 kg</p>	Inner 2/4 Hole Puncher-D1 (Not supported for iR-ADV DX C5870)	(Requires the Inner Finisher-L1) Two or Four Holes Acceptable Punch Paper Weight: 52 to 300 gsm Acceptable Punch Paper Size: Two holes: A3, A4, A4R, A5, B4, B5, B5R Four holes: A3, A4
Inner Finisher-L1 (Not supported for iR-ADV DX C5870)	<p>Tray Capacity (with 80gsm paper): Upper Tray: SRA3, A3, A4, A4R, A5, A5R, A6R, B4, B5, B5R: approx 45 sheets</p> <p>Lower Tray: A4, A5, A5R, B5: approx. 500 sheets, SRA3, A3, A4R, B4, B5R: 250 sheets, A6R: 30 sheets Envelope: 10 sheets</p> <p>Paper Weight: 52 to 300 gsm Staple Position: Corner, Double Staple Capacity: (52 to 90 gsm paper) A4, B5: 50 sheets A4R: 40 sheets A3, B4: 30 sheets Eco Staple: A3, A4, B4, B5: 10 sheets (52 to 64 gsm) 8 sheets (65 to 81.4 gsm) 6 sheets (82 to 105 gsm)</p> <p>Staple On Demand: 40 sheets (80 gsm) Dimensions (W x D x H): 743 x 525 x 225 mm (attached to the main unit, when the extension tray is extended) Weight: Approx. 9.1 kg</p>	Inner 4 Hole Puncher-D1 (Not supported for iR-ADV DX C5870)	(Requires the Inner Finisher-L1) Four Holes Acceptable Punch Paper Weight: 52 to 300 gsm Acceptable Punch Paper Size: Four holes: A3, A4, A4R, A5, B4, B5, B5R
Staple Finisher-AB2	<p>(Requires Buffer Pass Unit-P2) Tray Capacity (with 80gsm paper): Upper Tray: A4, A5, A5R, A6R, B5: approx. 250 sheets, SRA3, A3, A4R, B4, B5R: approx. 125 sheets</p> <p>Lower Tray: A4, A5, A5R, B5: 3,000 sheets, SRA3, A3, A4R, B4, B5R: 1,500 sheets, A6R: 250 sheets Envelopes: Monarch: 30 sheets, COM10 No.10, DL, ISO-C5: 100 sheets</p> <p>Paper Weight: Upper Tray 52 to 256 gsm, Lower Tray 52 to 300 gsm Staple Position: Corner, Double Staple Capacity: (52 to 90 gsm) A4, B5: 50 sheets A4R: 40 sheets A3, B4: 30 sheets Eco Staple: A3, A4: 10 sheets (52 to 64 gsm) 8 sheets (65 to 81.4 gsm) 6 sheets (82 to 105 gsm)</p> <p>Staple On Demand: 50 sheets (52 to 90 gsm) Dimensions (W x D x H): 637 x 623 x 1,142 mm (when the extension tray is extended) Weight: Approx. 31 kg</p>	2/4 Hole Puncher Unit-A1	(Requires either the Staple Finisher-AB2 or Paper Folding/Booklet Finisher-A1) Two or Four Holes Acceptable Punch Paper Weight: 52 to 300 gsm Acceptable Punch Paper Size: Two holes: A3, A4, A4R, A5, B4, B5, B5R Four holes: A3, A4
Paper Folding/Booklet Finisher-A1	<p>(Requires Buffer Pass Unit-P2) (Includes the above Staple Finisher-AB2 basic staple specifications.) Saddle Stitch paper size: A3, A4R, B4 Saddle Stitch Staple Capacity: 20 sheets x 10 sets (52 to 81.4 gsm) (including 1 cover sheet 52 to 256 gsm) V-fold Capacity: up to 3 sheets (52 to 105 gsm) C-fold Capacity: up to 5 sheets (52 to 128 gsm) Dimensions (W x D x H): 637 x 623 x 1,142 mm (when the extension tray is extended) Weight: Approx. 57 kg</p>	4 Hole Puncher Unit-A1	(Requires either the Staple Finisher-AB2 or Paper Folding/Booklet Finisher-A1) Four Holes Acceptable Punch Paper Weight: 52 to 300 gsm Acceptable Punch Paper Size: Four holes: A3, A4, A4R, A5, B4, B5, B5R
		HARDWARE ACCESSORIES	Card Readers
			Various card readers available e.g. MiCard Plus. Please contact local Canon Office for more details.
			Copy Card Reader Attachment-B7 IC Card Reader Box for Numeric Keypad-A1 Copy Card Reader-F1 Printer Cover-M2 Tab Feeding Attachment-F1 Buffer Pass Unit-P2 Utility Tray-B1 Numeric Keypad-A2
		Others	
		SECURITY OPTIONS	256GB SSD-A1 1TB SSD-A1 Memory Mirroring Kit-A1
		SYSTEM AND CONTROLLER OPTIONS	PCL International Font Set-A1 Barcode Printing Kit-D1 imagePASS-R1
		Print Accessories	Hot Folders License Fiery Compose Fiery Impose Fiery Impose and Compose
		Barcode Printing	Serial Interface Kit-K3 Copy Control Interface Kit-A1 Connection Kit-A3 for Bluetooth LE
		EFI-Fiery Based Controller	Super G3 FAX Board-AX1 Super G3 2nd Line Fax Board-AX1
		EFI-Fiery Based Controller Options	Remote Fax Kit-A1 IP FAX Expansion Kit-B1
		System Accessories	
		Fax Accessories	
		OTHER OPTIONS	ADF Access Handle-A1 Voice Guidance Kit-G1 Voice Operation Kit-D1
		Accessibility Accessories	Staple Cartridge-Y1 (2 x 2,000pcs)* Staple-P1 (2 x 5,000pcs) *For Booklet Finisher only
		Consumables	Antimicrobial Film* - Various Sheets designed to fit the devices most common touch points. *Application by a Service Engineer is recommended
		Device Protection	

Software & Solutions



Certifications and compatibility



Canon Ireland
3006 Lake Drive
Citywest, Saggart
Co. Dublin, Ireland
Telephone No: 01 2052400
Facsimile No: 01 2052525
canon.ie

Canon (UK) Ltd
The Bower
4 Roundwood Avenue
Stockley Park
Uxbridge
UB11 1AF

Canon Inc.
canon.com
Canon Europe
canon-europe.com
English edition
© Canon Europa N.V., 2022