

imageRUNNER ADVANCE DX C5800 Series

POWERFUL PRODUCTIVITY FROM SECURE COLOUR A3 MULTIFUNCTION DEVICES



Canon uniFLOW Online
Outstanding Cloud Output Management Solution



Canon uniFLOW Online
Outstanding Cloud Output Management Solution



New to the Line

MAIN CONFIGURATION OPTIONS

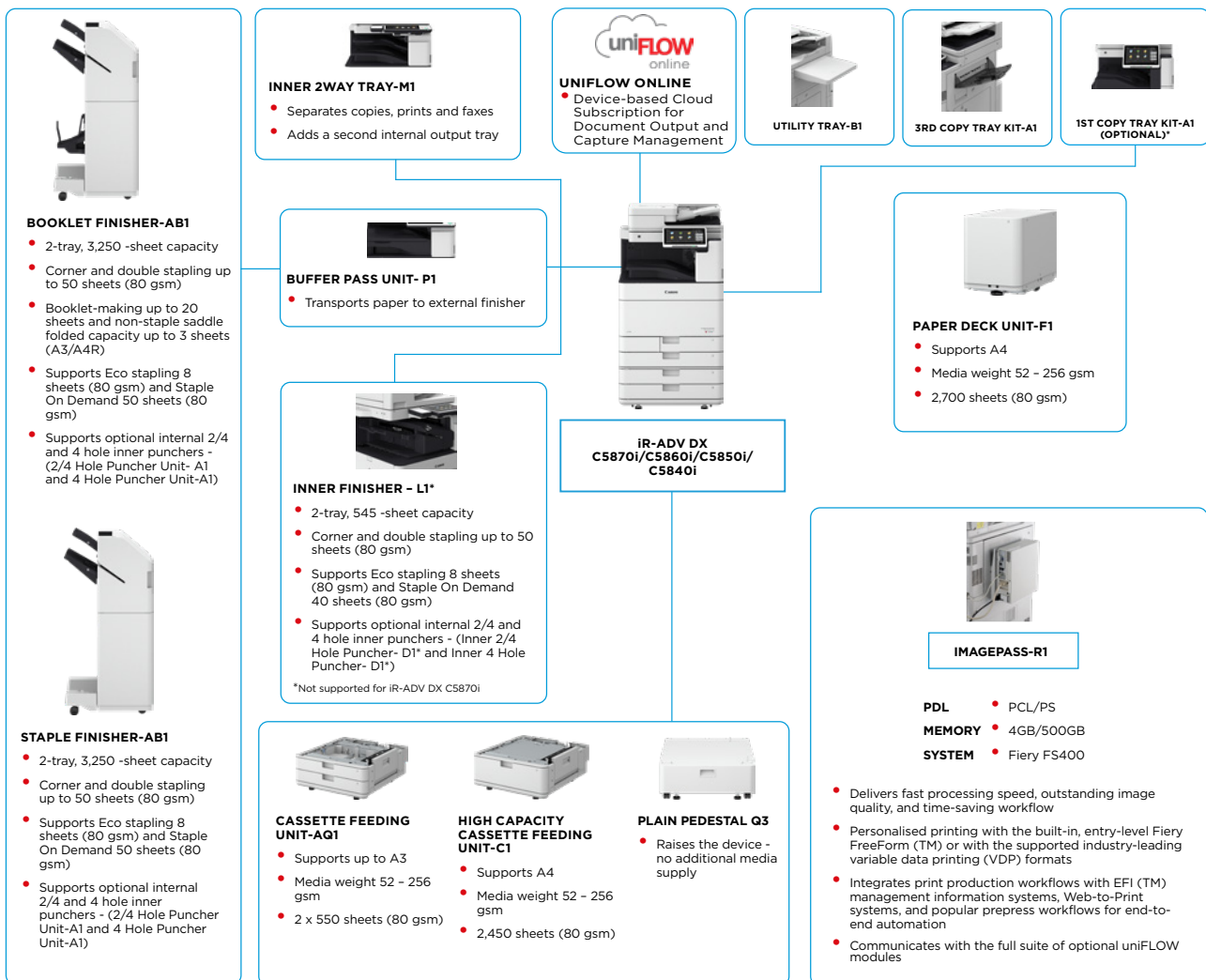

This flat configuration is for illustration purpose only. For a complete list of options and the exact compatibility relationships, please refer to the [online product configurator](#).

The Unified Firmware Platform (UFP) ensures that the latest feature upgrades and protection are available, for an enhanced user experience across the entire iR ADVANCE DX portfolio.

*To support Sustainability and save on raw materials required for plastics, 1st Copy Tray Kit-A1 is optional.

TECHNICAL SPECIFICATIONS

imageRUNNER ADVANCE DX C5800 Series

MAIN UNIT	A3 Color Laser Multifunctional	Fonts	PS fonts: 136 Roman PCL fonts: 93 Roman, 10 Bitmap fonts, 2 OCR fonts, Andalé Mono WT J/K/S/T ¹¹ (Japanese, Korean, Simplified and Traditional Chinese), Barcode fonts ¹² ^{**} Optional PCL International Font Set-A1 is required. ^{**} Optional Barcode Printing Kit-D1 is required.
Machine type	Print, Copy, Scan, Send, Store and Optional Fax	Print Features	Secured Print, Secure Watermark, Header/Footer, Page Layout, Two-sided Printing, Mixed Paper Sizes/Orientations, Front/Back Covers, Toner Reduction, Poster Printing, Forced Hold printing, Print Date, Scheduled Printing, Printing Using a Virtual Printer
Core functions	1.8GHz Dual Core Processor	Operating System	UFRIL: Windows® 8.1/10/Server2012/Server2012 R2/Server2016/Server2019, Mac OS X(10.11 or later) PCL: Windows® 8.1/10/Server2012/Server2012 R2/Server2016/Server2019 PS: 8.1/10/Server2012/Server2012 R2/Server2016/Server2019, Mac OS X(10.11 or later) PPD: Windows® 8.1/10, Mac OS X(10.10 or later) McAfee Embedded Control Software As of Oct. 2020
Processor	10.1" TFT LCD WSVGA Color Touch panel (up to 90° tiltable)	COPY SPECIFICATIONS	
Control Panel	Standard: 5.0GB RAM Standard: (SSD) 256GB, Optional: (SSD) 256GB, 1TB	Copy Speed (BW & CL)	iR-ADV DX C5870i up to 70 ppm (A4, A5*, A5R, A6R), up to 36 ppm (A3), up to 42 ppm (A4R)
Memory	NETWORK Standard: 1000Base-T/100Base-TX/10Base-T, Wireless LAN (IEEE 802.11 b/g/n); Optional: NFC, Bluetooth Low Energy	*1 sided only	iR-ADV DX C5860i up to 60 ppm (A4, A5*, A5R, A6R), up to 32 ppm (A3), up to 36 ppm (A4R)
Storage	OTHERS Standard: USB 2.0 (Host) x1, USB 3.0 (Host) x1, USB 2.0 (Device) x1; Optional: Serial Interface, Copy Control Interface		iR-ADV DX C5850i up to 50 ppm (A4, A5*, A5R, A6R), up to 27 ppm (A3), up to 30 ppm (A4R)
Interface Connection	Standard: 1,200 sheets 100-sheet Multi-purpose tray x 1 550-sheet Paper cassette x 2 Maximum: 6,350 sheets (with High Capacity Cassette Feeding Unit-C1 + Paper Deck Unit-F1)		iR-ADV DX C5840i up to 40 ppm (A4, A5*, A5R, A6R), up to 21 ppm (A3), up to 24 ppm (A4R)
Paper Supply Capacity (A4, 80gsm)	Maximum: 3,450 Sheets (with Staple Finisher-AB1 or Booklet Finisher-AB1 and 3rd Copy Tray Kit-A1)	First-Copy-Out Time (A4, BW/CL)	iR-ADV DX C5870i: Approx. 2.7 / 3.7 seconds or less iR-ADV DX C5860i: Approx. 2.9 / 4.2 seconds or less iR-ADV DX C5850i: Approx. 3.4 / 4.9 seconds or less iR-ADV DX C5840i: Approx. 4.1 / 6.1 seconds or less
Paper output capacity (A4, 80gsm)	Collate, Group, Offset, Staple, Saddle Stitch, Hole Punch, Eco Staple, Staple On Demand [*] Finishing capabilities will vary depending on the options connected.	Copy resolution (dpi)	600 x 600
Finishing capabilities	Multi-purpose tray: Thin, Plain, Recycled, Color, Heavy, Coated, Tracing, Bond, Transparency, Label, Pre-punched, Letterhead, Tab, Envelope	Multiple Copies	Up to 999 copies
Supported Media Types	Paper Cassette (Upper/Lower): Thin, Plain, Recycled, Color, Heavy, Bond, Transparency, Pre-punched, Letterhead, Envelope [*] [*] Envelope Feeder Attachment (standard) is required.	Copy Density	Automatic or Manual (9 Levels)
Supported Media Sizes	Multi-purpose tray: Standard size: SRA3, A3, A4, A4R, A5, A5R, A6R, B4, B5, B5R Custom size: 98.0 x 139.7 mm to 320.0 x 457.2 mm Free Size: 98.0 x 139.7 mm to 320.0 x 457.2 mm Envelopes: COM10 No.10, Monarch, DL, ISO-C5 Envelope custom size: 98.0 x 90.0 mm to 320.0 x 457.2 mm	Magnification	Variable zoom: 25% to 400% (1% Increments) Preset reduction/enlargement: 25%, 50%, 70%, 100%(1:1), 141%, 200%, 400%
Supported media weights	Upper Cassette: Standard size: A4, A5, A5R, A6R, B5 Custom Size: 98.0 x 148.0 mm to 304.8 x 457.2 mm Envelopes: COM10 No.10, Monarch, DL, ISO-C5	Copy Features	Preset R/E Ratios by Area, Two-Sided, Density Adjustment, Original Type Selection, Interrupt Mode, Book to Two Pages, Two-sided Original, Job Build, N on 1, Add Cover, Insert Sheets, Different Size Originals, Page Numbering, Copy Set Numbering, Sharpness, Erase Frame, Secure Watermark, Print Date, Gutter, Print & Check, Negative/Positive, Repeat Images, Merge Job Blocks, Mirror Image, Store in Mail Box, Superimpose Image, Copy ID Card, Skip Blank Pages, Free Size Original, Color Mode, Reserved Copy, Copy Sample
Warm-up Time	Lower Cassette: Standard size: A3, A4, A4R, A5, A5R, A6R, B4, B5, B5R Custom size: 98.0 x 148.0 mm to 304.8 x 457.2 mm Envelopes: COM10 No.10, Monarch, DL, ISO-C5	SCAN SPECIFICATION	
	Multi-purpose tray: 52 to 300 gsm Paper Cassette (Upper/Lower): 52 to 256 gsm Duplex: 52 to 256 gsm	Type	Single-pass Duplexing Automatic Document Feeder [*] [2-sided to 2-sided (Automatic)] [*] Detect Feeder Multi Sheet Feed is supported. up to 200 Sheets
Dimensions (W x D x H)	Quick Startup Mode: 4 Seconds or less [*] [*] Time from device power-on to when the copy icon appears and is enabled to operate on the touch panel display.	Document Feeder Paper Capacity (80 gsm)	Platen: Sheet, Book, and 3-Dimensional Objects
Installation Space (W x D)	From Sleep Mode: 7 Seconds or Less (iR-ADV DX C5870i) 6 Seconds or Less (iR-ADV DX C5860i/C5850i/C5840i) From Power On: 6 Seconds or less (with Quick Start Mode) [*] [*] Time from device power-on, until copy ready (not print reservation).	Acceptable Originals and weights	Document Feeder media weight: 1-sided scanning: 38 to 220 gsm (BW, CL) 2-sided scanning: 38 to 220 gsm (BW, CL) [*] An acceptable weights of A6R or smaller is 50 to 220gsm.
Weight	iR-ADV DX C5870i/C5860i/C5850i/C5840i: 620 x 722 x 937 mm	Supported media sizes	Platen scanning size: up to 297.0 x 431.8 mm
	iR-ADV DX C5870i/C5860i/C5850i/C5840i: Basic: 1,138 x 1,162 mm (Right Cover Open with Multi-purpose tray extended + Cassette Drawers Open) Fully Configured: 1,866 x 1,162 mm (Staple Finisher-AB1/Booklet Finisher-AB1 with the extension tray extended + Paper Deck Unit-F1 + Cassette Drawers open)	Scan Speed (ipm: BW/CL; A4)	Document Feeder media size: A3, A4, A4R, A5, A5R, A6R, B4, B5, B5R, B6R Custom size: 70.0 x 139.7 mm to 304.8 x 431.8 mm
	iR-ADV DX C5870i: Approx. 108 kg including regular toner iR-ADV DX C5860i/C5850i: Approx. 105 kg including regular toner iR-ADV DX C5840i: Approx. 104 kg including regular toner	Scan Resolution (dpi)	1-sided Scanning: 135/135 (300 x 300 dpi, send), 80/80 (600 x 600 dpi, copy), 2-sided Scanning: 270/270 (300 x 300 dpi, send), 160/90 (600 x 600 dpi, copy)
PRINT SPECIFICATIONS		Pull Scan Specifications	Scan for Copy: 600 x 600 Scan for Send: (Push) 600 x 600 (SMB/FTP/WebDAV/IFAX), (Pull) 600 x 600 Scan for Fax: 600 x 600
Print Speed (BW/CL)		Scan Method	Color Network ScanGear2. For both TWAIN and WIA Supported OS: Windows® 8.1/10/Server2012/Server2012 R2/Server 2016 As of Mar. 2020
*1 sided only		SEND SPECIFICATIONS	Push Scan, Pull Scan, Scan to Box, Scan to Advanced Space, Scan to Network, Scan to USB Memory Key, Scan to Mobile devices, Scan to cloud (uniFLOW Online - Optional)
	iR-ADV DX C5870i up to 70 ppm (A4, A5*, A5R, A6R), up to 36 ppm (A3), up to 42 ppm (A4R)	Destination	Standard: E-mail/Internet FAX (SMTP), SMB3.0, FTP, WebDAV, Mail Box Optional: Super G3 FAX, IP Fax LDAP (2,000)/Local (1,600)/Speed dial (200)
	iR-ADV DX C5860i up to 60 ppm (A4, A5*, A5R, A6R), up to 32 ppm (A3), up to 36 ppm (A4R)	Address Book	Push: up to 600 x 600 Pull: up to 600 x 600
	iR-ADV DX C5850i up to 50 ppm (A4, A5*, A5R, A6R), up to 27 ppm (A3), up to 30 ppm (A4R)	Send resolution (dpi)	File: FTP(TCP/IP), FTPS (encrypted FTP), SMB3.0 (TCP/IP), WebDAV E-mail/I-Fax: SMTP, POP3
	iR-ADV DX C5840i up to 40 ppm (A4, A5*, A5R, A6R), up to 21 ppm (A3), up to 24 ppm (A4R)	Communication protocols	
Print Resolution (dpi)	1,200 x 1,200		
Page description languages	Standard: UFR II, PCL6, Adobe® PostScript®3™		
Direct Print	Supported file types: PDF, EPS, TIFF/JPEG, and XPS AirPrint, Mopria, Universal Print by Microsoft		
Printing from mobile and cloud	Canon PRINT Business and uniFLOW Online (optional) A range of software and MEAP-based solutions are available to provide printing from mobile devices or internet-connected devices and cloud-based services depending on your requirements. Please contact your sales representative for further information.		

TECHNICAL SPECIFICATIONS

imageRUNNER ADVANCE DX C5800 Series

File Format	TIFF, JPEG, PDF (Limited Color, Compact, Searchable, Apply policy, Optimize for Web, PDF/A-1b, Trace & Smooth, Encrypted, Device Signature, User Signature), XPS (Compact, Searchable, Device Signature, User Signature), Office Open XML (PowerPoint, Word)	Power consumption	Maximum: Approx. 2,000 W (iR-ADV DX C5870i) Approx. 1,800 W (iR-ADV DX C5860i/C5850i/C5840i) Copying (with DADF continuous scan): Approx. 943 W* Standby: Approx. 53.4 W* Sleep mode: Approx. 0.8 W* * Reference value: measured one unit ** 0.8 W is not available in all circumstances due to certain settings.
Universal Send Features	Original Type Selection, Two-sided Original, Book to Two Pages, Different-size Originals, Density Adjustment, Sharpness, Copy Ratio, Erase Frame, Job Build, Delayed Send, Preview, Job Done Notice, File Name, Subject/Message, Reply-to, E-mail Priority, TX Report, Original Content Orientation, Skip Blank Pages	Noise levels (BW/CL)	Typical Electricity Consumption (TEC)* : iR-ADV DX C5870i: 0.86 kWh iR-ADV DX C5860i: 0.71 kWh iR-ADV DX C5850i: 0.58 kWh iR-ADV DX C5840i: 0.46 kWh * As per USA Energy Star 3.0
FAX SPECIFICATIONS	(Optional)		Sound Power Level (LWA,m) Active (BW) (1-sided) iR-ADV DX C5870i: 66 dB*, Kv 3 dB* iR-ADV DX C5860i: 64 dB*, Kv 3 dB* iR-ADV DX C5850i: 62 dB*, Kv 3 dB* iR-ADV DX C5840i: 61 dB*, Kv 3 dB* *Reference value: measured only one unit with ISO7779, described with ISO9296 (2017)
Maximum Number of Connection Lines	2 (2nd line optional)		Sound Pressure (LpAm) Bystander's position: Active (BW/CL) (1-sided) iR-ADV DX C5870i: 52 dB*/52 dB* iR-ADV DX C5860i: 50 dB*/51 dB* iR-ADV DX C5850i: 48 dB*/49 dB* iR-ADV DX C5840i: 47 dB*/47 dB*
Modem Speed	Super G3: 33.6 kbps G3: 14.4 kbps	Standards	Stand-by iR-ADV DX C5870i/C5860i/C5850i: 23 dB* * Reference value: measured only one unit with ISO7779, described with ISO9296 (2017)
Compression Method	MH, MR, MMR, JBIG	CONSUMABLES	Blue Angel
Resolution (dpi)	400 x 400 (Ultra Fine), 200 x 400 (Super Fine), 200 x 200 (Fine), 200 x 100 (Normal)	Toner Cartridges	C-EXV 58 Toner BK/C/M/Y C-EXV 58L Toner C/M/Y
Sending/Receiving Size	Sending: A3, A4, A4R, A5*, A5R*, B4, B5*, B5R* Receiving: A3, B4, A4, A4R, A5R, B5, B5R * Sent as A4 ** Sent as B4 short	Toner Yield (Estimated Yield @5% coverage)	C-EXV 58 Toner BK: 71,000 pages C-EXV 58 Toner C/M/Y: 60,000 pages C-EXV 58L Toner C/M/Y: 26,000 pages
FAX memory	Up to 30,000 pages (2,000 jobs)	SOFTWARE AND PRINTER MANAGEMENT	For detailed information please visit our website https://www.canon-europe.com/business/
Speed dials	Max. 200	Tracking and reporting	Universal Login Manager (ULM) uniFLOW Online Express*
Group dials/destinations	Max. 199 dials		* For more information, please refer to uniFLOW Online Express uniFLOW Online
Sequential broadcast	Max. 256 addresses	Remote management tools	iWEMC eMaintenance Content Delivery System Network ScanGear
Memory backup	Yes	Scanning software	Canon Driver Configuration Tool MEAP (Multifunction Embedded Application Platform) Kofax PowerPDF Advanced (Optional)
Fax Features	Sender's Name (TTI), Selecting the Telephone Line (when sending fax), Direct Send, Delayed Send, Preview, Job Done Notice, TX Report, Interrupt Transmission, Sequential Broadcasting, Password/Subaddress Sending, Confidential Mailbox, 2 on 1 Log	Optimisation tools	
STORE SPECIFICATIONS		Platform	
Mail Box (Number supported)	100 User Inboxes, 1 Memory RX Inbox, 50 Confidential Fax Inboxes Maximum 10,000 Pages (2,000 jobs) Stored	Document Publishing	
Advanced Space	Communication Protocol: SMB or WebDAV Supported Client PC: Windows* 8.1/10 Concurrent Connections (Max.): SMB:64, WebDAV:3 Standard:16 GB (With option: max. 480GB)	FIERY PRINT CONTROLLER SPECIFICATIONS (EMBEDDED)	
Advanced Space available disc space	Authentication for Advanced Space Log-in, Sort Function, Printing a PDF File with a Password, imageWARE Secure Audit Manager Support, Search, File Preview, Authentication Management, Open to public, URI TX, Backup/Restore	Name	imagePASS-R1 (Embedded)
Advanced Space Features:		Print Resolution (dpi)	1200 x 1200, 600 x 600
		Page Description Language(s)	Adobe PS3,PCL6
SECURITY SPECIFICATIONS		Memory	4GB (1x4GB)
Authentication and Access Control (Activation is required)	User Authentication (Picture Login, Picture and PIN Login, Card Login*, Username and Password Login, Function Level Login, Mobile Login), Department ID Authentication (Department ID and PIN Login, Function Level Login), uniFLOW Online Express (PIN Login, Picture Login, Picture and PIN Login, Card Login*, Card and PIN Login, Username and Password Login, Department ID and PIN Login, Function Level Login), Access Management System (Access Control)	Hard Disk Drive	500 GB SATA
	* Card readers are optional, please refer to Hardware Accessories	Processor Speed	Intel Pentium G4400 (3.3GHz)
Document Security	Print Security (Secure Print, Encrypted Secure Print, Forced Hold Printing, uniFLOW Secure Print**), Receive Data Security (Confidential Fax Inbox Forwarding Received Documents Automatically), Scan Security (Encrypted PDF, Device Signature PDF/XPS, User Signature PDF/XPS, Adobe LiveCycle* Rights Management ES2.5 Integration), BOX Security (Mail Box Password Protected, Advanced Space Access Control), Send Data Security (Setting for requesting password input per transmission, Restricted E-mail/File send functions, Confirming FAX number, Allow/Restrict Fax Driver Transmissions, Allow/Restrict Sending from History, S/MIME Support), Document Tracking (Secure Watermark)	System	FS400
	** Requires uniFLOW Online / uniFLOW	PAPER SUPPLY OPTIONS	
Network Security	TLS 1.3, IPsec, IEEE802.1X authentication, SNMP V3.0, Firewall Functionality (IP/MAC Address Filtering), Dual Network Support (Wired LAN/Wireless LAN, Wired LAN/Wired LAN), Disabling Unused Functions (Enabling/Disabling Protocols/Applications, Enabling/Disabling Remote UI, Enabling/Disabling USB Interface), G3 FAX separation from LAN, USB Port separation from LAN, Prohibit the execution of files stored in Advanced Box in the MFP, Scan and Send -Virus Concerns for E-mail Reception	Cassette Feeding Unit-AQ1	Paper Capacity: 2 x 550 sheets (80 gsm) Paper Type: Thin, Plain, Recycled, Color, Heavy, Bond, Transparency, Pre-punched, Letterhead Paper Size: A3, A4, A4R, A5, A5R, A6R, B4, B5, B5R Custom size: 98.0 x 148.0 mm to 304.8 x 457.2 mm
Device Security	Protecting SSD Data (SSD Data Encryption (FIPS140-2 Validated), SSD Lock, Standard SSD Initialize, Trusted Platform Module (TPM 2.0), Job Log Conceal Function, Protecting MFD Software Integrity, Checking MFD Software Integrity (Verify System at Startup, Runtime Intrusion Detection), HCD-PP* * Certification will follow post launch of this Series	High Capacity Cassette Feeding Unit-C1	Paper Capacity: 2,450 sheets (80 gsm) Paper Type: Thin, Plain, Recycled, Color, Heavy, Bond, Pre-punched, Letterhead Paper Size: A4 Paper Weight: 52 to 256 gsm Dimensions (W x D x H): 620 x 660 x 251 mm (attached to the main unit) Weight: Approx. 22 kg
Device Management and Auditing	Administrator Password, Digital Certificate And Key Management, Audit Log, Cooperating with External Security Audit System (Security Information and Event Management), Image Data Logging, Security Policy Setting	Paper Deck Unit-F1	Paper Capacity: 2,700 sheets (80 gsm) Paper Type: Thin, Plain, Color, Recycled, Heavy, Pre-punched Paper Size: A4, B5 Paper Weight: 52 to 256 gsm Dimensions (W x D x H): 344 x 630 x 440 mm (attached to the main unit) Weight: Approx. 31 kg
ENVIRONMENTAL SPECIFICATIONS		OUTPUT OPTIONS*	
Operating Environment	Temperature: 10 to 30 °C Humidity: 20 to 80 % RH (Relative Humidity)	1st Copy Tray Kit-A1	*Paper capacity may vary with different paper type/size. Capacity (with 80gsm paper): A4, A5, A5R, A6R, B5: 250 sheets SRA3, A3, A4R, B4, B5R: 100 sheets Paper Weight: 52 to 300 gsm
Power source	220-240 V, 50/60 Hz, 6 A		



TECHNICAL SPECIFICATIONS

imageRUNNER ADVANCE DX C5800 Series

Inner 2way Tray-M1	Tray Capacity (with 80 gsm paper) Upper tray: A4, A5, A5R, A6R, B5: 100 sheets SRA3, A3, A4R, B4, B5R: 50 sheets Lower tray: A4, A5, A5R, A6R, B5: 100 sheets SRA3, A3, A4R, B4, B5R: 100 sheets Paper Weight: 52 to 300 gsm Dimensions (W x D x H): 428 x 405 x 88 mm Weight: Approx. 0.7 kg	Booklet Finisher-AB1	(Requires Buffer Pass Unit-P1) (Includes the above Staple Finisher-AB1 basic staple specifications.) Saddle Stitch paper size: A3, A4R, B4 Saddle Stitch Staple Capacity: 20 sheets x 10 sets (52 to 81.4 gsm) (including 1 cover sheet 52 to 256 gsm) Non Staple Folded Bunch Capacity: up to 3 sheets (52 to 105 gsm) Dimensions (W x D x H): 637 x 623 x 1,142 mm (when the extension tray is extended) Weight: Approx. 57 kg
3rd Copy Tray Kit-A1	Capacity (with 80gsm paper): A4, A5R, B5: 100 sheets A3, A4R, B4, B5R: 75 sheets Paper Weight: 52 to 300 gsm Dimensions (W x D x H): 442 x 373 x 176 mm (attached to the main unit, when the extension tray is extended) Weight: 0.5 kg	Inner 2/4 Hole Puncher-D1 (Not supported for iR-ADV DX C5870i)	(Requires the Inner Finisher-L1) Two or Four Holes Acceptable Punch Paper Weight: 52 to 300 gsm Acceptable Punch Paper Size: Two holes: A3, A4, A4R, A5, B4, B5, B5R Four holes: A3, A4
Inner Finisher-L1 (Not supported for iR-ADV DX C5870i)	Tray Capacity (with 80gsm paper): Upper Tray: SRA3, A3, A4, A4R, A5, A5R, A6R, B4, B5, B5R: approx 45 sheets Lower Tray: A4, A5, A5R, B5: approx. 500 sheets, SRA3, A3, A4R, B4, B5R: 250 sheets, A6R: 30 sheets Envelope: 10 sheets Paper Weight: 52 to 300 gsm Staple Position: Corner, Double Staple Capacity: (52 to 90 gsm paper) A4, B5: 50 sheets A4R: 40 sheets A3, B4: 30 sheets Eco Staple*: A4, B5: 10 sheets (52 to 64 gsm) 8 sheets (65 to 81.4 gsm) 6 sheets (82 to 105 gsm) A3, B4: 5 sheets (52 to 64 gsm) 4 sheets (65 to 81.4 gsm) 3 sheets (82 to 105 gsm) Staple On Demand: 40 sheets (80 gsm) Dimensions (W x D x H): 743 x 525 x 225 mm (attached to the main unit, when the extension tray is extended) Weight: Approx. 9.1 kg * Large size media A3/B4 support will be available from March 2021 when an update to the firmware is applied: A3*, B4*: 10 sheets (52 to 64 gsm) 8 sheets (65 to 81.4 gsm) 6 sheets (82 to 105 gsm)	Inner 4 Hole Puncher-D1 (Not supported for iR-ADV DX C5870i)	(Requires the Inner Finisher-L1) Four Holes Acceptable Punch Paper Weight: 52 to 300 gsm Acceptable Punch Paper Size: Four holes: A3, A4, A4R, A5, B4, B5, B5R
Staple Finisher-AB1	(Requires Buffer Pass Unit-P1) Tray Capacity (with 80gsm paper): Upper Tray: A4, A5, A5R, A6R, B5: approx. 250 sheets, SRA3, A3, A4R, B4, B5R: approx. 125 sheets Lower Tray: A4, A5, A5R, B5: 3,000 sheets, SRA3, A3, A4R, B4, B5R: 1,500 sheets, A6R: 250 sheets Envelopes: Monarch: 30 sheets, COM10 No.10, DL, ISO-C5: 100 sheets Paper Weight: Upper Tray 52 to 256 gsm, Lower Tray 52 to 300 gsm Staple Position: Corner, Double Staple Capacity: (52 to 90 gsm) A4, B5: 50 sheets A4R: 40 sheets A3, B4: 30 sheets Eco Staple*: A4: 10 sheets (52 to 64 gsm) 8 sheets (65 to 81.4 gsm) 6 sheets (82 to 105 gsm) A3: 5 sheets (52 to 64 gsm) 4 sheets (65 to 81.4 gsm) 3 sheets (82 to 105 gsm) Staple On Demand: 50 sheets (52 to 90 gsm) Dimensions (W x D x H): 637 x 623 x 1,142 mm (when the extension tray is extended) Weight: Approx. 31 kg * Large size media A3 support will be available from March 2021 when an update to the firmware is applied: A3*: 10 sheets (52 to 64 gsm) 8 sheets (65 to 81.4 gsm) 6 sheets (82 to 105 gsm)	2/4 Hole Puncher Unit-A1	(Requires either the Staple Finisher-AB1 or Booklet Finisher-AB1) Two or Four Holes Acceptable Punch Paper Weight: 52 to 300 gsm Acceptable Punch Paper Size: Two holes: A3, A4, A4R, A5, B4, B5, B5R Four holes: A3, A4
		4 Hole Puncher Unit-A1	(Requires either the Staple Finisher-AB1 or Booklet Finisher-AB1) Four Holes Acceptable Punch Paper Weight: 52 to 300 gsm Acceptable Punch Paper Size: Four holes: A3, A4, A4R, A5, B4, B5, B5R
		HARDWARE ACCESSORIES Card Readers	Various card readers available e.g. MiCard Plus. Please contact local Canon Office for more details. Copy Card Reader Attachment-B7 IC Card Reader Box for Numeric Keypad-A1 Copy Card Reader-F1
		Others	Printer Cover-M2 Tab Feeding Attachment-F1 Buffer Pass Unit-P1 Utility Tray-B1 Numeric Keypad-A2
		SECURITY OPTIONS Data Security	256GB SSD-A1 1TB SSD-A1 Memory Mirroring Kit-A1
		SYSTEM AND CONTROLLER OPTIONS Print Accessories Barcode Printing EFI-Fiery Based Controller EFI-Fiery Based Controller Options	PCL International Font Set-A1 Barcode Printing Kit-D1 imagePASS-R1 Hot Folders License Fiery Compose Fiery Impose Fiery Impose and Compose
		System Accessories	NFC Kit-E2 Serial Interface Kit-K3 Copy Control Interface Kit-A1 Connection Kit-A3 for Bluetooth LE
		Fax Accessories	Super G3 FAX Board-AX1 Super G3 2nd Line Fax Board-AX1 Remote Fax Kit-A1 IP FAX Expansion Kit-B1
		OTHER OPTIONS Accessibility Accessories	ADF Access Handle-A1 Voice Guidance Kit-G1 Voice Operation Kit-D1 Staple Cartridge-Y1 (2 x 2,000pcs)* Staple-P1 (2 x 5,000pcs) *For Booklet Finisher only
		Consumables	

Software & Solutions



Certifications and compatibility



Canon Ireland
 3006 Lake Drive
 Citywest, Saggart
 Co. Dublin, Ireland
 Telephone No: 01 2052400
 Facsimile No: 01 2052525
 canon.ie

Canon (UK) Ltd
 5 The Square
 Stockley Park
 Uxbridge
 UB11 1ET
 Tel: 01895 648 000
 www.canon.co.uk

Canon Inc.
 canon.com

Canon Europe
 canon-europe.com

 English edition
 © Canon Europa N.V., 2020