

imageRUNNER ADVANCE DX C5800 Series

POWERFUL PRODUCTIVITY FROM SECURE COLOUR A3 MULTIFUNCTION DEVICES

MAIN CONFIGURATION OPTIONS

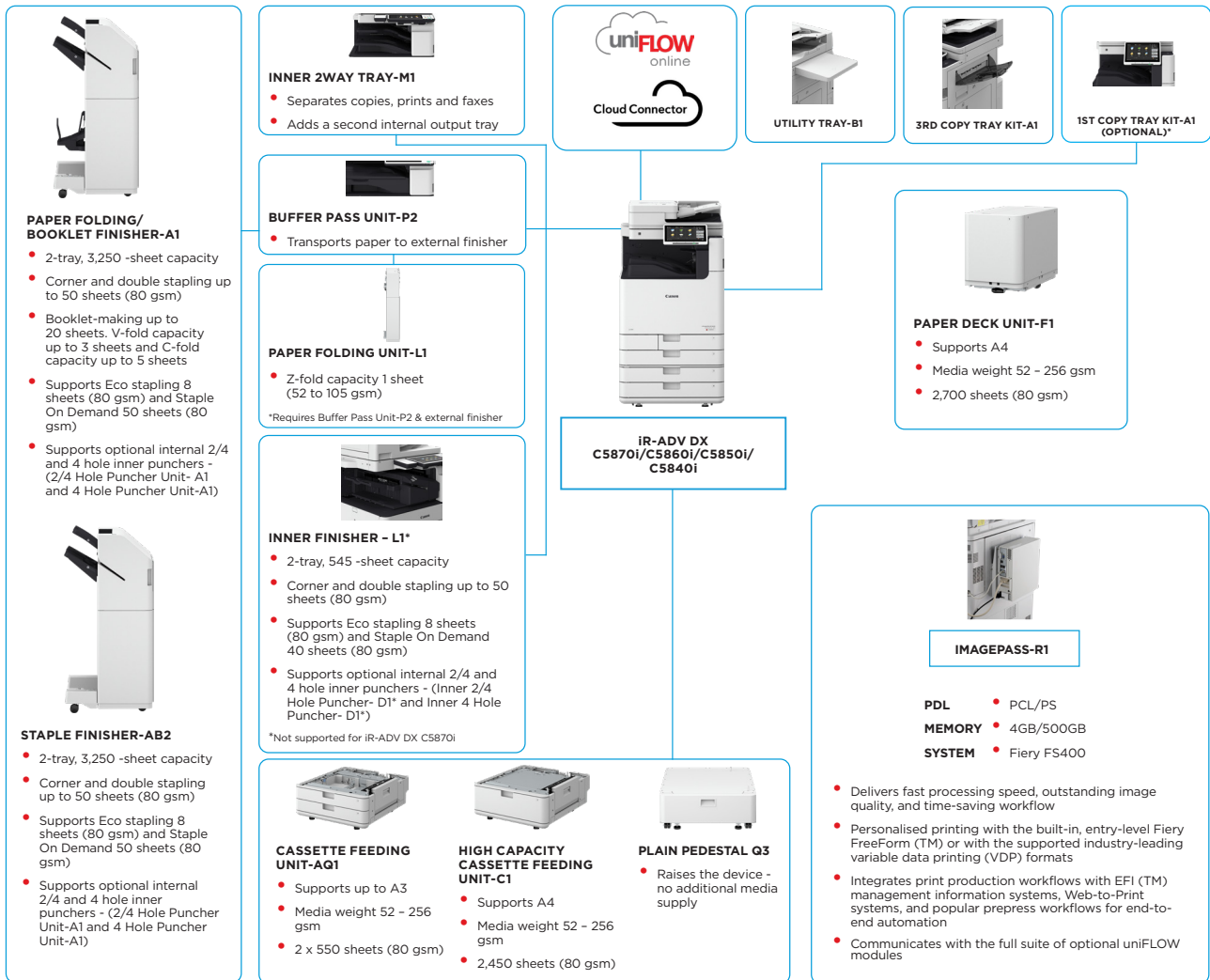

This flat configuration is for illustration purpose only. For a complete list of options and the exact compatibility relationships, please refer to the [online product configurator](#).

The Unified Firmware Platform (UFP) ensures that the latest feature upgrades and protection are available, for an enhanced user experience across the entire iR ADVANCE DX portfolio.

*To support Sustainability and save on raw materials required for plastics, 1st Copy Tray Kit-A1 is optional.

TECHNICAL SPECIFICATIONS

imageRUNNER ADVANCE DX C5800 Series

MAIN UNIT

Machine type Core functions Processor Control Panel

A3 Color Laser Multifunctional
Print, Copy, Scan, Send, Store and Optional Fax
1.8GHz Dual Core Processor
10.1" TFT LCD WSVGA Color Touch panel
(up to 90° tilttable)
Standard: 6.0GB RAM
Standard: (SSD) 256GB,
Optional: (SSD) 256GB, 1TB
NETWORK
Standard: 1000Base-T/100Base-TX/10Base-T,
Wireless LAN (IEEE 802.11 b/g/n);
OTHERS
Standard: USB 2.0 (Host) x1, USB 3.0 (Host) x1,
USB 2.0 (Device) x1;
Optional: Serial Interface, Copy Control Interface

Paper Supply Capacity (A4, 80gsm)

Standard: 1,200 sheets
100-sheet Multi-purpose tray x 1
550-sheet Paper cassette x 2,
Maximum: 6,350 sheets (with High Capacity Cassette
Feeding Unit-C1 + Paper Deck Unit-F1)
Maximum: 3,450 Sheets (with Staple Finisher-AB2 or
Paper Folding/Booklet Finisher-A1 and 3rd Copy
Tray Kit-A1)

Paper output capacity (A4, 80gsm)

Collate, Group, Offset, Staple, Saddle Stitch, Hole Punch,
Eco Staple, Staple On Demand, V-fold, C-fold, Z-fold
* Finishing capabilities will vary depending on the options connected.

Finishing capabilities

Supported Media Types

Multi-purpose tray:
Thin, Plain, Recycled, Color, Heavy, Coated, Tracing,
Bond, Transparency, Label, Pre-punched, Letterhead,
Tab, Envelope
Paper Cassette (Upper/Lower):
Thin, Plain, Recycled, Color, Heavy, Bond, Transparency,
Pre-punched, Letterhead, Envelope*
* Envelope Feeder Attachment (standard) is required.

Supported Media Sizes

Multi-purpose tray:
Standard size: SRA3, A3, A4, A4R, A5, A5R, A6R, B4,
B5, B5R
Custom size: 98.0 x 139.7 mm to 320.0 x 457.2 mm
Free Size: 98.0 x 139.7 mm to 320.0 x 457.2 mm
Envelopes: COM10 No.10, Monarch, DL, ISO-C5
Envelope custom size: 98.0 x 90.0 mm to 320.0 x 457.2 mm
Upper Cassette:
Standard size: A4, A5, A5R, A6R, B5
Custom Size: 98.0 x 148.0 mm to 297.0 x 215.9 mm
Envelopes: COM10 No.10, Monarch, DL, ISO-C5

Supported media weights

Multi-purpose tray: 52 to 300 gsm
Paper Cassette (Upper/Lower): 52 to 256 gsm
Duplex: 52 to 256 gsm

Warm-up Time

Quick Startup Mode: 4 Seconds or Less*
* Time from device power-on to when the copy icon appears and is
enabled to operate on the touch panel display.

Dimensions (W x D x H)

From Sleep Mode:
7 Seconds or Less (iR-ADV DX C5870i)
6 Seconds or Less (iR-ADV DX C5860i/C5850i/C5840i)
From Power On: 6 Seconds or less (with Quick Start
Mode)*
* Time from device power-on, until copy ready (not print reservation).

Installation Space (W x D)

iR-ADV DX C5870i/C5860i/C5850i/C5840i:
Basic: 1,138 x 1,162 mm (Right Cover Open with
Multi-purpose tray extended + Cassette Drawers Open)
Fully Configured: 1,866 x 1,162 mm (Staple Finisher-AB2/
Paper Folding/Booklet Finisher-A1 with the extension tray
extended + Paper Deck Unit-F1 + Cassette Drawers open)
iR-ADV DX C5870i: Approx. 108 kg including regular toner
iR-ADV DX C5860i/C5850i: Approx. 105 kg including
regular toner
iR-ADV DX C5840i: Approx. 104 kg including regular
toner

PRINT SPECIFICATIONS

Print Speed (BW/CL) * 1 sided only

iR-ADV DX C5870i
up to 70 ppm (A4, A5*, A5R, A6R*), up to 36 ppm (A3),
up to 42 ppm (A4R)

iR-ADV DX C5860i
up to 60 ppm (A4, A5*, A5R, A6R*), up to 32 ppm (A3),
up to 36 ppm (A4R)

iR-ADV DX C5850i
up to 50 ppm (A4, A5*, A5R, A6R*), up to 27 ppm (A3),
up to 30 ppm (A4R)

iR-ADV DX C5840i
up to 40 ppm (A4, A5*, A5R, A6R*), up to 21 ppm (A3),
up to 24 ppm (A4R)

Print Resolution (dpi)

1,200 x 1,200

Page description languages

Standard: UFR II, PCL6, Adobe® PostScript®3™

Direct Print

Supported file types: PDF, EPS, TIFF/JPEG, and XPS

Printing from mobile and cloud

AirPrint, Mopria, Universal Print by Microsoft, Canon
PRINT App, and uniFLOW Online (optional)
A range of software and MEAP-based solutions are
available to provide printing from mobile devices or
internet-connected devices and cloud-based services
depending on your requirements. Please contact your
sales representative for further information.

Fonts

PS fonts: 136 Roman
PCL fonts: 93 Roman, 10 Bitmap fonts, 2 OCR fonts,
Andalé Mono WT J/K/S/T*¹
(Japanese, Korean, Simplified and Traditional Chinese),
Barcode fonts*²
*¹ Optional PCL International Font Set-A1 is required.
*² Optional Barcode Printing Kit-D1 is required.

Print Features

Secured Print, Secure Watermark, Header/Footer,
Page Layout, Two-sided Printing, Mixed Paper Sizes/
Orientations, Front/Back Covers, Toner Reduction, Poster
Printing, Forced Hold printing, Print Date, Scheduled
Printing, Printing Using a Virtual Printer

Operating System

UFR II: Windows® 8.1/10/Server2012/Server2012 R2/
Server2016/Server2019, Mac OS X(10.11 or later)
PCL: Windows® 8.1/10/Server2012/Server2012 R2/
Server2016/Server2019
PS: 8.1/10/Server2012/Server2012 R2/Server2016/
Server2019, Mac OS X(10.11 or later)
PPD: Windows® 8.1/10, Mac OS X(10.10 or later)
As of Oct. 2020

COPY SPECIFICATIONS

Copy Speed (BW & CL)

* 1 sided only

iR-ADV DX C5870i
up to 70 ppm (A4, A5*, A5R, A6R), up to 36 ppm (A3), up
to 42 ppm (A4R)

iR-ADV DX C5860i
up to 60 ppm (A4, A5*, A5R, A6R), up to 32 ppm (A3), up
to 36 ppm (A4R)

iR-ADV DX C5850i
up to 50 ppm (A4, A5*, A5R, A6R), up to 27 ppm (A3), up
to 30 ppm (A4R)

iR-ADV DX C5840i
up to 40 ppm (A4, A5*, A5R, A6R), up to 21 ppm (A3), up
to 24 ppm (A4R)

First-Copy-Out Time (A4, BW/CL)

iR-ADV DX C5870i:
Approx. 2.7 / 3.7 seconds or less

iR-ADV DX C5860i:
Approx. 2.9 / 4.2 seconds or less

iR-ADV DX C5850i:
Approx. 3.4 / 4.9 seconds or less

iR-ADV DX C5840i:
Approx. 4.1 / 6.1 seconds or less
600 x 600

Copy resolution (dpi)

Multiple Copies

Copy Density

Magnification

Up to 999 copies
Automatic or Manual (9 Levels)
Variable zoom: 25% to 400% (1% Increments)
Preset reduction/enlargement: 25%, 50%, 70%, 100%(1:1),
141%, 200%, 400%

Copy Features

Preset R/E Ratios by Area, Two-Sided, Density
Adjustment, Original Type Selection, Interrupt Mode,
Book to Two Pages, Two-sided Original, Job Build, N
on 1, Add Cover, Insert Sheets, Different Size Originals,
Page Numbering, Copy Set Numbering, Sharpness, Erase
Frame, Secure Watermark, Print Date, Gutter, Print &
Check, Negative/Positive, Repeat Images, Merge Job
Blocks, Mirror Image, Store in Mail Box, Superimpose
Image, Copy ID Card, Skip Blank Pages, Free Size Original,
Color Mode, Reserved Copy, Copy Sample

SCAN SPECIFICATION

Type

Single-pass Duplexing Automatic Document Feeder*
[2-sided to 2-sided (Automatic)]
* Detect Feeder Multi Sheet Feed is supported.

up to 200 Sheets

Document Feeder Paper Capacity (80 gsm)

Acceptable Originals and weights

Platen: Sheet, Book, and 3-Dimensional Objects

Document Feeder media weight:

1-sided scanning: 38 to 220 gsm (BW, CL)

2-sided scanning: 38 to 220 gsm (BW, CL)

* An acceptable weights of A6R or smaller is 50 to 220gsm.

Platen scanning size: up to 297.0 x 431.8 mm

Document Feeder media size:

A3, A4, A4R, A5, A5R, A6R, B4, B5, B5R, B6R

Custom size: 70.0 x 139.7 mm to 304.8 x 431.8 mm

Scan Speed (ipm: BW/CL; A4)

1-sided Scanning:
135/135 (300 x 300 dpi, send), 80/80
(600 x 600 dpi, copy),

2-sided Scanning:
270/270 (300 x 300 dpi, send), 160/90
(600 x 600 dpi, copy)

Scan Resolution (dpi)

Scan for Copy: 600 x 600
Scan for Send: (Push) 600 x 600 (SMB/FTP/WebDAV/
IFAX), (Pull) 600 x 600
Scan for Fax: 600 x 600

Pull Scan Specifications

Color Network ScanGear2. For both TWAIN and WIA
Supported OS: Windows® 8.1/10/Server2012/
Server2012 R2/Server 2016
As of Mar. 2020

Scan Method

Push Scan, Pull Scan, Scan to Box, Scan to Advanced
Space, Scan to Network, Scan to USB Memory Key, Scan
to Mobile devices, Scan to cloud (uniFLOW Online, Cloud
Connector - Optional)

SEND SPECIFICATIONS Destination

Standard: E-mail/Internet FAX (SMTP*), SMB3.0, FTP,
WebDAV, Mail Box
Optional: Super G3 FAX, IP Fax
* OAuth 2.0 authentication method available for Microsoft 365 and
Google Workspace

Address Book

Send resolution (dpi)

LDAP (2,000)/Local (1,600)/Speed dial (200)

Push: up to 600 x 600

Pull: up to 600 x 600

Communication protocols

File: FTP(TCP/IP), SMB3.0 (TCP/IP), WebDAV
E-mail/I-Fax: SMTP, POP3



TECHNICAL SPECIFICATIONS

imageRUNNER ADVANCE DX C5800 Series

File Format	TIFF, JPEG, PDF (Limited Color, Compact, Searchable, Apply policy, Optimize for Web, PDF/A-1b, Trace & Smooth, Encrypted, Device Signature, User Signature), XPS (Compact, Searchable, Device Signature, User Signature), Office Open XML (PowerPoint, Word)	ENVIRONMENTAL SPECIFICATIONS	
Universal Send Features	Original Type Selection, Two-sided Original, Book to Two Pages, Different-size Originals, Density Adjustment, Sharpness, Copy Ratio, Erase Frame, Job Build, Delayed Send, Preview, Job Done Notice, File Name, Subject/Message, Reply-to, E-mail Priority, TX Report, Original Content Orientation, Skip Blank Pages	Operating Environment	Temperature: 10 to 30 °C Humidity: 20 to 80 % RH (Relative Humidity) 220-240 V, 50/60 Hz, 6 A
FAX SPECIFICATIONS	(Optional)	Power source	Maximum: Approx. 2,000 W (iR-ADV DX C5870i) Approx. 1,800 W (iR-ADV DX C5860i/C5850i/C5840i) Copying (with DADF continuous scan): Approx. 943 W ^{*1} Standby: Approx. 53.4 W ^{*1} Sleep mode: Approx. 0.8 W ^{*2}
Maximum Number of Connection Lines	2 (2nd line optional)	Power consumption	^{*1} Reference value: measured one unit ^{*2} 0.8 W is not available in all circumstances due to certain settings.
Modem Speed	Super G3: 33.6 kbps G3: 14.4 kbps	Noise levels (BW/CL)	Typical Electricity Consumption (TEC)* : iR-ADV DX C5870i: 0.86 kWh iR-ADV DX C5860i: 0.71 kWh iR-ADV DX C5850i: 0.58 kWh iR-ADV DX C5840i: 0.46 kWh ^{* As per USA Energy Star 3.0}
Compression Method	MH, MR, MMR, JBIG		Sound Power Level (LWA,m) Active (BW) (1-sided) iR-ADV DX C5870i: 66 dB*, Kv 3 dB* iR-ADV DX C5860i: 64 dB*, Kv 3 dB* iR-ADV DX C5850i: 62 dB*, Kv 3 dB* iR-ADV DX C5840i: 61 dB*, Kv 3 dB*
Resolution (dpi)	400 x 400 (Ultra Fine), 200 x 400 (Super Fine), 200 x 200 (Fine), 200 x 100 (Normal)		^{* Reference value: measured only one unit with ISO7779, described with ISO9296 (2017)} Sound Pressure (LpAm) Bystander's position: Active (BW/CL) (1-sided) iR-ADV DX C5870i: 52 dB*/52 dB* iR-ADV DX C5860i: 50 dB*/51 dB* iR-ADV DX C5850i: 48 dB*/49 dB* iR-ADV DX C5840i: 47 dB*/47 dB*
Sending/Receiving Size	Sending: A3, A4, A4R, A5 ^{*1} , A5R ^{*1} , B4, B5 ^{*2} , B5R ^{*1} Receiving: A3, B4, A4, A4R, A5R, B5, B5R ^{*1} Sent as A4 ^{*2} Sent as B4 short		Stand-by iR-ADV DX C5870i/C5860i/C5850i: 23 dB* ^{* Reference value: measured only one unit with ISO7779, described with ISO9296 (2017)}
FAX memory	Up to 30,000 pages (2,000 jobs)	Standards	
Speed dials	Max. 200	CONSUMABLES	
Group dials/destinations	Max. 199 dials	Toner Cartridges	C-EXV 58 Toner BK/C/M/Y C-EXV 58L Toner C/M/Y
Sequential broadcast	Max. 256 addresses	Toner Yield (Estimated Yield @5% coverage)	C-EXV 58 Toner BK: 71,000 pages C-EXV 58 Toner C/M/Y: 60,000 pages C-EXV 58L Toner C/M/Y: 26,000 pages
Memory backup	Yes	SOFTWARE AND PRINTER MANAGEMENT	For detailed information please visit our website https://www.canon-europe.com/business/ Universal Login Manager (ULM) uniFLOW Online [*]
Fax Features	Sender's Name (TTI), Selecting the Telephone Line (when sending fax), Direct Send, Delayed Send, Preview, Job Done Notice, TX Report, Interrupt Transmission, Sequential Broadcasting, Password/Subaddress Sending, Confidential Mailbox, 2 on 1 Log	Tracking and reporting	^{* For more information, please refer to uniFLOW Online}
STORE SPECIFICATIONS		Remote management tools	iWEMC eMaintenance Content Delivery System Network ScanGear
Mail Box (Number supported)	100 User Inboxes, 1 Memory RX Inbox, 50 Confidential Fax Inboxes Maximum 10,000 Pages (2,000 jobs) Stored	Scanning software	Canon Driver Configuration Tool MEAP (Multifunctional Embedded Application Platform) Kofax PowerPDF Advanced (Optional)
Advanced Space	Communication Protocol: SMB or WebDAV Supported Client PC: Windows [*] 8.1/10 Concurrent Connections (Max.): SMB:64, WebDAV:3 Standard:16 GB (With option: max. 480GB)	Optimisation tools	
Advanced Space available disc space	Standard:16 GB (With option: max. 480GB)	Platform	
Advanced Space Features	Authentication for Advanced Space Log-in, Sort Function, Printing a PDF File with a Password, imageWARE Secure Audit Manager Support, Search, File Preview, Authentication Management, Open to public, URI TX, Backup/Restore	Document Publishing	
SECURITY SPECIFICATIONS		FIERY PRINT CONTROLLER SPECIFICATIONS (EMBEDDED)	For full specifications & options, please visit the Canon website Optional on all models imagePASS-R1 (Embedded) 1200 x 1200, 600 x 600 Adobe PS3, PCL6 4GB (1x4GB) 500 GB SATA Intel Pentium G4400 (3.3GHz) FS400
Authentication and Access Control (Activation is required)	User Authentication (Picture Login, Picture and PIN Login, Card Login [*] , Username and Password Login, Function Level Login, Mobile Login), Department ID Authentication (Department ID and PIN Login, Function Level Login), uniFLOW Online ^{**} (PIN Login, Picture Login, Picture and PIN Login, Card Login [*] , Card and PIN Login, Username and Password Login, Department ID and PIN Login, Function Level Login), Access Management System (Access Control), Cloud Connector [*] (PIN Login), Microsoft Entra ID (PIN Login, Card Login), Two-Factor Authentication at LUI/ROI [*] Card readers are optional, please refer to Hardware Accessories ^{**} Subscription required	Name	
Document Security	Print Security (Secure Print, Encrypted Secure Print, Forced Hold Printing, uniFLOW Secure Print [†]), Receive Data Security (Confidential Fax Inbox Forwarding Received Documents Automatically), Scan Security (Encrypted PDF, Device Signature PDF/XPS, User Signature PDF/XPS, Adobe LiveCycle [®] Rights Management ES2.5 Integration), BOX Security (Mail Box Password Protected, Advanced Space Access Control), Send Data Security (Setting for requesting password input per transmission, Restricted E-mail/File send functions, Confirming FAX number, Allow/Restrict Fax Driver Transmissions, Allow/Restrict Sending from History, S/MIME Support), Document Tracking (Secure Watermark) [†] Requires uniFLOW Online / uniFLOW	Print Resolution (dpi)	
Network Security	TLS 1.3, IPsec, IEEE802.1X authentication, SNMP V3.0, Firewall Functionality (IP/MAC Address Filtering), Dual Network Support (Wired LAN/Wireless LAN, Wired LAN/Wired LAN), Disabling Unused Functions (Enabling/Disabling Protocols/Applications, Enabling/Disabling Remote UI, Enabling/Disabling USB Interface), G3 FAX separation from LAN, USB Port separation from LAN, Prohibit the execution of files stored in Advanced Box in the MFP, Scan and Send -Virus Concerns for E-mail Reception	Page Description Language(s)	
Device Security	Protecting SSD Data [SSD Data Encryption (FIPS 140-3), SSD Lock], Standard SSD Initialize (NIST 800-88 PURGE LEVEL), Trusted Platform Module (TPM 2.0), Job Log Conceal Function, Protecting MFD Software Integrity, Checking MFD Software Integrity & Platform Firmware Resiliency (NIST SP800-193) with Automatic System Recovery (Verify System at Startup, Runtime Intrusion Detection enabled with Trellix Embedded Control), HCD-PP	Memory	
Device Management and Auditing	Administrator Password, Digital Certificate And Key Management, Audit Log, Cooperating with External Security Audit System (Security Information and Event Management), Image Data Logging, Security Policy Setting	Hard Disk Drive	
		Processor Speed	
		System	
		PAPER SUPPLY OPTIONS	
		Cassette Feeding Unit-AQ1	Paper Capacity: 2 x 550 sheets (80 gsm) Paper Type: Thin, Plain, Recycled, Color, Heavy, Bond, Transparency, Pre-punched, Letterhead Paper Size: A3, A4, A4R, A5, A5R, A6R, B4, B5, B5R Custom size: 98.0 x 148.0 mm to 304.8 x 457.2 mm
		High Capacity Cassette Feeding Unit-C1	Paper Weight: 52 to 256 gsm Dimensions (W x D x H): 620 x 660 x 251 mm (attached to the main unit) Weight: Approx. 22 kg Paper Capacity: 2,450 sheets (80 gsm) Paper Type: Thin, Plain, Recycled, Color, Heavy, Bond, Pre-punched, Letterhead Paper Size: A4 Paper Weight: 52 to 256 gsm Dimensions (W x D x H): 620 x 660 x 251 mm (attached to the main unit) Weight: Approx. 29 kg
		Paper Deck Unit-F1	Paper Capacity: 2,700 sheets (80 gsm) Paper Type: Thin, Plain, Color, Recycled, Heavy, Pre-punched Paper Size: A4, B5 Paper Weight: 52 to 256 gsm Dimensions (W x D x H): 344 x 630 x 440 mm (attached to the main unit) Weight: Approx. 31 kg
		OUTPUT OPTIONS*	^{* Paper capacity may vary with different paper type/size.}
		1st Copy Tray Kit-A1	Capacity (with 80gsm paper): A4, A5, A5R, A6R, B5: 250 sheets SRA3, A3, A4R, B4, B5R: 100 sheets Paper Weight: 52 to 300 gsm

TECHNICAL SPECIFICATIONS

imageRUNNER ADVANCE DX C5800 Series

Inner 2way Tray-M1

Tray Capacity (with 80 gsm paper)
Upper tray: A4, A5, A5R, A6R, B5: 100 sheets
SRA3, A3, A4R, B4, B5R: 50 sheets
Lower tray: A4, A5, A5R, A6R, B5: 100 sheets
SRA3, A3, A4R, B4, B5R: 100 sheets

Paper Weight: 52 to 300 gsm
Dimensions (W x D x H): 428 x 405 x 88 mm
Weight: Approx. 0.7 kg

3rd Copy Tray Kit-A1

Capacity (with 80gsm paper):
A4, A5R, B5: 100 sheets
A3, A4R, B4, B5R: 75 sheets
Paper Weight: 52 to 300 gsm
Dimensions (W x D x H): 442 x 373 x 176 mm
(attached to the main unit, when the extension tray is extended)
Weight: 0.5 kg

Inner Finisher-L1

(Not supported for iR-ADV DX C5870)

Tray Capacity (with 80gsm paper):
Upper Tray: SRA3, A3, A4, A4R, A5, A5R, A6R, B4, B5, B5R: approx 45 sheets
Lower Tray: A4, A5, A5R, B5: approx. 500 sheets,
SRA3, A3, A4R, B4, B5R: 250 sheets,
A6R: 30 sheets
Envelope: 10 sheets

Paper Weight: 52 to 300 gsm
Staple Position: Corner, Double
Staple Capacity: (52 to 90 gsm paper)
A4, B5: 50 sheets
A4R: 40 sheets
A3, B4: 30 sheets
Eco Staple:
A3, A4, B4, B5: 10 sheets (52 to 64 gsm)
8 sheets (65 to 81.4 gsm)
6 sheets (82 to 105 gsm)

Staple On Demand: 40 sheets (80 gsm)
Dimensions (W x D x H): 743 x 525 x 225 mm
(attached to the main unit, when the extension tray is extended)
Weight: Approx. 9.1 kg

Staple Finisher-AB2

(Requires Buffer Pass Unit-P2)
Tray Capacity (with 80gsm paper):
Upper Tray: A4, A5, A5R, A6R, B5: approx. 250 sheets,
SRA3, A3, A4R, B4, B5R: approx. 125 sheets
Lower Tray: A4, A5, A5R, B5: 3,000 sheets,
SRA3, A3, A4R, B4, B5R: 1,500 sheets,
A6R: 250 sheets
Envelopes: Monarch: 30 sheets, COM10 No.10,
DL, ISO-C5: 100 sheets

Paper Weight:
Upper Tray 52 to 256 gsm,
Lower Tray 52 to 300 gsm
Staple Position: Corner, Double
Staple Capacity: (52 to 90 gsm)
A4, B5: 50 sheets
A4R: 40 sheets
A3, B4: 30 sheets
Eco Staple:
A3, A4: 10 sheets (52 to 64 gsm)
8 sheets (65 to 81.4 gsm)
6 sheets (82 to 105 gsm)

Staple On Demand: 50 sheets (52 to 90 gsm)
Dimensions (W x D x H): 637 x 623 x 1,142 mm
(when the extension tray is extended)
Weight: Approx. 31 kg

Paper Folding/ Booklet Finisher-A1

(Requires Buffer Pass Unit-P2)
(Includes the above Staple Finisher-AB2 basic staple specifications.)
Saddle Stitch paper size: A3, A4R, B4
Saddle Stitch Staple Capacity: 20 sheets x 10 sets
(52 to 81.4 gsm) (including 1 cover sheet 52 to 256 gsm)
V-fold Capacity: up to 3 sheets (52 to 105 gsm)
C-fold Capacity: up to 5 sheets (52 to 128 gsm)
Dimensions (W x D x H): 637 x 623 x 1,142 mm
(when the extension tray is extended)
Weight: Approx. 57 kg

Paper Folding Unit-L1

(Requires Buffer Pass Unit-P2 & external finisher)
Paper size: A3, A4, B4
Z-fold Capacity: 1 sheet (52 to 105 gsm)
Dimensions (W x D x H): 201 x 579 x 896 mm
Weight: Approx. 12 kg

Inner 2/4 Hole Puncher-D1

(Not supported for iR-ADV DX C5870)

(Requires the Inner Finisher-L1)
Two or Four Holes
Acceptable Punch Paper Weight: 52 to 300 gsm
Acceptable Punch Paper Size:
Two holes: A3, A4, A4R, A5, B4, B5, B5R
Four holes: A3, A4

Inner 4 Hole Puncher-D1

(Not supported for iR-ADV DX C5870)

(Requires the Inner Finisher-L1)
Four Holes
Acceptable Punch Paper Weight: 52 to 300 gsm
Acceptable Punch Paper Size:
Four holes: A3, A4, A4R, A5, B4, B5, B5R

2/4 Hole Puncher Unit-A1

(Requires either the Staple Finisher-AB2 or Paper Folding/Booklet Finisher-A1)
Two or Four Holes
Acceptable Punch Paper Weight: 52 to 300 gsm
Acceptable Punch Paper Size:
Two holes: A3, A4, A4R, A5, B4, B5, B5R
Four holes: A3, A4

4 Hole Puncher Unit-A1

(Requires either the Staple Finisher-AB2 or Paper Folding/Booklet Finisher-A1)
Four Holes
Acceptable Punch Paper Weight: 52 to 300 gsm
Acceptable Punch Paper Size:
Four holes: A3, A4, A4R, A5, B4, B5, B5R

HARDWARE ACCESSORIES

Card Readers

Various card readers available e.g. MiCard Plus.
Please contact local Canon Office for more details.

Copy Card Reader Attachment-B7
IC Card Reader Box for Numeric Keypad-A1
Copy Card Reader-F1
Printer Cover-M2
Tab Feeding Attachment-F1
Buffer Pass Unit-P2
Utility Tray-B1
Numeric Keypad-A2

Others

SECURITY OPTIONS

Data Security

256GB SSD-A1
1TB SSD-A1
Memory Mirroring Kit-A1

SYSTEM AND CONTROLLER OPTIONS

Print Accessories
Barcode Printing
EFI-Fiery Based Controller
EFI-Fiery Based Controller Options

System Accessories

PCL International Font Set-A1
Barcode Printing Kit-D1
imagePASS-R1
Hot Folders License
Fiery Compose
Fiery Impose
Fiery Impose and Compose
Serial Interface Kit-K3
Copy Control Interface Kit-A1
Connection Kit-A3 for Bluetooth LE
Super G3 FAX Board-AX1
Super G3 2nd Line Fax Board-AX1
Remote Fax Kit-A1
IP FAX Expansion Kit-B1

Fax Accessories

OTHER OPTIONS

Accessibility Accessories

ADF Access Handle-A1
Voice Guidance Kit-G1
Voice Operation Kit-D1
Staple Cartridge-Y1 (2 x 2,000pcs)*
Staple-P1 (2 x 5,000pcs)
*For Booklet Finisher only
Antimicrobial Film* - Various Sheets designed to fit the devices most common touch points.
*Application by a Service Engineer is recommended

Consumables

Device Protection

Software & Solutions



Certifications and compatibility



Canon Ireland

3006 Lake Drive
Citywest, Saggart
Co. Dublin, Ireland
Telephone No: 01 2052400
Facsimile No: 01 2052525
canon.ie

Canon (UK) Ltd

The Bower
4 Roundwood Avenue
Stockley Park
Uxbridge
UB11 1AF

Canon Inc. canon.com

Canon Europe
canon-europe.com

English edition
© Canon Europa N.V., 2024

