

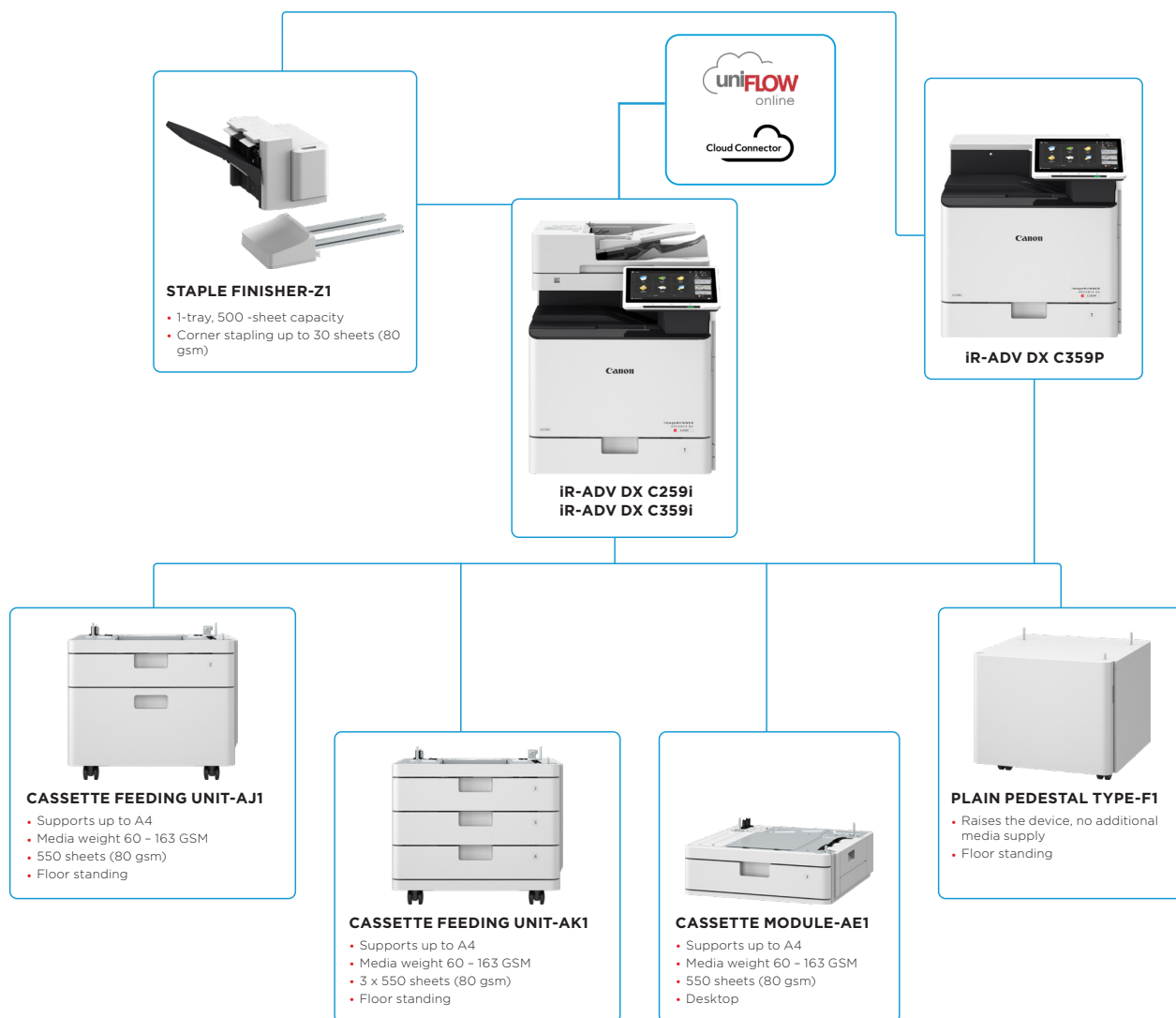

Canon Europe Ltd.
B112020204 How: 044 939 43 Brand

COMPACT COLOUR A4 DEVICES WITH STREAMLINED WORKFLOWS FOR FAST, HIGH-QUALITY PRINTING AND SCANNING.

MAIN CONFIGURATION OPTIONS



This flat configuration is for illustration purpose only. For a complete list of options and the exact compatibility relationships, please refer to the [online product configurator](#).

The Unified Firmware Platform (UFP) ensures that the latest feature upgrades and protection are available, for an enhanced user experience across the entire iR ADVANCE DX portfolio.

TECHNICAL SPECIFICATIONS

imageRUNNER ADVANCE DX C259/C359 Series

MAIN UNIT		Operating System	UFR II: Windows® 8.1/10/11/Server2012/Server2012 R2/Server2016/Server2019/Server2022, Mac OS X (10.11 or later)
Machine type	A4 Colour Laser Multifunctional		
Core functions	Print, Copy*, Scan*, Send*, Store and Optional Fax* * Not applicable to iR-ADV DX C359P (Printer model)		
Processor	1.8GHz Dual Core Processor		
Control Panel	10.1" TFT LCD WSVGA Color Touch panel		
Memory	Standard: 4GB RAM		
Hard Disk drive	Standard: (SSD) 256 GB		
Interface Connection	NETWORK Standard: 1000Base-T/100Base-TX/10Base-T Optional: Wireless LAN (IEEE 802.11 b/g/n) OTHERS Standard: USB 2.0 (Host) x1, USB 3.0 (Host) x1, USB 2.0 (Device) x1; Optional: Serial Interface, Copy Control Interface	COPY SPECIFICATIONS	
		Copy Speed* (BW/CL)	iR-ADV DX C359i 35 ppm (A4), 26 ppm (A5R), 61 ppm (A5), 23 ppm (A6) iR-ADV DX C259i 25 ppm (A4), 26 ppm (A5R), 46 ppm (A5), 23 ppm (A6) * Single-sided
Paper Supply Capacity (A4, 80gsm)	Standard: 650 Sheets 100-sheets Multi-purpose tray 550-sheets Paper cassette x1 Maximum: 2,300 Sheets (with Cassette Feeding Unit-AK1)	First-Copy-Out Time (A4; BW/ CL)	iR-ADV DX C359i: Approx. 5.1/6.9 seconds or less iR-ADV DX C259i: Approx. 6.9/9.4 seconds or less
Paper output capacity (A4, 80gsm)	Standard: 250 Sheets Maximum: 500 Sheets (with Staple Finisher-Z1)	Copy resolution (dpi)	600 x 600, 300 x 600
Finishing capabilities	Standard: Collate, Group With Finisher : Collate, Group, Offset, Staple	Multiple Copies	Up to 999 copies
Supported media types	Multi-purpose tray: Thin, Plain, Heavy, Recycled, Color, Transparency, Pre-punched, Bond, Label, Envelope Paper Cassette: Thin, Plain, Heavy, Recycled, Color, Pre-punched, Bond, Envelope*	Copy Density	Automatic or Manual (9 Levels)
Supported media sizes	Multi-purpose tray: Standard size: A4, A5, A5R, A6, B5, Custom Size: 98.0 x 148.0 mm to 216.0 x 355.6 mm Envelopes: COM10 No.10, Monarch, DL, ISO-C5 Envelope custom size: 98.0 x 148.0 mm to 216.0 x 355.6 mm Paper Cassette: Standard size: A4, A5, A5R, A6, B5, Custom size: 98.0 x 190.5 mm to 216.0 x 355.6 mm Envelopes: COM10 No.10, Monarch, DL, ISO-C5	Magnification	Variable zoom: 25% to 400% (1% Increments) Preset reduction/enlargement: 25%, 50%, 70%, 100%(1:1), 141%, 200%, 400%
Supported media weights	Multi-purpose tray: 60 to 220 gsm Cassette: 60 to 163 gsm Duplex: 60 to 163 gsm	Copy Features	Preset R/E Ratios by Area, Two-Sided, Density Adjustment, Original Type Selection, Interrupt Mode, Two-sided Original, Job Build, N on 1, Page Numbering, Copy Set Numbering, Sharpness, Erase Frame, Secure Watermark, Print Date, Copy ID Card, Skip Blank Pages, Color Mode, Reserved copy, Copy Sample
Warm-up Time	Quick Startup Mode: 4 seconds or less* (applicable to C359i/C259i) * Time from device power-on to when the copy icon appears and is enabled to operate on the touch panel display. From Sleep Mode: 10 seconds or Less From Power On: 10 seconds or Less* * iR-ADV DX C359i/C259i: Time from device power-on, until copy ready (not print reservation) * iR-ADV DX C359P: Time from device power-on, until print ready (not print reservation)	SCAN SPECIFICATIONS	
Dimensions (W x D x H)	iR-ADV DX C359i/C259i: 519 x 658 x 638 mm iR-ADV DX C359P: 519 x 658 x 525 mm	Standard type	Single-pass Duplexing Automatic Document Feeder* [2-sided to 2-sided (Automatic)] * Detect Feeder Multi Sheet Feed is supported.
Installation Space(W x D)	Basic: 852 x 908 mm (with Multi-purpose tray extended + paper cassette open) Fully Configured: 1,407 x 908 mm (with Staple Finisher-Z1 + Multi-purpose tray extended + paper cassette open)	Document Feeder Paper Capacity (80 gsm)	100 Sheets
Weight	iR-ADV DX C359i/C259i: Approx. 48 kg (including toner) iR-ADV DX C359P: Approx. 41 kg (including toner)	Acceptable originals and weights	Platen: Sheet, Book, and 3-Dimensional Objects Document Feeder media weight : 1-sided scanning: 42 to 128 gsm (BW), 64 to 128 gsm (CL) 2-sided scanning: 50 to 128 gsm (BW), 64 to 128 gsm (CL) Note: Business card: 80 to 220 gsm Original width narrower than A6 except business card: 50 to 128 gsm
PRINT SPECIFICATIONS		Supported media sizes	Platen scanning size: up to 216.0 x 355.6 mm Document Feeder media size: A4, A5R, A6, B5, Custom size: 48.0 x 128.0 mm to 216.0 x 355.6 mm Business card: 48.0 x 85.0 mm to 55.0 x 91.0 mm
Print Speed*	iR-ADV DX C359i/C359P 35 ppm (A4), 26 ppm (A5R), 61 ppm (A5), 23 ppm (A6) iR-ADV DX C259i 25 ppm (A4), 26 ppm (A5R), 46 ppm (A5), 23 ppm (A6) *1-sided	Scan Speed (ipm: BW/CL, A4)	Send (300 x 300 dpi): up to 95/190 when Automatic Colour Select "OFF" 1-sided Scanning: 95 2-sided Scanning: 190 Automatic Color Select "ON": 1-sided Scanning: 50 2-sided Scanning: 100 Copy: Scan Speed priority (300 x 600 dpi): 1-sided Scanning: 50 2-sided Scanning: 100 Image Quality priority (600 x 600 dpi): 1-sided Scanning: 30 2-sided Scanning: 50
Duplex Print Speed (A4/LTR)	iR-ADV DX C359i/C359P: BW 35ipm/36ipm, CL 35ipm/36ipm C259i: BW 25ipm/26ipm, CL 25ipm/26ipm	Scan Resolution (dpi)	Scan for Copy: up to 600 x 600 Scan for Send: (Push) up to 600 x 600 (SMB/FTP/WebDAV/IFAX), (Pull) up to 600 x 600 Scan for Fax: up to 600 x 600
Print Resolution (dpi)	600 x 600 to 1,200 x 1,200 (equivalent)	Pull Scan Specifications	Colour Network ScanGear2. For both TWAIN and WIA Supported OS: Windows®7/ 8.1/ 10/ Server2008/ Server2008 R2/ Server2012/ Server2012 R2/ Server 2016 As of Feb. 2020
Page description languages	Standard: UFR II, PCL6, Adobe® PostScript® 3™	Scan Method	Push Scan, Pull Scan, Scan to Box, Scan to Advanced Space, Scan to Network, Scan to USB Memory Key, Scan to Mobile devices, Scan to cloud (uniFLOW Online, Cloud Connector - Optional)
Direct Print	Supported file types: TIFF, JPEG, PDF, EPS, and XPS	SEND SPECIFICATIONS	
Printing from mobile and cloud	AirPrint, Mopria, Universal Print by Microsoft, Canon PRINT and uniFLOW Online A range of software and MEAP-based solutions are available to provide printing from mobile devices or internet-connected devices and cloud-based services depending on your requirements. Please contact your sales representative for further information	Destination	Standard: E-mail/Internet FAX (SMTP*), SMB 3.1.1, FTP, WebDAV, Mail Box Optional: Super G3 FAX, IP Fax (for iR-ADV DX C359i/C259i) * OAuth 2.0 authentication method available for Microsoft 365 and Google Workspace.
Fonts	PS fonts: 136 Roman PCL fonts: 93 Roman, 10 Bitmap fonts, 2 OCR fonts, Andalé Mono WT J/K/S/T [†] (Japanese, Korean, Simplified and Traditional Chinese), Barcode fonts [†] [†] Optional PCL International Font Set-A1 is required. ^{††} Optional Barcode Printing Kit-D1 is required.	Address Book	LDAP (2,000)/Local (1,600)/Speed dial (200)
Print Features	Secured Print, Secure Watermark, Header/Footer, Page Layout, Two-sided Printing, Toner Reduction, Poster Printing, Forced Hold printing, Print Date, Scheduled Printing, Printing Using a Virtual Printer	Send resolution (dpi)	Push: up to 600 x 600 Pull: up to 600 x 600
		Communication protocol	File: FTP(TCP/IP), SMB 3.1.1 (TCP/IP), WebDAV E-mail/I-Fax: SMTP, POP3
		File Format	Standard: TIFF, JPEG, PDF (Compact, Searchable, Apply policy, Optimize for Web, PDF A/1-b, Trace & Smooth, Encrypted, Device Signature, User Signature), XPS (Compact, Searchable, Device Signature, User Signature), Office Open XML (PowerPoint, Word)

TECHNICAL SPECIFICATIONS

imageRUNNER ADVANCE DX C259/C359 Series

Universal Send Features

Original Type Selection, Two-sided Original, Density Adjustment, Sharpness, Erase Frame, Job Build, Delayed Send, Preview, Job Done Notice, File Name, Subject/Message, Reply-to, E-mail Priority, TX Report, Original Content Orientation, Skip Blank Pages (Optional)

FAX SPECIFICATIONS

Maximum Number of Connection Lines

2 (2nd Line optional)

Modem Speed

Super G3: 33.6 kbps
G3: 14.4 kbps

Compression Method

MH, MR, MMR, JBIG

Resolution (dpi)

400x400 (Ultra Fine), 200x400 (Super Fine), 200x200 (Fine), 200x100 (Normal)

Sending/Recording Size

A4, A5*, A6*, B5*/A4, A5, B5
*Sent as A4

FAX memory

Up to 30,000 pages (2,000 jobs)

Speed dials

Max. 200

Group dials/destinations

Max. 199 dials

Sequential broadcast

Max. 256 addresses

Memory backup

Yes

Fax Features

Sender's Name (TTI), Selecting the Telephone Line (when sending fax), Direct Send, Delayed Send, Preview, Job Done Notice, TX Report, Interrupt Transmission, Sequential Broadcasting, Password/Subaddress Sending, Confidential Mailbox, 2 on 1 Log

STORE SPECIFICATIONS

Mail Box (Number supported)

100 User Inboxes,
1 Memory RX Inbox,
50 Confidential Fax Inboxes
Maximum 10,000 Pages (2,000 jobs) Stored

Advanced Space

Communication Protocol: SMB or WebDAV
Supported Client: PC: Windows* 8.1/10
Concurrent Connections (Max.): SMB:64, WebDAV:3

Advanced Space available disc space

Approx. 16GB

Advanced Space Features

Authentication for Advanced Space Log-in, Sort Function, Printing a PDF File with a Password, imageWARE Secure Audit Manager Support, Search, File Preview, Authentication Management, Open to public, URI TX, Backup/Restore

SECURITY SPECIFICATIONS

Authentication and Access Control

User Authentication (Picture Login, Picture and PIN Login, Card Login, Username and Password Login, Function Level Login, Mobile Login), Department ID Authentication (Department ID and PIN Login, Function Level Login), uniFLOW Online* (PIN Login, Picture Login, Picture and PIN Login, Card Login, Card and PIN Login, Username and Password Login, Department ID and PIN Login, Function Level Login), Access Management System (Access Control), Cloud Connector* (PIN Login), Microsoft Entra ID (PIN Login, Card Login), Two-Factor Authentication at LUI/RUI
*Subscription required

Document Security

Print Security (Secure Print, Encrypted Secure Print, Forced Hold Printing, uniFLOW Secure Print*), Receive Data Security (Confidential Fax Inbox Forwarding Received Documents Automatically), Scan Security (Encrypted PDF, Device Signature PDF/XPS, User Signature PDF/XPS, Adobe LiveCycle* Rights Management ES2.5 Integration), BOX Security (Mail Box Password Protected, Advanced Space Access Control), Send Data Security (Setting for requesting password input per transmission, Restricted E-mail/File send functions, Confirming FAX number, Allow/Restrict Fax Driver Transmissions, Allow/Restrict Sending from History, S/MIME Support), Document Tracking (Secure Watermark)
* Requires uniFLOW Online / uniFLOW

Network Security

TLS 1.3, FTPS, IPsec, IEEE802.1X authentication, WPA3 support (Wi-Fi), SNMP V3.0, Firewall Functionality (IP/MAC Address Filtering), Dual Network Support (Wired LAN/Wireless LAN, Wired LAN/Wired LAN), Disabling Unused Functions (Enabling/Disabling Protocols/Applications, Enabling/Disabling Remote UI, Enabling/Disabling USB Interface), G3 FAX separation from LAN, USB Port separation from LAN, Prohibit the execution of files stored in Advanced Space in the MFP, Scan and Send -Virus Concerns for E-mail Reception

Device Security

Protecting SSD Data [SSD Data Encryption (FIPS 140-3), SSD Lock], Standard SSD Initialize, Initialize (NIST 800-88 PURGE LEVEL), Trusted Platform Module (TPM 2.0), Job Log Conceal Function, Protecting MFD Software Integrity, Checking MFD Software Integrity & Platform Firmware Resiliency (NIST SP800-193) with Automatic System Recovery (Verify System at Startup, Runtime Intrusion Detection), Comply IEEE2600.2 (Common Criteria Certification)

Device Management and Auditing

Administrator Password, Digital Certificate And Key Management, Remote Management Two-Factor Authentication, Audit Log, Cooperating with External Security Audit System (Security Information and Event Management), Image Data Logging, Security Policy Setting Device administration and Security administration Passwords

ENVIRONMENTAL SPECIFICATIONS

Operating Environment

Temperature: 10 to 30 °C
Humidity: 20 to 80 % RH (Relative Humidity)

Power source

220-240 V, 50/60 Hz, 3.9 A

Power consumption

Maximum: Approx. 1,500 W
Copying (iR-ADV DX C359i/C259i with DADF continuous scan): 575.4 W^{*1}

Printing (iR-ADV DX C359P) [LAN Print (color mode, duplex, with Cassette Feeding unit-AK1)]: 488.5 W^{*1}
Standby: Approx. 40.3 W^{*1}
Sleep mode: Approx. 0.8 W^{*2}

^{*1} Reference value; measured one unit

^{*2} 0.8 W sleep mode is not available in all circumstances due to certain settings.

Typical Electricity Consumption (TEC):
iR-ADV DX C359i/C359P: 0.33kWh
iR-ADV C259i: 0.22kWh

^{*As per USA Energy Star 3.0}

For detailed information relating to Erp:Lot6/26

regulation, please go to:

https://www.canon-europe.com/for_work/lot26/

Sound Power Level (LWA, m*)

Active (BW) (1-sided):
iR-ADV DX C359i/C359P: 65 dB, Kv 3 dB
iR-ADV DX C259i: 62 dB, Kv 3 dB

^{*Reference value; measured only one unit with ISO7779, described with ISO9296 (2017)}

Sound Pressure (LpAm)

Bystander's position:

Active (BW) (1-sided):
iR-ADV DX C359i/C359P: 52 dB*
iR-ADV DX C259i: 49 dB*

Standby:
iR-ADV DX C359i/C359P/C259i: 8 dB

^{*Reference value; measured only one unit with ISO7779, described with ISO9296 (2017)}

Blue Angel

Noise levels

Standards

CONSUMABLES

Toner Cartridges

Toner (Estimated Yield @ 5% Coverage)

C-EXV 55 Toner BK/C/M/Y

C-EXV 55 TONER BK: 23,000 pages

C-EXV 55 TONER C/M/Y: 18,000 pages

SOFTWARE AND PRINTER MANAGEMENT

Tracking and reporting

For detailed information please visit our website

<https://www.canon-europe.com/business/>

Universal Login Manager (ULM)

^{*For more information, please refer to}

[uniFLOW Online](#)

Remote management tools

iW Management Console

eMaintenance

Content Delivery System

Scanning software

Network ScanGear

Platform

MEAP (Multifunctional Embedded Application Platform)

Document Publishing

Kofax PowerPDF (optional)

PAPER SUPPLY OPTIONS

Cassette Module-AE1

Paper Capacity: 550 sheets (80 gsm)
Paper Type: Thin, Plain, Heavy, Recycled, Color, Pre-punched, Bond
Paper Size: A4, A5R, B5,
Custom size: 98.0 x 190.5 mm to 216.0 x 355.6 mm
Paper Weight: 60 to 163 gsm
Power Source: From the Main Unit
Dimensions (W x D x H): 511 x 508 x 159 mm
(attached to the main unit)
Weight: Approx. 10 kg

TECHNICAL SPECIFICATIONS

imageRUNNER ADVANCE DX C259/C359 Series

Cassette Feeding Unit-AJ1	Paper Capacity: 550 sheets (80 gsm) Paper Type: Thin, Plain, Recycled, Heavy, Color, Pre-punched, Bond Paper Size: A4, A5R, B5 Custom size: 98.0 x 190.5 mm to 216.0 to 355.6 mm Paper Weight: 60 to 163 gsm Power Source: From the Main Unit Dimensions (W x D x H): 511 x 508 x 425 mm (attached to the main unit) Weight: Approx. 16 kg
Cassette Feeding Unit-AK1	Paper Capacity: 550 sheets (80 gsm) x 3 cassettes Paper Type: Thin, Plain, Recycled, Heavy, Color, Pre-punched, Bond Paper Size: A4, A5R, B5 Custom size: 98.0 x 190.5 mm to 216.0 to 355.6 mm Paper Weight: 60 to 163 gsm Power Source: From the Main Unit Dimensions (W x D x H): 511 x 508 x 425 mm (attached to the main unit) Weight: Approx. 19 kg <small>*Paper capacity may vary with different paper type/size.</small>
OUTPUT OPTIONS*	
Staple Finisher-Z1	Tray Capacity (80 gsm): A4, A5, A5R, A6, B5: 500 sheets Paper Weight: 60 to 220 gsm Staple Position: Corner Staple Capacity: A4, B5: 30 sheets (60 to 105 gsm) Power Source: From the Main Unit Dimensions (W x D x H): 555 x 459 x 301 mm (Unit size) Weight: Approx. 14 kg
HARDWARE ACCESSORIES	
Card Readers	Various card readers available e.g. MiCard Plus. Please contact local Canon Office for more details. Copy Card Reader-F1 Copy Card Reader Attachment-B5
SYSTEM AND CONTROLLER OPTIONS	
Print Accessories	PCL International Font Set-A1
Barcode Printing	Barcode Printing Kit-D1
System Accessories	Copy Control Interface Kit-A1 Wireless LAN Board-D1 Serial Interface Kit-K3
FAX Accessories	Super G3 FAX Board-BL1 Remote Fax Kit-A1 IP FAX Expansion Kit-B1
OTHER OPTIONS	
Accessibility Accessories	ADF Access Handle-A1
Consumables	Staple-P1

Software & Solutions



Certifications and compatibility



Canon Inc.
canon.com
Canon Europe
canon-europe.com
English edition
© Canon Europa N.V., 2024