

imageRUNNER ADVANCE DX 6800 Series

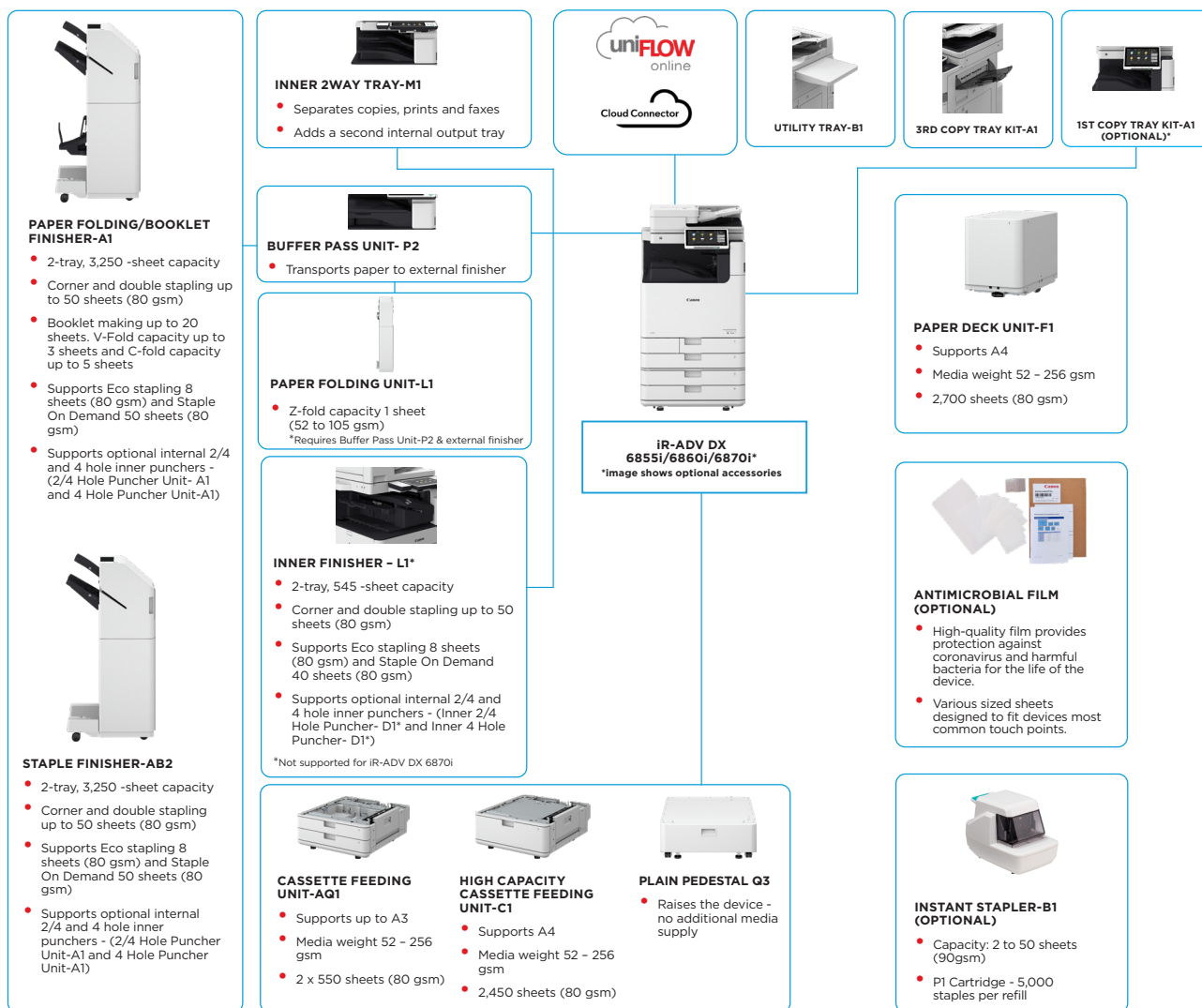

SECURE, SUSTAINABLE A3 MONO MULTIFUNCTION DEVICES WITH INTEGRATED CLOUD-BASED SOFTWARE TO EXPEDITE PRINTING AND DOCUMENT DIGITISATION

MAIN CONFIGURATION OPTIONS



This flat configuration is for illustration purpose only. For a complete list of options and the exact compatibility relationships, please refer to the online [product configurator](#).

The Unified Firmware Platform (UFP) ensures that the latest feature upgrades and protection are available, for an enhanced user experience across the entire iR ADVANCE DX portfolio.

*To support sustainability and save on raw materials required for plastics, 1st Copy Tray Kit-A1 is optional.

TECHNICAL SPECIFICATIONS

imageRUNNER ADVANCE DX 6800 Series

MAIN UNIT

Machine type	A3 Monochrome Laser Multifunctional
Core functions	Print, Copy, Scan, Send, Store and Optional Fax
Processor	1.8GHz Dual Core Processor
Control Panel	10.1" TFT LCD WSVGA Color Touch panel
Memory	Standard: RAM 6GB
Storage	Standard: (SSD) 256GB, Optional: (SSD) 1TB
Interface Connection	NETWORK Standard: 1000Base-T/100Base-TX/10Base-T, Wireless LAN (IEEE 802.11 b/g/n); Optional: Bluetooth Low Energy OTHERS Standard: USB 2.0 (Host) x1, USB 3.0 (Host) x1, USB 2.0 (Device) x1; Optional: Serial Interface, Copy Control Interface
Paper Supply Capacity (A4, 80gsm)	Standard: 1200 sheets 100-sheet Multi-purpose tray x 1 550-sheet Paper cassettes x 2 Maximum: 6,350 sheets (with High Capacity Cassette Feeding Unit-C1 + Paper Deck Unit-F1)
Paper output capacity (A4, 80gsm)	Maximum: 3,450 Sheets (with Staple Finisher-AB2 or Paper Folding/Booklet Finisher- A1 and 3rd Copy Tray Kit-A1)
Finishing capabilities	Collate, Group, Offset, Staple, Saddle Stitch, Hole Punch, Eco Staple, Staple On Demand, V-fold, C-fold, Z-fold * Finishing capabilities vary depending on the options connected.
Supported Media Types	Multi-purpose tray: Thin, Plain, Recycled, Color, Heavy, Coated, Tracing, Bond, Transparency, Label, Pre-punched, Letterhead, Tab, Envelope Paper Cassette (Upper/Lower): Thin, Plain, Recycled, Color, Heavy, Bond, Transparency, Pre-punched, Letterhead, Envelope* * Envelope Feeder Attachment (standard) is required.
Supported Media Sizes	Multi-purpose tray: Standard size: SRA3, A3, A4, A4R, A5, A5R, A6R, B4, B5, B5R Custom size: 98.0 x 139.7 mm to 320.0 x 457.2 mm Free Size: 98.0 x 139.7 mm to 320.0 x 457.2 mm Envelopes: COM10 No.10, Monarch, DL, ISO-C5 Envelope custom size: 98.0 x 90.0 mm to 320.0 x 457.2 mm Upper Cassette: Standard size: A4, A5, A5R, A6R, B5 Custom Size: 98.0 x 148.0 mm to 297.0 x 215.9 mm Envelopes: COM10 No.10, Monarch, DL, ISO-C5 Lower Cassette: Standard size: A3, A4, A4R, A5, A5R, A6R, B4, B5, B5R Custom size: 98.0 x 148.0 mm to 304.8 x 457.2 mm Envelopes: COM10 No.10, Monarch, DL, ISO-C5
Supported media weights	Multi-purpose tray: 52 to 300 gsm Paper Cassettes (Upper/Lower): 52 to 256 gsm Duplex: 52 to 256 gsm
Warm-up Time	Quick Startup Mode: 4 Seconds or less* * Time from device power-on to when the copy icon appears and is enabled to operate on the touch panel display. From Sleep Mode: 7 seconds or less (iR-ADV DX 6870i) 6 seconds or less (iR-ADV DX 6860i/iR-ADV DX 6855i) From Power On: 6 Seconds or less* * Time from device power-on, until copy ready (not print reservation).
Dimensions (W x D x H)	620 x 722 x 937 mm
Installation Space (W x D)	Basic: 1,138 x 1,162 mm (Right Cover Open with Multi-purpose tray extended + Cassette Drawers Open) Fully Configured: 1,866 x 1,162 mm (Staple Finisher-AB2/ Paper Folding/Booklet Finisher-A1 with the extension tray extended + Paper Deck Unit-F1 + Cassette Drawers open)
Weight* * including regular toner	iR-ADV DX 6870i: Approx. 93 kg iR-ADV DX 6860i: Approx. 91 kg iR-ADV DX 6855i: Approx. 91 kg
PRINT SPECIFICATIONS	
Print Speed (BW)	iR-ADV DX 6870i up to 70 ppm (A4, A5*, A5R, A6R*), up to 36 ppm (A3), up to 42 ppm (A4R) iR-ADV DX 6860i up to 60 ppm (A4, A5*, A5R, A6R*), up to 32 ppm (A3), up to 36 ppm (A4R) iR-ADV DX 6855i up to 55 ppm (A4, A5*, A5R, A6R*), up to 29 ppm (A3), up to 36 ppm (A4R) * 1-sided only
Print Resolution (dpi)	1,200 x 1,200
Page description languages	Standard: UFR II, PCL6 Optional: Adobe® PostScript®3™
Direct Print	Supported file types: PDF, EPS, TIFF/JPEG, and XPS
Printing from mobile and cloud	AirPrint, Mopria, Universal Print by Microsoft, Canon PRINT App, and uniFLOW Online (optional) A range of software and MEAP-based solutions are available to provide printing from mobile devices or internet-connected devices and cloud-based services depending on your requirements. Please contact your sales representative for further information.
OS Standard Printing	Android/Windows® 10/Windows® 11/Chrome OS/macOS (11.2.2 or later)/iOS (15.2 or later)/iPadOS

Fonts

PS fonts: 136 Roman
PCL fonts: 93 Roman, 10 Bitmap fonts, 2 OCR fonts, Andale Mono WT J/k/S/T⁴
(Japanese, Korean, Simplified and Traditional Chinese), Barcode fonts²

¹ Optional PCL International Font Set-A1 is required.
² Optional Barcode Printing Kit-D1 is required.

Print Features

Secured Print, Secure Watermark, Header/Footer, Page Layout, Two-sided Printing, Mixed Paper Sizes/Orientations, Front/Back Covers, Toner Reduction, Poster Printing, Forced Hold printing, Print Date, Scheduled Printing, Printing Using a Virtual Printer

Operating System

UFR II: Windows® 8.1/10/11/Server2012/Server2012 R2/Server2016/Server2019/Server2022, Mac OS X (10.11 or later)
PCL: Windows® 8.1/10/11/Server2012/Server2012 R2/Server2016/Server2019/Server2022
PS: Windows® 8.1/10/11/Server2012/Server2012 R2/Server2016/Server2019/Server2022, Mac OS X (10.11 or later)
PPD: Windows® 8.1/10/11, Mac OS X(10.11 or later)
As of Jan. 2022

COPY SPECIFICATIONS

Copy Speed (BW)

iR-ADV DX 6870i
up to 70 ppm (A4, A5*, A5R, A6R*), up to 36 ppm (A3), up to 42 ppm (A4R)
iR-ADV DX 6860i
up to 60 ppm (A4, A5*, A5R, A6R*), up to 32 ppm (A3), up to 36 ppm (A4R)
iR-ADV DX 6855i
up to 55 ppm (A4, A5*, A5R, A6R*), up to 29 ppm (A3), up to 36 ppm (A4R)
* 1-sided only

First-Copy-Out Time (A4, BW)

iR-ADV DX 6870i: Approx. 2.7 seconds or less
iR-ADV DX 6860i: Approx. 2.9 seconds or less
iR-ADV DX 6855i: Approx. 2.9 seconds or less

Copy resolution (dpi)

600 x 600

Multiple Copies

Up to 9,999 copies

Copy Density

Automatic or Manual (9 Levels)

Magnification

Variable zoom: 25% to 400% (1% Increments)
Preset reduction/enlargement: 25%, 50%, 70%, 100%(1:1), 141%, 200%, 400%

Copy Features

Preset R/E Ratios by Area, Two-Sided, Density Adjustment, Original Type Selection, Interrupt Mode, Book to Two Pages, Two-sided Original, Job Build, N on 1, Add Cover, Insert Sheets, Different Size Originals, Page Numbering, Copy Set Numbering, Sharpness, Erase Frame, Secure Watermark, Print Date, Gutter, Print & Check, Negative/Positive, Repeat Images, Merge Job Blocks, Mirror Image, Store in Mail Box, Superimpose Image, Copy ID Card, Skip Blank Pages, Free Size Original, Reserved copy, Copy Sample

SCAN SPECIFICATION

Type

Single-pass Duplexing Automatic Document Feeder*
[2-sided to 2-sided (Automatic)]
* Detect Feeder Multi Sheet Feed is supported.
up to 200 Sheets

Document Feeder Paper Capacity (80 gsm)

Platen: Sheet, Book, and 3-Dimensional Objects
Document Feeder media weight:
1-sided scanning: 38 to 220 gsm
2-sided scanning: 38 to 220 gsm
* An acceptable weights of A6R or smaller is 50 to 220gsm.

Supported media sizes

Platen scanning size: up to 297.0 x 431.8 mm
Document Feeder media size:
A3, A4, A4R, A5, A5R, A6R, B4, B5, B5R, B6R
Custom size: 70.0 x 139.7 mm to 304.8 x 431.8 mm

Scan Speed (ipm: BW/CL; A4)

1-sided Scanning: 135/135 (300 x 300 dpi, send), 80/80 (600 x 600 dpi, copy)
2-sided Scanning: 270/270 (300 x 300 dpi, send), 160/90 (600 x 600 dpi, copy)

Scan Resolution (dpi)

Scan for Copy: 600 x 600
Scan for Send: (Push) 600 x 600 (SMB/FTP/WebDAV/IFAX), (Pull) 600 x 600
Scan for Fax: 600 x 600

Pull Scan Specifications

Color Network ScanGear2. For both TWAIN and WIA
Supported OS: Windows® 8.1/10/11/Server2012/Server2012 R2/Server 2016/Server 2019/Server 2022
As of Nov. 2021

Scan Method

Push Scan, Pull Scan, Scan to Box, Scan to Advanced Space, Scan to Network, Scan to USB Memory Key, Scan to Mobile devices, Scan to cloud (uniFLOW Online, Cloud Connector - Optional)

SEND SPECIFICATIONS

Destination

Standard: E-mail/Internet FAX (SMTP*), SMB3.0, FTP, FTPS WebDAV, Mail Box

* OAuth 2.0 authentication method available for Microsoft 365 and Google Workspace.
Optional: Super G3 FAX, IP Fax

Address Book

LDAP (2,000)/Local (1,600)/Speed dial (200)

Send resolution (dpi)

Push: up to 600 x 600
Pull: up to 600 x 600

Communication protocol

File: FTP(TCP/IP), SMB3.0 (TCP/IP), WebDAV
E-mail/I-Fax: SMTP, POP3



TECHNICAL SPECIFICATIONS

imageRUNNER ADVANCE DX 6800 Series

File Format	TIFF, JPEG, PDF(Compact, Searchable, Apply policy, Optimize for Web, PDF/A-1b, Trace & Smooth, Encrypted, Device Signature, User Signature), XPS(Compact, Searchable, Device Signature, User Signature), Office Open XML (PowerPoint, Word)	Device Security	Protecting SSD Data [SSD Data Encryption (FIPS 140-3 Validated), SSD Lock], Standard SSD Initialize, Initialize (NIST 800-88 PURGE LEVEL), Trusted Platform Module (TPM 2.0), Job Log Conceal Function, Protecting MFD Software Integrity, Checking MFD Software Integrity (Verify System at Startup, Runtime Intrusion Detection enabled with Trellix Embedded Control), HCD-PP Common Criteria Certification
Universal Send Features	Original Type Selection, Two-sided Original, Book to Two Pages, Different-size Originals, Density Adjustment, Sharpness, Copy Ratio, Erase Frame, Job Build, Delayed Send, Preview, Job Done Notice, File Name, Subject/Message, Reply-to, E-mail Priority, TX Report, Original Content Orientation, Skip Blank Pages	Device Management and Auditing	Administrator Password, Digital Certificate And Key Management, Audit Log, Cooperating with External Security Audit System (Security Information and Event Management), Image Data Logging, Security Policy Setting
FAX SPECIFICATIONS		ENVIRONMENTAL SPECIFICATIONS	
Maximum Number of Connection Lines	1	Operating Environment	Temperature: 10 to 30 °C Humidity: 20 to 80 % RH (Relative Humidity)
Modem Speed	Super G3: 33.6 kbps G3: 14.4 kbps	Power source	220-240 V, 50/60 Hz, 6 A
Compression Method	MH, MR, MMR, JBIG	Power consumption	Maximum: iR-ADV DX 6870i: Approx. 2,000 W iR-ADV DX 6860i: Approx. 1,800 W iR-ADV DX 6855i: Approx. 1,800 W Copying (with DADF continuous scan): Approx. 858 W ^{*1} Standby: Approx. 50.7 W ^{*1} Sleep mode: Approx. 0.8 W ^{*2}
Resolution (dpi)	400 x 400 (Ultra Fine), 200 x 400 (Super Fine), 200 x 200 (Fine), 200 x 100 (Normal)		^{*1} Reference value: measured one unit ^{*2} 0.8 W is not available in all circumstances due to certain settings.
Sending/Receiving Size	Sending: A3, A4, A4R, A5 ¹ , A5R ¹ , B4, B5 ^{*2} , B5R ^{*1} Receiving: A3, B4, A4, A4R, A5R, B5, B5R ¹ Sent as A4 ² Sent as B4 short		Typical Electricity Consumption (TEC): iR-ADV DX 6870i: 0.85 kWh iR-ADV DX 6860i: 0.71 kWh iR-ADV DX 6855i: 0.67 kWh ^{* As per USA Energy Star 3.0}
FAX memory	Up to 30,000 pages (2,000 jobs)	Noise levels (BW)	Sound Power Level (LWA_m) Active (1-sided) iR-ADV DX 6870i: 6.6 B*, Kv 0.3 B* iR-ADV DX 6860i: 6.4 B*, Kv 0.3 B* iR-ADV DX 6855i: 6.4 B*, Kv 0.3 B* ^{* Reference value: measured only one unit with ISO7779, described with ISO9296 (2017)}
Speed dials	Max. 200		Sound Pressure (LpA_m) Bystander's position: Active (1-sided): 52 dB* (iR-ADV DX 6870i), 51 dB* (iR-ADV DX 6860i) 50 dB* (iR-ADV DX 6855i) Stand-by: 25 dB* ^{* Reference value: measured only one unit with ISO7779, described with ISO9296 (2017)}
Group dials/destinations	Max. 199 dials	Standards	Blue Angel
Sequential broadcast	Max. 256 addresses	CONSUMABLES	
Memory backup	Yes	Toner Cartridges	C-EXV 61 Toner BK
Fax Features	Sender's Name (TTI), Selecting the Telephone Line (when sending fax), Direct Send, Delayed Send, Preview, Job Done Notice, TX Report, Interrupt Transmission, Sequential Broadcasting, Password/Subaddress Sending, Confidential Mailbox, 2 on 1 Log	Toner Yield (Estimated Yield @6% coverage)	C-EXV 61 Toner BK: 71,500 pages
STORE SPECIFICATIONS		SOFTWARE AND PRINTER MANAGEMENT	
Mail Box (Number supported)	100 User Inboxes, 1 Memory RX Inbox, 50 Confidential Fax Inboxes Maximum 30,000 Pages (2,000 jobs) Stored	Tracking and reporting	Universal Login Manager (ULM) ^{* For more information, please refer to uniFLOW Online}
Advanced Space	Communication Protocol: SMB or WebDAV Supported Client PC: Windows® 8.1/10 Concurrent Connections (Max.): SMB:64, WebDAV:3	Remote management tools	iWEMC eMaintenance Content Delivery System
Advanced Space available disc space	Standard:16 GB (With option: max. 480GB)	Scanning software	Network ScanGear
Advanced Space Features	Authentication for Advanced Space Log-in, Sort Function, Printing a PDF File with a Password, imageWARE Secure Audit Manager Support, Search, File Preview, Authentication Management, Open to public, URI TX, Backup/Restore	Optimisation tools	Canon Driver Configuration Tool
SECURITY SPECIFICATIONS		Platform	MEAP (Multifunctional Embedded Application Platform)
Authentication and Access Control	User Authentication (Picture Login, Picture and PIN Login, Card Login [*] , Username and Password Login, Function Level Login, Mobile Login), Department ID Authentication (Department ID and PIN Login, Function Level Login), uniFLOW Online ^{**} (PIN Login, Picture Login, Picture and PIN Login, Card Login, Card and PIN Login, Username and Password Login, Department ID and PIN Login, Function Level Login), Access Management System (Access Control), Cloud Connector ^{**} (PIN Login), Microsoft Entra ID (PIN Login, Card Login), Two-Factor Authentication at LUI/RUI ^{*Card readers are optional, please refer to Hardware Accessories} ^{**Subscription required}	Document Publishing	Kofax PowerPDF Advanced (Optional)
Document Security	Print Security (Secure Print, Encrypted Secure Print, Forced Hold Printing, uniFLOW Secure Print ¹), Receive Data Security (Confidential Fax Inbox Forwarding Received Documents Automatically), Scan Security (Encrypted PDF, Device Signature PDF/XPS, User Signature PDF/XPS, Adobe LiveCycle® Rights Management ES2.5 Integration), BOX Security (Mail Box Password Protected, Advanced Space Access Control), Send Data Security (Setting for requesting password input per transmission, Restricted E-mail/File send functions, Confirming FAX number, Allow/Restrict Fax Driver Transmissions, Allow/Restrict Sending from History, S/MIME Support), Document Tracking (Secure Watermark) ¹ Requires uniFLOW Online / uniFLOW	PAPER SUPPLY OPTIONS	
Network Security	TLS 1.3, IPsec, IEEE802.1X authentication, SNMP V3.0, Firewall Functionality (IP/MAC Address Filtering), WPA3 support (Wi-Fi), Dual Network Support (Wired LAN/Wireless LAN, Wired LAN/Wired LAN), Disabling Unused Functions (Enabling/Disabling Protocols/Applications, Enabling/Disabling Remote UI, Enabling/Disabling USB Interface), G3 FAX separation from LAN, USB Port separation from LAN, Prohibit the execution of files stored in Advanced Box in the MFP, Scan and Send -Virus Concerns for E-mail Reception	Cassette Feeding Unit-AQ1	Paper Capacity: 2 x 550 sheets (80 gsm) Paper Type: Thin, Plain, Recycled, Color, Heavy, Bond, Transparency, Pre-punched, Letterhead Paper Size: A3, A4, A4R, A5, A5R, A6R, B4, B5, B5R Custom size: 98.0 x 148.0 mm to 304.8 x 457.2 mm Paper Weight: 52 to 256 gsm Dimensions (W x D x H): 620 x 660 x 251 mm (attached to the main unit) Weight: Approx. 22 kg
		High Capacity Cassette Feeding Unit-C1	Paper Capacity: 2,450 sheets (80 gsm) Paper Type: Thin, Plain, Recycled, Color, Heavy, Bond, Pre-punched, Letterhead Paper Size: A4 Paper Weight: 52 to 256 gsm Dimensions (W x D x H): 620 x 660 x 251 mm (attached to the main unit) Weight: Approx. 29 kg
		Paper Deck Unit-F1	Paper Capacity: 2,700 sheets (80 gsm) Paper Type: Thin, Plain, Color, Recycled, Heavy, Pre-punched Paper Size: A4, B5 Paper Weight: 52 to 256 gsm Dimensions (W x D x H): 344 x 630 x 440 mm (attached to the main unit) Weight: Approx. 31 kg
		OUTPUT OPTIONS*	^{* Paper capacity may vary with different paper type/size.}

TECHNICAL SPECIFICATIONS

imageRUNNER ADVANCE DX 6800 Series

1st Copy Tray Kit-A1	Capacity (with 80gsm paper): A4, A5, A5R, A6R, B5: 250 sheets SRA3, A3, A4R, B4, B5R: 100 sheets Paper Weight: 52 to 300 gsm Dimensions (W x D x H): 454 x 493 x 114 mm Weight: 1.2 kg	Paper Folding Unit-L1	(Requires Buffer Pass Unit-P2 & external finisher) Paper size: A3, A4, B4 Z-fold Capacity: 1 sheet (52 to 105 gsm) Dimensions (W x D x H): 201 x 579 x 896 mm Weight: Approx. 12 kg
Inner 2way Tray-M1	Tray Capacity (with 80 gsm paper) Upper tray: A4, A5, A5R, A6R, B5: 100 sheets SRA3, A3, A4R, B4, B5R: 50 sheets Lower tray (1st Copy Tray Kit-A1): A4, A5, A5R, A6R, B5: 250 sheets SRA3, A3, A4R, B4, B5R: 100 sheets Paper Weight: 52 to 300 gsm Dimensions (W x D x H): 428 x 405 x 88 mm Weight: Approx. 0.7 kg	Inner 2/4 Hole Puncher-D1 (Not supported for IR-ADV DX 6870)	(Requires the Inner Finisher-L1) Two or Four Holes Acceptable Punch Paper Weight: 52 to 300 gsm Acceptable Punch Paper Size: Two holes: A3, A4, A4R, A5, B4, B5, B5R Four holes: A3, A4
3rd Copy Tray Kit-A1	Capacity (with 80gsm paper): A4, A5R, B5: 100 sheets A3, A4R, B4, B5R: 75 sheets Dimensions (W x D x H): 442 x 373 x 176 mm (attached to the main unit, when the extension tray is extended) Weight: 0.5 kg	Inner 4 Hole Puncher-D1 (Not supported for IR-ADV DX 6870)	(Requires the Inner Finisher-L1) Four Holes Acceptable Punch Paper Weight: 52 to 300 gsm Acceptable Punch Paper Size: Four holes: A3, A4, A4R, A5, B4, B5, B5R (Requires either the Staple Finisher-AB2 or Paper Folding/Booklet Finisher-A1) Two or Four Holes Acceptable Punch Paper Weight: 52 to 300 gsm Acceptable Punch Paper Size: Two holes: A3, A4, A4R, A5, B4, B5, B5R Four holes: A3, A4
Inner Finisher-L1 (Not supported for IR-ADV DX 6870)	Tray Capacity (with 80gsm paper): Upper Tray: SRA3, A3, A4, A4R, A5, A5R, A6R, B4, B5, B5R: approx. 45 sheets Lower Tray: A4, A5, A5R, B5: approx. 500 sheets, SRA3, A3, A4R, B4, B5R: 250 sheets, A6R: 30 sheets Envelope: 10 sheets Paper Weight: 52 to 300 gsm Staple Position: Corner, Double Staple Capacity: (52 to 90 gsm paper) A4, B5: 50 sheets A4R: 40 sheets A3, B4: 30 sheets Eco Staple: A3, A4, B4, B5: 10 sheets (52 to 64 gsm) 8 sheets (65 to 81.4 gsm) 6 sheets (82 to 105 gsm) Staple On Demand: 40 sheets (80 gsm) Dimensions (W x D x H): 743 x 525 x 225 mm (attached to the main unit, when the extension tray is extended) Weight: Approx. 9.1 kg	2/4 Hole Puncher Unit-A1	(Requires either the Staple Finisher-AB2 or Paper Folding/Booklet Finisher-A1) Four Holes Acceptable Punch Paper Weight: 52 to 300 gsm Acceptable Punch Paper Size: Four holes: A3, A4, A4R, A5, B4, B5, B5R
Staple Finisher-AB2	(Requires Buffer Pass Unit-P2) Tray Capacity (with 80gsm paper): Upper Tray: A4, A5, A5R, A6R, B5: approx. 250 sheets, SRA3, A3, A4R, B4, B5R: approx. 125 sheets Lower Tray: A4, A5, A5R, B5: 3,000 sheets SRA3, A3, A4R, B4, B5R: 1,500 sheets, A6R: 250 sheets Envelopes: Monarch: 30 sheets, COM10 No.10, DL, ISO-C5: 100 sheets Paper Weight: Upper Tray 52 to 256 gsm, Lower Tray 52 to 300 gsm Staple Position: Corner, Double Staple Capacity: (52 to 90 gsm) A4, B5: 50 sheets A4R: 40 sheets A3, B4: 30 sheets Eco Staple: A3, A4: 10 sheets (52 to 64 gsm) 8 sheets (65 to 81.4 gsm) 6 sheets (82 to 105 gsm) Staple On Demand: 50 sheets (52 to 90 gsm) Dimensions (W x D x H): 637 x 623 x 1,142 mm (when the extension tray is extended) Weight: Approx. 31 kg	4 Hole Puncher Unit-A1	(Requires either the Staple Finisher-AB2 or Paper Folding/Booklet Finisher-A1) Four Holes Acceptable Punch Paper Weight: 52 to 300 gsm Acceptable Punch Paper Size: Four holes: A3, A4, A4R, A5, B4, B5, B5R
Paper Folding/Booklet Finisher-A1	(Requires Buffer Pass Unit-P2) (Includes the above Staple Finisher-AB2 basic staple specifications.) Saddle Stitch paper size: A3, A4R, B4 Saddle Stitch Staple Capacity: 20 sheets x 10 sets (52 to 81.4 gsm) (including 1 cover sheet 52 to 105 gsm) V-fold Capacity: up to 3 sheets (52 to 105 gsm) C-fold Capacity: up to 5 sheets (52 to 128 gsm) Dimensions (W x D x H): 637 x 623 x 1,142 mm (when the extension tray is extended) Weight: Approx. 57 kg	HARDWARE ACCESSORIES	Card Readers Various card readers available e.g. MiCard Plus. Please contact local Canon Office for more details Copy Card Reader-F1 IC Card Reader Box for Numeric Keypad-A1
		Others	Printer Cover-M2 Tab Feeding Attachment-F1 Buffer Pass Unit-P2 Utility Tray-B1 Numeric Keypad-A2 Instant Stapler-B1 (optional)
		SECURITY OPTIONS	
		Data Security	250GB SSD-A1 (usage with Memory Mirroring Kit-A1) 1TB SSD-A1 Memory Mirroring Kit-A1
		SYSTEM AND CONTROLLER OPTIONS	
		Print Accessories	PCL International Font Set-A1 PS Printer Kit-BC1
		Barcode Printing	Barcode Printing Kit-D1
		System Accessories	Copy Control Interface Kit-A1 Serial Interface Kit-K3 Connection Kit-A3 for Bluetooth LE
		Fax Accessories	Super G3 FAX Board-AX1 Remote Fax Kit-A1 IP FAX Expansion Kit-B1
		OTHER OPTIONS	
		Accessibility Accessories	ADF Access Handle-A1 Voice Guidance Kit-G1 Voice Operation Kit-D1
		Consumables	Staple-P1 (2 x 5,000pcs) Staple Cartridge-Y1 (2 x 2,000pcs)* * For Booklet Finisher only
		Device Protection	Antimicrobial Film* - Various Sheets designed to fit the devices most common touch points. *Application by a Service engineer is recommended

Software & Solutions



Certifications and compatibility



Canon Ireland
3006 Lake Drive
Citywest, Saggart
Co. Dublin, Ireland
Telephone No: 01 2052400
Facsimile No: 01 2052525
canon.ie

Canon (UK) Ltd
The Bower
4 Roundwood Avenue
Stockley Park
Uxbridge
Middlesex
UB11 1AF

Canon Inc.
canon.com
Canon Europe
canon-europe.com
English edition
© Canon Europa N.V., 2024