

# PRINT, SCAN & SEND

WITH CANON PRINT BUSINESS APP

HELPING TO MINIMISE TOUCH-POINTS



Easily **print, scan,** and **send** documents while minimising unnecessary touch-points **on the imageRUNNER ADVANCE devices.**

Available as a **free download!**

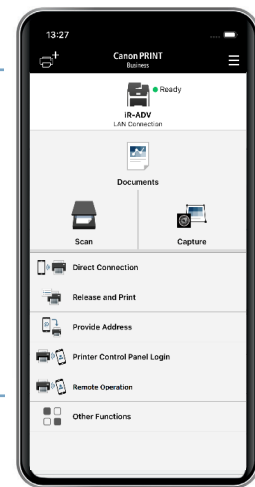

## Print with Canon PRINT Business App

Print documents saved in a cloud location or local to your mobile device

1

Select "Documents" in the application and choose the file location.

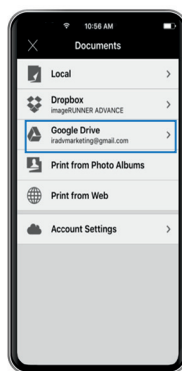

2

Choose the file you want to print.

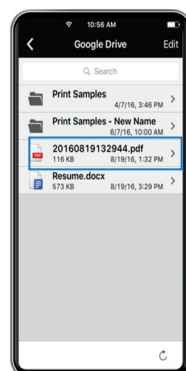

3

Preview the file and tap the printer icon.



4

Confirm your printer and select print/finishing settings. Tap "Print."



Note: Print/Finishing options available: Output Size, Copies, Print Range, Paper Source, Select Color Mode, Simplex or Duplex, Staple, and 2-on-1. Available print/finishing settings differ, depending on the device model. If you set functions not supported by the device you're using, the settings will not be applied.

## Scan with Canon PRINT Business

Scanning to your mobile device is easy

**1**

Add **document** to the imageRUNNER ADVANCE document feeder.



**2**

Tap **“Scan to Mobile”** on the imageRUNNER ADVANCE control panel or manage via the Remote Operation option on the app.



**3**

Select your **scan settings** in the Canon PRINT Business app.

[Supported file types: PDF, \* JPEG, TIFF, OOXML (pptx), OOXML (docx), XPS\*\*]



**4**

**Save** the scanned document to a local or cloud destination. Or, **send** it from your mobile device's email app.

SAVE



SEND



\* Compact, OCR, and Encryption can be set.  
\*\* Can only be set when using the “Scan and Send” function.

## Reduce physical interaction with the MFP using Canon PRINT Business

The ‘Remote Operation’ feature of the Canon PRINT Business app allows you to replicate the MFP UI on your mobile device. Allowing you to manage, change and customise your print job directly from your mobile.

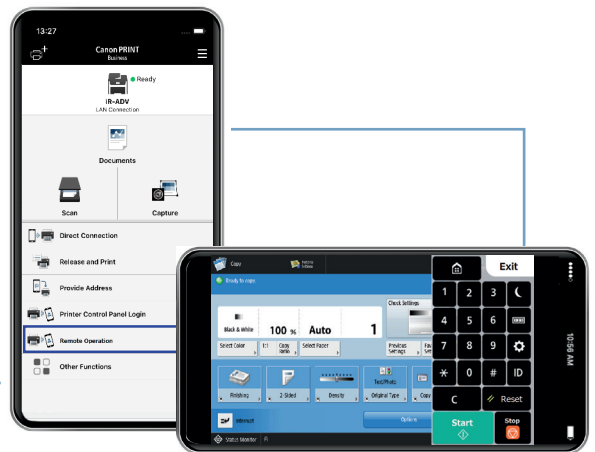

## Easier Sending from the MFP with Canon PRINT Business

The “Provide Address” feature of the Canon PRINT Business app allows you to use your mobile device to fill in send destinations (including using your mobile device contacts), subject name, message body, and file name fields on the imageRUNNER ADVANCE “Scan and Send” screen. This helps reduce touch-points at the control panel when sending documents to destinations from the imageRUNNER ADVANCE MFP.

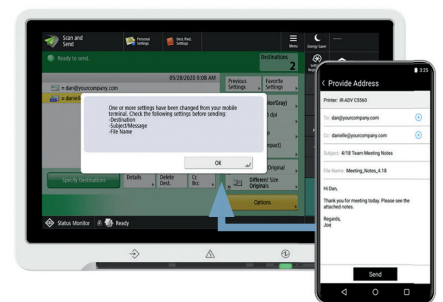

For more technical questions and information, please refer to the online manual for [iOS](#) and [Android](#).

Note: This document assumes the mobile device and MFP are on the same network.



See the bigger picture