

# SIMPLIFY HIGH-VOLUME PRINTING WITH SUSTAINABLE, VERSATILE AND SECURE BLACK AND WHITE MULTIFUNCTION DEVICES.

The imageFORCE 8100 Series is designed to help medium and large sized offices meet high-volume printing demand across various industries.

## imageFORCE 8100 Series



### MAXIMISE PRODUCTIVITY

Designed for high volume printing, the imageFORCE 8100 Series can help medium and large sized offices keep productivity and efficiency at high levels. Save time with a long machine life, long service parts life and 9,360-sheet capacity.

### HIGH QUALITY PRINTING

2,400dpi print quality, front to back registration, 300gsm support, media support including envelopes, coated and embossed paper, diverse professional finishing options.

### IMPROVE SUSTAINABILITY

Do your part to help the environment by using Blue Angel certified multifunction devices with 30% recycled plastic, helping to reduce the impact on the planet.

### PROTECT DEVICES

Secure your documents, devices and network with robust 360-degree security and machine learning AI recommended security settings.

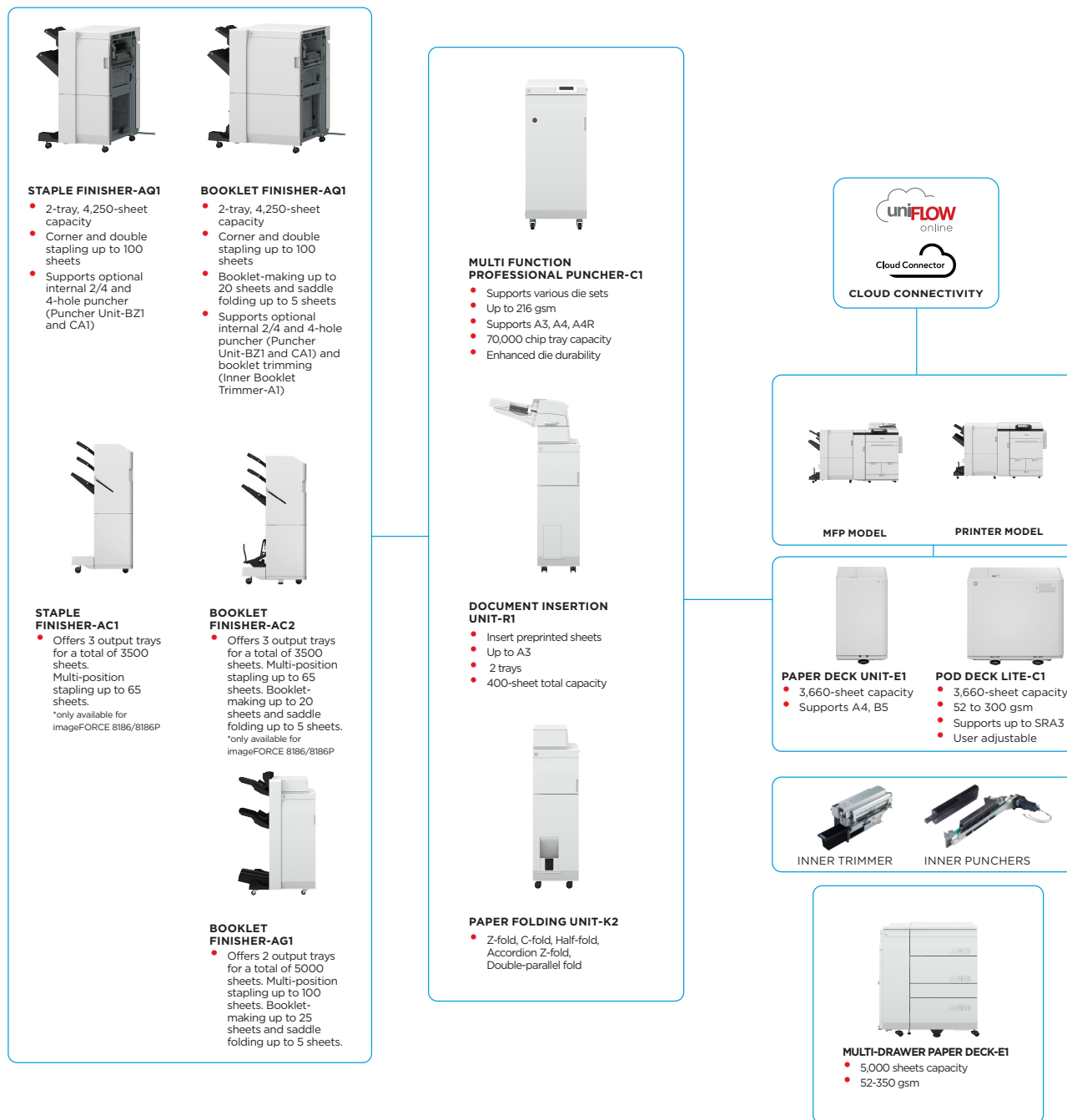

This flat configuration is for illustration purpose only. For a complete list of options and the exact compatibility relationships, please refer to the online [product configurator](#).

# TECHNICAL SPECIFICATIONS

# imageFORCE 8100 Series

MAIN UNIT	
Machine type	A3 Monochrome Laser Multifunctional
Core functions	Print, Copy*, Scan*, Send*, Store and Optional Fax* * Not available on imageFORCE 8105P/8195P/8186P
Processor	1.8GHz Dual Core Processor
Control Panel	10.1" TFT LCD WSVGA Color Touch panel
Memory	Standard: RAM: 6.5GB
Storage	Standard: (SSD) 512GB Optional: (SSD) 1TB
Interface Connection	NETWORK Standard: 1000Base-T/100Base-TX/10Base-T Optional: Wireless LAN (IEEE 802.11a/b/g/n/ac/ax) OTHERS Standard: USB 2.0 (Host) x 1, USB 3.0 (Host) x 1, USB 2.0 (Device) x 1 Optional: Serial Interface, Copy Control Interface
Paper Supply Capacity (A4, 80gsm)	Standard: 4,360 sheets 250 sheet Multi-purpose tray x 1 1,770 sheet Paper Deck x 2 570 sheet Paper Cassette x 1 Maximum: 9,360 sheets (with Multi-drawer Paper Deck-EI)
Paper output capacity (A4, 80gsm)	Standard: 250 Sheets Maximum: 5,000 Sheets (with Booklet Finisher-AG1)
Finishing capabilities*	Collate, Group, Offset, Staple, Saddle Stitch, Hole Punch, Eco Staple, Staple On Demand, Document Insertion, Z-fold, Half-fold, C-fold, Accordion-Z fold, Double Parallel-fold, Trimming * Finishing capabilities vary depending on the options connected.
Supported Media Types	Multi-purpose tray: Thin, Plain, Recycled, Color, Heavy, Coated, Bond, Transparency, Label, Pre-punched, Letterhead, Tab, Envelope, Film, Textured, Tracing
	Paper Decks (Right/Left): Thin, Plain, Recycled, Color, Heavy, Bond, Pre-punched, Letterhead
	Paper Cassette: Thin, Plain, Recycled, Color, Heavy, Bond, Transparency, Pre-punched, Letterhead, Tab*, Envelope* <sup>2</sup> *1 Tab Feeding Attachment-F1(standard) is required. *2 Envelope Feeder Attachment Kit (standard) is required.
Supported Media Sizes	Multi-purpose tray: Standard size: SRA3, A3, A4, A4R, A5, A5R, A6R, B4, B5, B5R Custom size: 90.0 x 148.0 mm to 330.2 x 487.7 mm Free size: 98.0 x 148.0 mm to 330.2 x 487.7 mm Envelopes: COM 10 No.10, Monarch, DL, ISO-C5 Envelope custom size: 90.0 x 148.0 mm to 330.2 x 487.7 mm

	Paper Decks (Right/Left): Standard size: A4, B5
	Paper Cassette: Standard size: SRA3, A3, A4, A4R, A5, A5R, A6R, B4, B5, B5R Custom size: 98.0 x 148.0 mm to 330.2 x 487.7 mm Envelopes: COM10 No.10, Monarch, ISO-C5, DL Envelope custom size: 90.0 x 148.0 mm to 330.2 x 487.7 mm * Envelope Feeder Attachment Kit (standard) is required.
Supported Media Weights	Multi-purpose tray: 52 to 300 gsm Paper Decks (Right/Left): 52 to 220 gsm Paper Cassette: 52 to 300 gsm Duplex: 52 to 300 gsm
Warm-up Time	Quick Startup Mode: 4 Seconds or less* * Time between power-on and appearance of the copy icon on the main menu.
	From Power On: 120 seconds or less* * Time from device power on, until copy ready (not print reservation)
	From Sleep Mode: 120 Seconds or less
Dimensions (W x D x H)	imageFORCE 8105/8195/8186 MFP Model: 964 x 868 x 1,185 mm imageFORCE 8105P/8195P/8186P Printer Model: 964 x 868 x 1,040 mm
Installation Space (W x D)	Basic: 1,762 x 1,409mm (with multi-purpose tray opened + paper cassette opened + Copy Tray)
	Fully Configured: 6,211 x 1,436 mm (Document Insertion Unit-R1 + Multi Function Professional Puncher-C1 + Paper Folding Unit-K2 + Booklet Finisher-AG1 front cover opened + Booklet Trimmer-G1 + Multi-drawer Paper Deck-EI)
Weight*	imageFORCE 8105/8195/8186 MFP Model: approx. 267 kg *including regular toner imageFORCE 8105P/8195P/8186P Printer Model: approx. 249 kg
PRINT SPECIFICATIONS	
Print Speed	imageFORCE 8105/8105P: 1-sided: Up to 105 ppm (A4, A5R), Up to 76 ppm (A4R), Up to 53 ppm (A3) 2-sided: Up to 105 ppm (A4, A5R), Up to 76 ppm (A4R), Up to 53 ppm (A3)
	imageFORCE 8195/8195P: 1-sided: Up to 95 ppm (A4, A5R), Up to 69 ppm (A4R), Up to 48 ppm (A3) 2-sided: Up to 95 ppm (A4, A5R), Up to 69 ppm (A4R), Up to 48 ppm (A3)
	imageFORCE 8186/8186P: 1-sided: Up to 86 ppm (A4, A5R), Up to 62 ppm (A4R), Up to 44 ppm (A3) 2-sided: Up to 86 ppm (A4, A5R), Up to 62 ppm (A4R), Up to 44 ppm (A3)
Print Resolution (dpi)	2,400 x 2,400

# TECHNICAL SPECIFICATIONS

<b>Page Description Languages</b>	Standard: UFR II Optional: PCL6/PCL5, Adobe® PostScript®3™
<b>Direct Print</b>	Supported file types: PDF, EPS, TIFF/JPEG, and XPS
<b>Printing From Mobile And Cloud</b>	AirPrint, Mopria, IPP Everywhere, Canon PRINT, uniFLOW Online, Universal Print and Cloud Connector  A range of software and MEAP-based solutions are available to provide printing from mobile devices or internet-connected devices and cloud-based services depending on your requirements. Please contact your sales representative for further information
<b>OS Standard Printing</b>	Android/Windows® 10/Windows® 11/Chrome OS/macOS (11.2.2 or later) /iOS (15.2 or later)/ iPadOS
<b>Fonts</b>	PS fonts: 136 Roman PCL fonts: 93 Roman, 10 Bitmap fonts, 2 OCR fonts, Andalé Mono WT J/K/S/T *1 (Japanese, Korean, Simplified and Traditional Chinese), Barcode fonts*2 *1 Optional PCL International Font Set-A1 is required. *2 Optional Barcode Printing Kit-D1 is required.
<b>Print Features</b>	Secured Print, Secure Watermark, Header/ Footer, Page Layout, Two-sided Printing, Mixed Paper Sizes/Orientations, Front/Back Covers, Toner Reduction, Poster Printing, Forced Hold printing, Print Date, Scheduled Printing, Printing Using a Virtual Printer
<b>Operating System</b>	UFR II: Windows® 10/11/Server2016/Server2019/Server2022/Server2025, Mac OS X (10.14 or later) PCL: Windows® 10/11/Server2016/Server2019/Server2022/Server2025 PS: Windows® 10/11/Server2016/Server2019/Server2022/Server2025, Mac OS X(10.14 or later) PPD: Windows® 10/11, Mac OS X(10.15 or later)  As of Dec. 2024
<b>COPY SPECIFICATIONS</b>	
<b>Copy Speed</b>	imageFORCE 8105: 1-sided: Up to 105 ppm (A4, A5R), Up to 76 ppm (A4R), Up to 53 ppm (A3) 2-sided: Up to 105 ppm (A4, A5R), Up to 76 ppm (A4R), Up to 53 ppm (A3)
	imageFORCE 8195: 1-sided: Up to 95 ppm (A4, A5R), Up to 69 ppm (A4R), Up to 48 ppm (A3) 2-sided: Up to 95 ppm (A4, A5R), Up to 69 ppm (A4R), Up to 48 ppm (A3)
	imageFORCE 8186: 1-sided: Up to 86 ppm (A4, A5R), Up to 62 ppm (A4R), Up to 44 ppm (A3) 2-sided: Up to 86 ppm (A4, A5R), Up to 62 ppm (A4R), Up to 44 ppm (A3)
<b>First-Copy-Out Time (A4)</b>	imageFORCE 8105/8195: Approx. 4.9 seconds or less imageFORCE 8186: Approx. 5.6 seconds or less
<b>Copy Resolution (dpi)</b>	600 x 600
<b>Multiple Copies</b>	Up to 9,999 copies
<b>Copy Density</b>	Automatic or Manual (9 Levels)
<b>Magnification</b>	Variable zoom: 25% to 400% (1% Increments)

# imageFORCE 8100 Series

<b>Copy Features</b>	Preset R/E Ratios by Area, Two-Sided, Density Adjustment, Original Type Selection, Interrupt Mode, Book to Two Pages, Two-sided Original, Job Build, N on 1, Add Cover, Insert Sheets, Different Size Originals, Page Numbering, Copy Set Numbering, Sharpness, Erase Frame, Secure Watermark, Print Date, Gutter, Print & Check, Negative/Positive, Repeat Images, Merge Job Blocks, Mirror Image, Store in Mail Box, Superimpose Image, Copy ID Card, Skip Blank Pages, Free Size Original, Reserved copy, Copy Sample
<b>SCAN SPECIFICATIONS</b>	
<b>Type</b>	Single-pass Duplexing Automatic Document Feeder [2-sided to 2-sided (Automatic)] * Multi-Sheet Feed Detection is supported.
<b>Document Feeder Paper Capacity (80 gsm)</b>	up to 200 Sheets
<b>Document Feeder Acceptable Paper Weight</b>	Document Feeder media weight: 1-sided scanning: 38 to 220 gsm (BW, CL) 2-sided scanning: 38 to 220 gsm (BW, CL) * An acceptable weights of A6R or smaller is 50 to 220gsm.
<b>Supported Media Sizes</b>	Platen scanning size: up to 297.0 x 431.8 mm  Document Feeder media size: A3, A4, A4R, A5, A5R, A6R, B4, B5, B5R, B6R Custom size: 69.9 x 139.7 mm to 304.8 x 431.8 mm
<b>Scan Speed (ipm, BW/CL, A4)</b>	1-sided Scanning: 135/135 (300 x 300 dpi, send), 135/80 (600 x 600 dpi, copy) 2-sided Scanning: 270/270 (300 x 300 dpi, send), 165/90 (600 x 600 dpi, copy)
<b>Scan Resolution (dpi)</b>	600 x 600
<b>Pull Scan Specifications</b>	Color Network ScanGear2 for both TWAIN and WIA  Supported OS: Windows® 10/11/Server 2016/Server 2019/Server 2022/Server 2025 As of Dec. 2024
<b>Scan Method</b>	Push Scan, Pull Scan, Scan to Box, Scan to Advanced Space, Scan to Network, Scan to USB Memory Key, Scan to Mobile devices, Scan to cloud (uniFLOW Online)
<b>SEND SPECIFICATIONS</b>	
<b>Destination</b>	Standard: E-mail/Internet FAX (SMTP*), SMB, FTP, WebDAV, Mail Box Optional: Super G3 FAX, IP Fax * Available OAuth 2.0 authentication method on Microsoft 365 and Google Workspace
<b>Address Book</b>	LDAP (2,000)/Local (1,600)/Speed dial (200)
<b>Communication Protocol</b>	File: FTP (TCP/IP), SMB3.1.1 (TCP/IP), WebDAV E-mail/I-Fax: SMTP, POP3

# TECHNICAL SPECIFICATIONS

<b>File Format</b>	TIFF (MMR), JPEG*, PDF (Compact, Searchable, Optimize for Web, PDF/A-1b, Trace & Smooth, Encrypted, Device Signature, User Signature), XPS (Compact, Searchable, Device Signature, User Signature), Office Open XML (PowerPoint, Word) *Only Single page
<b>Universal Send Features</b>	Original Type Selection, Two-sided Original, Book to Two Pages, Different-size Originals, Density Adjustment, Sharpness, Copy Ratio, Erase Frame, Job Build, Delayed Send, Preview, Job Done Notice, File Name, Subject/Message, Reply-to, E-mail Priority, TX Report, Original Content Orientation, Skip Blank Pages
<b>FAX SPECIFICATIONS</b>	
<b>Maximum Number Of Connection Lines</b>	1
<b>Modem Speed</b>	Super G3: 33.6 kbps G3: 14.4 kbps
<b>Compression Method</b>	MH, MR, MMR, JBIG
<b>Resolution (Dpi)</b>	400 x 400 (Ultra Fine), 200 x 400 (Super Fine), 200 x 200 (Fine), 200 x 100 (Normal)
<b>Sending/Receiving Size</b>	Sending: A3, A4, A4R, A5*, A5R*, A6R*, B4, B5*, B5R* Receiving: A3, A4, A4R, A5, A5R, B4, B5, B5R *1 Sent as A4 *2 Sent as B4 short
<b>Fax Memory</b>	Up to 30,000 pages (2,000 jobs)
<b>Speed Dials</b>	Max. 200
<b>Group Dials/ Destinations</b>	Max. 199 dials
<b>Sequential Broadcast</b>	Max. 256 addresses
<b>Memory Backup</b>	Yes
<b>Fax Features</b>	Sender's Name (TTI), Selecting the Telephone Line (when sending fax), Direct Send, Delayed Send, Preview, Job Done Notice, TX Report, Interrupt Transmission, Sequential Broadcasting, Password/Subaddress Sending, Confidential Mailbox, 2 on 1 Log
<b>STORE SPECIFICATIONS</b>	
<b>Mail Box (Number supported)</b>	100 User Inboxes, 1 Memory RX Inbox, 50 Confidential Fax Inboxes Maximum 30,000 Pages (2,000 jobs) Stored
<b>Advanced Space</b>	Communication Protocol: SMB or WebDAV Supported Client PC: Windows® 10/11 Concurrent Connections (Max.): SMB:64, WebDAV:3
<b>Advanced Space Available Disc Space</b>	Standard:16 GB (With option: max. 480 GB)
<b>Advanced Space Features</b>	Authentication for Advanced Space Log-in, Sort Function, Printing a PDF File with a Password, Search, File Preview, Authentication Management, Open to public, URI TX, Backup/Restore

# imageFORCE 8100 Series

<b>SECURITY SPECIFICATIONS</b>	
<b>Authentication And Access Control</b>	User Authentication (Picture Login, Picture and PIN Login, Card Login, Username and Password Login, Function Level Login, Mobile Login), Department ID Authentication (Department ID and PIN Login, Function Level Login), uniFLOWOnline/uniFLOW(PIN Login, Picture Login, Picture and PIN Login, Card Login, Card and PIN Login, Username and Password Login, Department ID and PIN Login, Function Level Login), Microsoft Entra ID Authentication (Password Login, Card Login), Two-Factor Authentication at LUI/RUI, Access Management System (Access Control)
<b>Document Security</b>	Print Security (Secure Print, Encrypted Secure Print, Forced Hold Printing, uniFLOW Secure Print*), Receive Data Security (Confidential Fax Inbox Forwarding Received Documents Automatically), Scan Security (Encrypted PDF, Device Signature PDF/XPS, User Signature PDF/XPS), BOX Security (Mail Box Password Protected, Advanced Space Access Control), Send Data Security (Setting for requesting password input per transmission, Restricted E-mail/ File send functions, Confirming FAX number, Allow/Restrict Fax Driver Transmissions, Allow/Restrict Sending from History, S/MIME Support), Secure Watermark *1 Requires uniFLOW Online / uniFLOW
<b>Network Security</b>	TLS 1.3 (FIPS140-3), IPSec (FIPS140-3), IEEE802.1X authentication, SNMP V3.0, Firewall Functionality (IP/MAC Address Filtering), Dual Network Support (Wired LAN/ Wireless LAN, Wired LAN/Wired LAN), WPA3 support (Wi-Fi), Enabling/Disabling (Network Applications, Remote UI, USB Interface), G3 FAX separation from LAN, USB Port separation from LAN, Prohibit the execution of files stored in Advanced Space in the MFP, Scan and Send -Virus Concerns for E-mail Reception
<b>Device Security</b>	Protecting SSD Data [SSD Data Encryption (FIPS140-3), SSD Lock], Standard SSD Initialize, Initialize (NIST 800-88 PURGE LEVEL), Trusted Platform Module (TPM 2.0), Job Log Conceal Function, Protecting MFP Software Integrity: Verify System at Startup (NIST SP800-193: Protection), Checking MFP Software Integrity & Platform Firmware Resiliency: Automatic System Recovery (NIST SP800-193: Recovery), Runtime Intrusion Detection: Trellix Embedded Control, HCD-PP Common Criteria Certification
<b>Device Management And Auditing</b>	Administrator Password, Digital Certificate And Key Management, SAN certificates, Audit Log, Cooperating with External Security Audit System (Security Information and Event Management), Image Data Logging, Security Policy Setting
<b>ENVIRONMENTAL SPECIFICATIONS</b>	
<b>Operating Environment</b>	Temperature: 10 to 30°C Humidity: 20 to 80 % RH (Relative Humidity)
<b>Power Source</b>	220-240 V, 50/60 Hz, 13 A

# TECHNICAL SPECIFICATIONS

# imageFORCE 8100 Series

<b>Power Consumption</b>	<p>Maximum: Approx. 3,120 W Sleep mode: 0.9 W*</p> <p>* 0.9 W is not available in all circumstances due to certain settings.</p> <p>Typical Electricity Consumption (TEC)*: imageFORCE 8186/8186P: 13.7 kWh imageFORCE 8195/8195P: 14.8 kWh imageFORCE 8105/8105P: 15.7 kWh</p> <p>*ENERGY STAR (US scheme), Eligibility Criteria Version 3.0 for Imaging Equipment</p>
<b>Noise Levels</b>	<p>Sound Power Level (LWA,m)* Active (1-sided): imageFORCE 8105/8195/8195P: 73 dB, Kv 3 dB imageFORCE 8105P: 77 dB, Kv 3 dB imageFORCE 8186/8186P: 72 dB, Kv 3 dB *Reference value: measured only one unit with ISO7779, described with ISO9296 (2017)</p> <p>Sound Pressure (LpAm) Bystander's position: Active (1-sided): imageFORCE 8105/8105P: 59 dB* imageFORCE 8195/8195P/8186/8186P: 58 dB* Standby: imageFORCE 8105/8105P/8195/8195P/8186/8186P: 43 dB* * Reference value: measured only one unit with ISO7779, described with ISO9296 (2017)</p>
<b>Standards</b>	Blue Angel (UZ219) (Validation pending)
<b>CONSUMABLES</b>	
<b>Toner Cartridges</b>	C-EXV 1005 Toner BK
<b>Toner Yield (Estimated @ 6% Coverage)</b>	90,500 pages
<b>SOFTWARE AND PRINTER MANAGEMENT</b>	
<b>Tracking &amp; Reporting</b>	uniFLOW Online
<b>Remote Management Tools</b>	iW Enterprise Management Console Remote Distribution & Management Service Monitoring Service
<b>Scanning Software</b>	Color Network ScanGear 2
<b>Optimisation Tools</b>	Canon Driver Configuration Tool
<b>Platform</b>	MEAP (Multifunctional Embedded Application Platform)
<b>PAPER SUPPLY OPTIONS</b>	
<b>Paper Deck Unit-E1</b>	<p>Paper Capacity: 3,660 sheets (80 gsm) Paper Type: Thin, Plain, Recycled, Color, Heavy, Bond, Pre-punched, Letterhead Paper Size: A4, B5 Paper Weight: 52 to 256 gsm</p>
<b>POD Deck Lite-C1</b>	<p>Paper Capacity: 3,660 sheets (80 gsm) Paper Type: Thin, Plain, Recycled, Color, Heavy, Coated, Textured, Tracing, Bond, Transparency, Label, Pre-punched, Letterhead, Tab, Envelope*</p> <p>Paper Size: SRA3, A3, A4, A4R, A5R, B4, B5, B5R, COM10 No.10, Monarch, ISO-C5, DL Custom Size (139.7 x 148.0 mm to 330.2 x 487.7 mm) Paper Weight: 52 to 300 gsm * Envelope Feeder Attachment-G1 is required.</p>

<b>Multi-drawer Paper Deck-E1</b>	<p>Paper Capacity: 5,000 (Upper/Middle: 1,500, Lower: 2,000) sheets (80 gsm) Paper Type: Thin, Plain, Recycled, Color, Heavy, Coated, Textured, Tracing, Bond, Transparency, Label, Pre-punched, Letterhead, Tab, Envelope*</p> <p>Paper Size: SRA3, A3, A4, A4R, A5R, B4, B5, B5R, COM10 No.10, Monarch, ISO-C5, DL Custom Size (139.7 x 182.0 mm to 330.2 x 487.7 mm) Paper Weight: 52 to 300 gsm * Envelope Feeder Attachment-H1 is required.</p>
<b>OUTPUT OPTIONS*</b>	
<b>*Paper capacity may vary with different paper type/size.</b>	
<b>Copy Tray-R2</b>	<p>Capacity: 250 sheets (80 gsm) Paper Weight: 52 to 300 gsm</p>
<b>Staple Finisher-AC1*</b>	<p>Tray Capacity (with 80gsm paper): Upper Tray: A4, A5, A5R, A6R, B5: 250 sheets SRA3, A3, A4R, B4, B5R: 125 sheets Envelopes: 30 sheets Mid Tray: Same as upper tray Lower Tray: A4, A5, A5R, B5: 3,000 sheets SRA3, A3, A4R, B4, B5R: 1,500 sheets A6R: 250 sheets Envelopes: Monarch: 30 sheets, COM10 No.10, DL, ISO-C5: 100 sheets Paper Weight: Upper Tray: 52 to 256 gsm Mid Tray: Same as upper tray Lower Tray: 52 to 300 gsm Staple Position: Corner, Double Staple Capacity: A4, B5: 65 sheets (52 to 90 gsm) A3, A4R, B4: 40 sheets (52 to 90 gsm) Eco Staple: A3, A4: 10 sheets (52 to 64 gsm) 8 sheets (65 to 81.4 gsm) 6 sheets (81.5 to 105 gsm) Staple On Demand: 65 sheets (52 to 90 gsm)</p>
<b>Booklet Finisher-AC2*</b>	<p>(Includes the above Staple Finisher-AC1 basic staple specifications.) Saddle Stitch paper size: A3, A4R, B4, Custom Size (195.0 x 270.0 mm to 304.8 x 457.2 mm) Saddle Stitch Staple Capacity: 20 sheets x 10 sets (52 to 81.4 gsm) (including 1 cover sheet 52 to 256 gsm) Non Staple Folded Bunch Capacity: up to 3 sheets (52 to 105 gsm)</p>



# TECHNICAL SPECIFICATIONS

# imageFORCE 8100 Series

<b>Booklet Finisher-AQ1</b>	<p>Tray Capacity (with 80 gsm paper):  Upper Tray: SRA3, A3, A4, A4R, A5, A5R, A6R, B4, B5, B5R: 1,000 sheets  Z-Fold: A3, B4: 30 sheets  Half-fold: A4R: 50 sheets  Envelope: 150 sheets  Lower Tray:  If [High-Volume Stack Mode] is set to [On]:  A4, B5: 4,000 Sheets  A4R, B5R: 2,000 Sheets  A3, B4: 1,500 Sheets  SRA3: 1,000 Sheets  If [High-Volume Stack Mode] is set to [Off]:  A4, B5: 2,000 Sheets  SRA3, A3, A4R, B4, B5R: 1,000 Sheets  Z-Fold: A3, B4: 30 sheets  Paper Weight: 52 to 300 gsm  Staple Position: Corner, Double  Staple Capacity:  A4, B5: 100 sheets (52 to 80 gsm)  A3, A4R, B4, B5R: 50 sheets (52 to 81.4 gsm)</p> <p>Saddle Stitch paper size:  SRA3, A3, A4R, B4, Custom size (210.0 x 279.4 mm to 330.2 x 487.7 mm)  Saddle Stitch Staple Capacity: 25 sheets (52 to 80 gsm) [including 1 cover sheet up to 300 gsm]  Non Staple Folded Bunch Capacity: up to 5 sheets (52 to 209 gsm)</p>
<b>Staple Finisher-AQ1</b>	<p>Tray Capacity (with 80gsm paper):  Upper Tray:  A4, A5, A5R, A6R, B5: 250 sheets  SRA3, A3, A4R, B4, B5R: 125 sheets  Envelope: 30 sheets  Z-Fold: A3, A4R, B4: 30 sheets  Half-fold: A4R: 30 sheets  Lower Tray:  If [High-Volume Stack Mode] is set to [On]:  A4, B5: 4,000 sheets  A4R, B5R: 2,000 sheets  SRA3, A3, A5, A5R, B4: 1,500 sheets  A6R: 1,000 sheets  If [High-Volume Stack Mode] is set to [Off]: Envelope: 150 sheets  Z-Fold: A3, B4: 30 sheets A4R: 15 sheets  Half-Fold A4: 50 sheets</p> <p>Paper Weight:  Upper Tray: 64 to 300 gsm  Lower Tray: 52 to 300 gsm  Staple Position: Corner, Double  Staple Capacity: A4, B5: 100 sheets (52 to 90 gsm)  SRA3, A3, A4R, B4, B5R: 65 sheets (52 to 90 gsm)</p>
<b>Booklet Finisher-AQ1</b>	<p>(Includes the above Staple Finisher-AQ1 basic specifications.)  Saddle Stitch paper size:  SRA3, A3, A4R, B4, Custom size (210.0 x 279.4 mm to 330.2 x 487.7 mm)  Saddle Stitch Staple Capacity: 20 sheets (60 to 81.4 gsm)  (including 1 cover sheet 60 to 300 gsm)  Non Staple Folded Bunch Capacity: 5 sheets (60 to 105 gsm)</p>

<b>2/4 Hole Puncher Unit-A1</b>	<p>(Requires either the Staple Finisher-AC1 or Booklet Finisher-AC2)  Two or Four Holes  Acceptable Punch Paper Weight: 52 to 300 gsm  Acceptable Punch Paper Size:  Two holes: A3, A4, A4R, A5, B4, B5, B5R  Four holes: A3, A4</p>
<b>4 Hole Puncher Unit-A1</b>	<p>(Requires either the Staple Finisher-AC1 or Booklet Finisher-AC2)  Four Holes  Acceptable Punch Paper Weight: 52 to 300 gsm  Acceptable Punch Paper Size:  Four holes: A3, A4, A4R, A5, B4, B5, B5R</p>
<b>Puncher Unit-BT1</b>	<p>(Requires Booklet Finisher-AQ1)  Two or Four Holes  Acceptable Punch Paper Weight: 52 to 300 gsm  Acceptable Punch Paper Size:  Two holes A3, A4, A4R, A5, B4, B5, B5R, Custom size (182.0 x 257.0 mm to 203.0 x 270.0 mm, 204.0 x 182.0 mm to 297.0 x 432.0 mm)  Four holes A3, A4, B4, B5, Custom size (257.0 x 182.0 mm to 297.0 x 432.0 mm)</p>
<b>Puncher Unit-BU1</b>	<p>(Requires Booklet Finisher-AQ1)  Four Holes  Acceptable Punch Paper Weight: 52 to 300 gsm  Acceptable Punch Paper Size:  Four holes A3, A4, A5, B4, B5, Custom size (257.0 x 182.0 mm to 297.0 x 432.0 mm)</p>
<b>Puncher Unit-BZ1</b>	<p>(Requires either the Staple Finisher-AQ1 or Booklet Finisher-AQ1)  Two or Four Holes  Acceptable Punch Paper Weight: 52 to 300 gsm  Acceptable Punch Paper Size:  Two holes A3, A4, A4R, A5, B4, B5, B5R  Four holes A3, A4, B4, B5</p>
<b>Puncher Unit-CA1</b>	<p>(Requires either the Staple Finisher-AQ1 or Booklet Finisher-AQ1)  Four Holes  Acceptable Punch Paper Weight: 52 to 300 gsm  Acceptable Punch Paper Size:  Four holes A3, A4, A4R, A5, B4, B5, B5R</p>
<b>Multi Function Professional Puncher-C1</b>	<p>(Requires any of the following: Booklet Finisher-AQ1, Staple Finisher-AQ1, or Booklet Finisher-AQ1)  Acceptable Punch Paper Weight:  Bypass: 75 to 256 gsm  Punch: 75 to 256 gsm  Acceptable Punch Paper Size:  Bypass: 100 x 148 mm to 330.2 x 487.7 mm  Punch: A3, A4, A4R, A5  Supported Punch Dies (optional):  A4: Loose Leaf (2- or 4- hole), Velo Bind (12-hole), Plastic comb (21-hole), Twin Loop (23- or 34- hole), Color Coil (47-hole)</p>
<b>Inner Booklet Trimmer-A1</b>	<p>(Requires Booklet Finisher-AQ1)  Acceptable Paper Weight: 60 to 300 gsm  Acceptable Paper Size:  SRA3, A3, A4R, B4, Custom size (210.0 x 279.4 mm to 330.2 x 487.7 mm)  Trim Amount: 2 to 20 mm  Waste Tray Capacity: Approx. 1,500 sheets (80 gsm)</p>

<b>Booklet Trimmer-G1</b>	<p>(Requires Booklet Finisher-AQ1)</p> <p>Booklet Capacity: 10 booklets (booklet size: A4, 50 sheets, 80 gsm)</p> <p>Acceptable Paper Weight: 52 to 300gsm</p> <p>Acceptable Paper Size: SRA3, A3, A4R, B4, Custom size: (210.0 x 279.4 mm to 330.2 x 487.7 mm)</p> <p>Trim Amount: 2 to 28 mm</p> <p>Trimming Capacity: up to 25 sheets (50 sheets by Half-Fold) (52 to 80 gsm)</p> <p>Waste Tray Capacity: Approx. 5,000 Sheets (80 gsm)</p>
<b>Document Insertion Unit-R1</b>	<p>(Requires any of the following: Booklet Finisher-AQ1, Staple Finisher-AQ1, or Booklet Finisher-AQ1)</p> <p>Number of Trays: 2</p> <p>Tray Capacity (with 80gsm paper): Upper tray: 200 sheets Lower tray: 200 sheets</p> <p>Acceptable Paper Type: Thin, Plain, Recycled, Color, Heavy, Coated, Tracing, Textured, Bond, Pre-punched, Letterhead, Tab</p> <p>Acceptable Paper Size: SRA3, A3, A4, A4R, B4, B5, B5R, Custom size: 182 x 182 mm to 330.2 x 487.7 mm</p> <p>Acceptable Paper Weight: 52 to 300 gsm</p>
<b>Paper Folding Unit-K2</b>	<p>(Requires any of the following: Booklet Finisher-AQ1, Staple Finisher-AQ1, or Booklet Finisher-AQ1)</p> <p>Supported Folding Type: Z-Fold, C-Fold, Accordion Z-Fold, Double Parallel-Fold, Half-Fold</p> <p>Acceptable Paper Type: Thin, Plain, Recycled, Color, Bond, Coated, Textured</p> <p>Acceptable Paper Sizes: Z-Fold: A3, A4R, B4 C-Fold, Accordion Z-Fold, Double-Parallel Fold, Half-Fold: A4R</p> <p>Acceptable Paper Weight: Z-Fold, C-Fold, Accordion Z-Fold, Half-Fold: 52 to 105 gsm Double Parallel Fold: 52 to 90 gsm</p> <p>Output Capacity (with 80 gsm paper): Z-Fold, Half-Fold: Depends on the specifications of the finisher C-Fold, Accordion Z-Fold: approx. 40 sheets Double Parallel-Fold: approx. 25 sheets</p>



## Certifications and compatibility

