



i-SENSYS X C1530i II Series

ONE OF THE MOST SECURE, SUSTAINABLE AND PRODUCTIVE MULTIFUNCTION DEVICES IN i-SENSYS X RANGE



PRODUCTIVITY



SECURITY



CONNECTIVITY



COMPACT DESIGN



CONTROL &
MAINTENANCE



SUSTAINABILITY

Canon

i-SENSYS X C1530i II Series

PRODUCTIVITY

- Fast print and scan speeds
- Automatic double-sided printing
- Up to 2,300 sheets paper input

CONNECTIVITY

- Connect to cloud directly from the device for simple storage solutions or through Canon's uniFLOW Online for secure advanced scan workflows
- Print and scan from mobile devices wherever you are

CONTROL AND MAINTENANCE

- Cloud based output management for centralised control
- Flexible user management solutions
- Remote access to device control functions
- Toner status tool reduces downtime

SECURITY

- Embedded User Authentication secures access to device
- Encrypted Secure Print function prevents unauthorised viewing of printed material
- Verify System at Start-up enhances device integrity

COMPACT DESIGN

- Small footprint, ideal as a desktop configuration
- All-in-one cartridge with increased toner yield
- Optional cassettes for enhanced input capacity
- Easy access to replace consumables

SUSTAINABILITY

- Low TEC (Typical Electrical Consumption) decreases power consumption to save energy and lower running costs
- Sleep mode and low melting point toner reduce energy consumption further
- Auto Duplex Print saves on paper wastage

I-SENSYS X C1530i II SERIES DETAILS

i-SENSYS X C1538iF II :

- Print, Copy, Scan, Send and Fax
- Intuitive 7-inch colour touch screen
- Print Speed: 38ppm (A4) (colour/BW)
- Scan speed: up to 190ipm
- uniFLOW online option
- Wi-Fi as standard
- 4.0 second machine warm up time

i-SENSYS X C1533iF II :

- Print, Copy, Scan, Send and Fax
- Intuitive 7-inch colour touch screen
- Print Speed: 33ppm (A4) (colour/BW)
- Scan speed: up to 190ipm
- uniFLOW online option
- Wi-Fi as standard
- 4.0 second machine warm up time

TAILORED SOLUTIONS TO MEET EVERY CHALLENGE

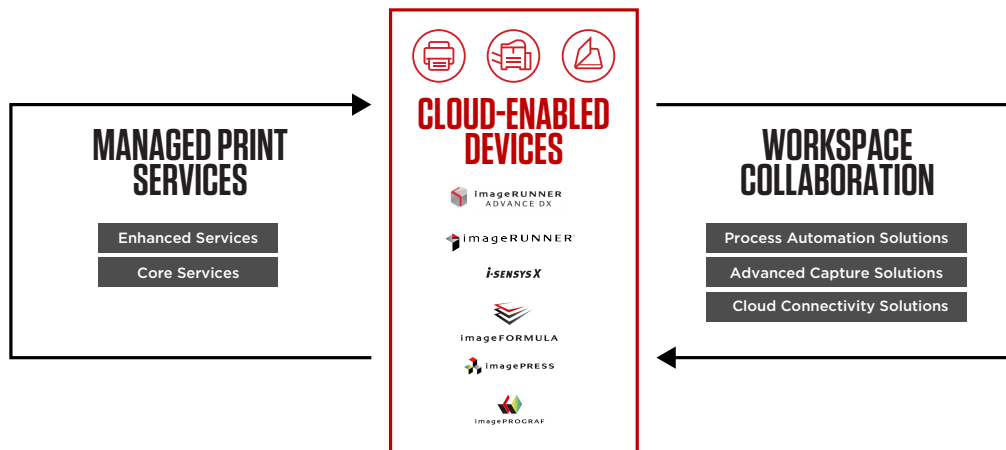

Canon's Digital Transformation Services (DTS), bring together our leading hardware and software into an integrated technology ecosystem, designed to support your transformation journey. This offering combines Managed Print Services and Workspace Collaboration solutions, to help you gain transparency and control over the entire document lifecycle.

i-SENSYS X C1530i II Series

MAIN CONFIGURATION OPTIONS

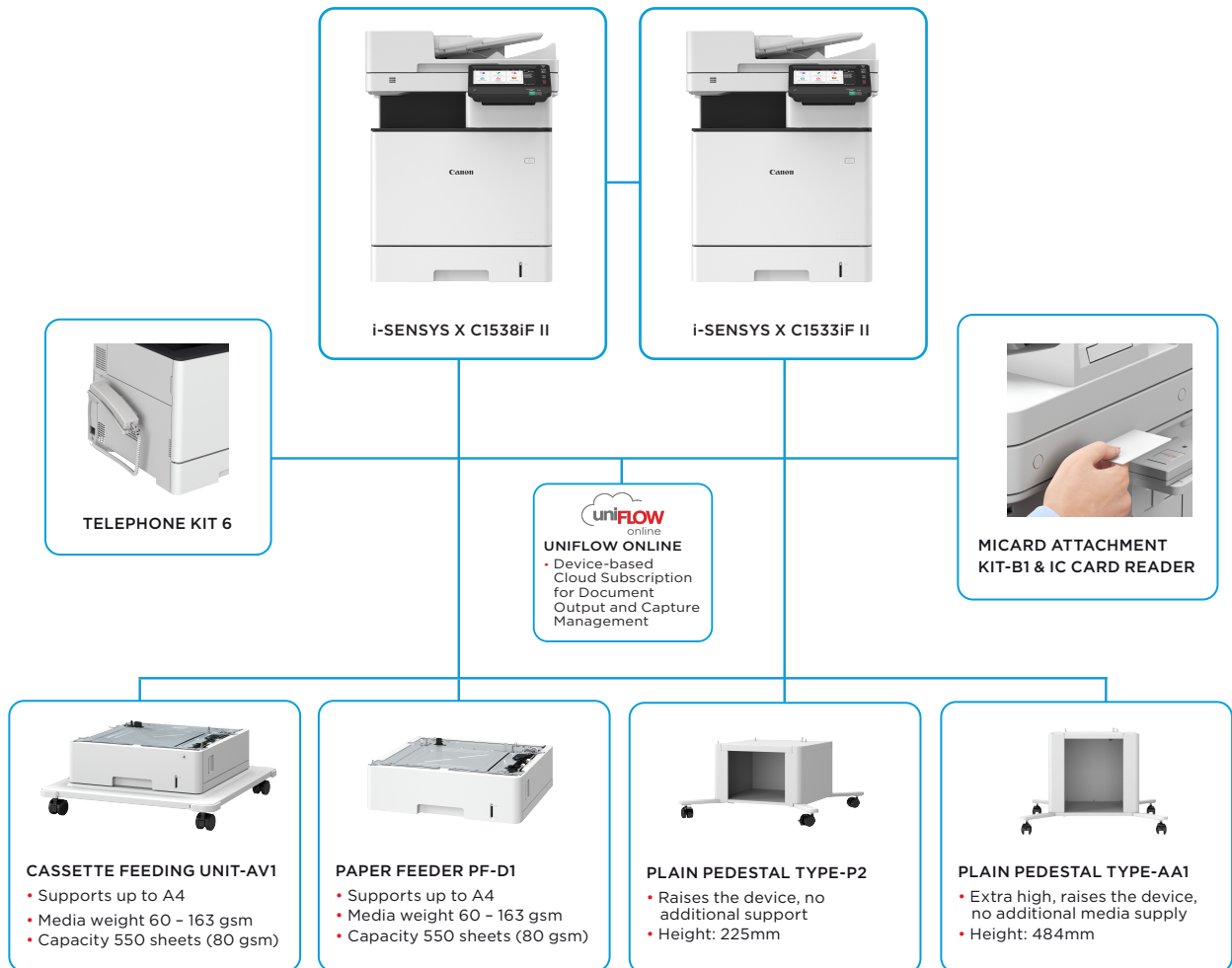

This flat configuration is for illustration purpose only. For a complete list of options and the exact compatibility relationships, please refer to the [online product configurator](#)

TECHNICAL SPECIFICATIONS

i-SENSYS X C1530i II Series

MAIN UNIT		Fonts	PS fonts: 136 Roman PCL fonts: 93 Roman, 10 Bitmap fonts, 2 OCR fonts, Andalé Mono WT J/K/S/T*1 (Japanese, Korean, Simplified and Traditional Chinese), Barcode fonts*2
Machine type	A4 Color Laser Multifunctional		
Core functions	Print, Copy, Scan, Send and Fax		
Processor	1.6GHz Dual Core Processor		
Control Panel	17.8 cm/7 inch TFT LCD WVGA color Touch panel		
Memory	Standard: 2.0GB RAM		*1Requires optional PCL INTERNATIONAL FONT SET-A1 *2Require optional BARCODE PRT KIT-D1
Storage	Standard: 64GB eMMC (available space 30GB)	Print Features	Secure Print, Secure Watermark, Header/Footer, Page Layout, Two-sided Printing, Mixed Paper Sizes/ Orientations, Toner Reduction, Poster Printing, Forced hold printing, Print Date, Scheduled Printing, Printing Using a Virtual Printer
Interface Connection	NETWORK Standard: 1000Base-T/100Base-TX/10Base-T, Wireless LAN (IEEE 802.11 b/g/n) OTHERS Standard: USB 2.0 (Host) x2, USB 2.0 (Device) x1		
Paper Supply Capacity (A4, 80gsm)	Standard: 650 sheets Maximum: 2300 sheets (with Cassette Feeding Unit-AV1+Paper Feeder PF-D1 x2)	Operating System	UFRII/PCL/PS: Windows® 10/11/Server 2016/ Server 2019/Server 2022, MAC OS X (10.13 or later) PPD: Windows® 10/11, MAC OS X (10.13 or later)
Paper output capacity (A4, 80gsm)	Standard: 200 sheets Maximum: 200 sheets	COPY SPECIFICATION	
Finishing capabilities	Collate, Group	Copy Speed (BW/CL)	C1538iF II: Up to 38/38 ppm (A4R), Up to 40/40 ppm (A5R), Up to 59/59 ppm (A5) Double sided: Up to 38 ipm (A4) C1533iF II: Up to 33/33 ppm (A4R), Up to 40/40 ppm (A5R), Up to 55/55 ppm (A5) Double sided: Up to 33 ipm (A4) from Cassette, 21 ipm (A4) from Multi Purpose Tray Approx. 5.9 /6.9 seconds or less
Supported media types	Multi-purpose Tray: Thin, Plain, Recycled, Color, Heavy, Bond, Pre-punched, Envelope, PostCard Paper Cassette: Thin, Plain, Recycled, Color, Heavy, Pre-punched, Bond, Labels	First-Copy-Out Time (A4, BW/CL)	
Supported media sizes	Multi-purpose tray: Standard size: A4R, A5, A5R, A6R, B5R, Envelopes [No. 10(COM 10), Monarch, ISO-C5, DL] Custom Size/Free Size: Min.76.2 x127.0 mm up to 216.0 x355.6 mm Paper Cassette: Standard size: A4R, A5, A5R, A6R, B5R	Copy resolution (dpi)	600 x 600
Supported media weights	Multi-purpose tray: 60 to 216 gsm Paper Cassettes: 60 to 163 gsm Duplex: 60 to 163 gsm	Multiple Copies	Up to 999 copies
Warm-up Time	4 Seconds or Less* *Time from device power-on to when key operations can be performed on the touch panel display. From Sleep Mode: 10 Seconds or Less* *Time from device power on, until copy ready (not print reservation)	Copy Density	Automatic or Manual (9 Levels)
Dimensions (W x D x H)	500 x 556 x 640 mm	Magnification	25% - 400% (1% Increments) Preset reduction/enlargement: 25%, 50%, 70%, 100%, 141%, 200%, 400%
Installation Space(W x D)	717 x785 mm (with Multipurpose Tray extended and Cassette door open)	Copy Features	Preset R/E Ratios by Area, Two-Sided, Density Adjustment, Original Type Selection, Interrupt Mode, Two-sided Original, Sort, Job Build, N on 1, Sharpness, Erase Frame, Copy ID Card, Skip Blank Pages, Color Mode, Reserved copy, Copy Sample
Weight	Approx. 41.0 kg including toner	SCAN SPECIFICATION	
PRINT SPECIFICATIONS		Type	Standard: Single-pass Duplexing Automatic Document Feeder (2-sided to 2-sided) up to 100sheets
Print Speed (BW/CL)	C1538iF II: Up to 38/38 ppm (A4R), Up to 40/40 ppm (A5R), Up to 59/59 ppm (A5) Double sided: Up to 38 ipm (A4) from Cassette, 21 ipm (A4) from Multi Purpose Tray C1533iF II: Up to 33/33 ppm (A4R), Up to 40/40 ppm (A5R), Up to 55/55 ppm (A5) Double sided: Up to 33 ipm (A4) from Cassette, 21 ipm (A4) from Multi Purpose Tray	Document Feeder Paper Capacity (80 gsm)	
Print Resolution (dpi)	1200 x 1200 dpi	Acceptable Originals and weights	Platen: Sheet, Book Document Feeder media weight : 1-sided scanning: 42 to 128 gsm (BW), 64 to 128 gsm (CL) 2-sided scanning: 50 to 128 gsm (BW), 64 to 128gsm (CL)
Page description languages	Standard: UFRⅡ, PCL6/PCL5, Adobe® PostScript®3™	Supported media sizes	Platen: max. scanning size: 216.0 x 355.6 mm Document Feeder media size: A4R, A5R, A6R, B5R Custom size: 48.0 x128.0 mm to 216.0 x355.6 mm
Direct Print	Supported file types: RUI: PDF, EPS, TIFF/JPEG, XPS USB Memory: PDF, TIFF/JPEG, XPS Network Place: PDF, TIFF/JPEG, XPS AirPrint, Mopria, Universal Print by Microsoft	Scan Speed (ipm: BW/CL, A4)	DADF: 1-sided Scanning: 95/95 (300 dpi, send), 50/95 (600 dpi, copy) 2-sided Scanning: 190/190 (300 dpi, send), 140/100 (600 dpi, copy)
Printing from mobile and cloud	AirPrint, Mopria, Canon Business PRINT and uniFLOW Online A range of software solutions is available to provide printing from mobile devices and cloud-based services depending on your requirements. Please contact your sales representative for further information	Scan Resolution (dpi)	Scan for Copy: up to 600 x 600 Scan for Send: (Push,BW) up to 600 x 600, (Pull,BW) up to 600 x 600 (Push,CL) up to 300 x 300, (Pull,CL) up to 300 x 300 Scan for Fax: up to 600 x 600
		Pull Scan Specifications	Color Network ScanGear2. For both TWAIN and WIA Supported OS: Windows® 10/ 11/ Server 2016/ Server 2019/ Server 2022
		Scan Method	Push Scan, Pull Scan, Scan to Network, Scan to USB Memory Key, Scan to Mobile Device, Scan to cloud-based services(uniFLOW Online/Online Express)

TECHNICAL SPECIFICATIONS

i-SENSYS X C1530i II Series

SEND SPECIFICATIONS

Destination	Standard: E-mail/Internet FAX (SMTP), Super G3 FAX, SMB3.1.1, FTP, WebDAV
Address Book	LDAP (2,000)/ Local (1,600)/Speed dial (200)
Send resolution (dpi)	Push: 100 x 100, 150 x 150, 200 x 100 (Normal), 200 x 200 (Fine), 200 x 400*(SuperFine), 300 x 300, 400 x400*(UltraFine), 600 x 600* Pull: 75 x 75, 100 x 100, 150 x 150, 200 x 200, 300 x 300, 400 x 400*, 600 x 600* *color mode is black and white only
Communication protocol	File: FTP (TCP/IP), SMB (TCP/IP), WebDAV Email/iFax: SMTP(send), POP3(receive)
File Format	Standard: TIFF (MMR), JPEG *, PDF (Compact, Searchable, PDF/A-1b, Encrypted), XPS (Compact, Searchable), PDF/XPS (Device Signature), Office Open XML (PowerPoint, Word) Optional: PDF (Trace & Smooth), PDF/XPS (User Signature) *Single page only
Universal Send Features	Original Type Selection, Two-sided Original, Density Adjustment, Sharpness, Erase Frame, Job Build, Delayed Send, Preview, Job Done Notice, File Name, Subject/Message, Reply-to, E-mail Priority, TX Report, Original Content Orientation

FAX SPECIFICATIONS

Maximum Number of Connection Lines	1
Modem Speed	Super G3: 33.6 kbps G3: 14.4 kbps
Compression Method	MH, MR, MMR, JBIG
Resolution (dpi)	400 x 400 (Ultrafine), 200 x 400 (Superfine), 200 x 200 (Fine), 200 x 100 (Normal)Content Delivery System: Server platform enables automatic firmware update to the device.
Sending/Receiving Size	Sending: A4, A5*1, A6*1, B5*1 Receiving: A4, A5, B5 *1 Sent as A4
FAX memory	Up to 30,000 pages
Speed dials	Max. 200
Group dials/destinations	Max. 199 dials
Sequential broadcast	Max. 256 addresses
Memory backup	Yes
Fax Features	Sender's Name (TTI), Direct Send, Delayed Send, Preview, Job Done Notice, TX Report, Interrupt Transmission, Sequential Broadcasting, Password/Subaddress Sending, Confidential Mailbox

STORE SPECIFICATIONS

Memory Media	Standard: USB Memory
---------------------	----------------------

SECURITY SPECIFICATIONS

Authentication and Access Control	User Authentication(Picture Login, Picture and PIN Login, Username and Password Login, Function Level Login, Mobile Login), Department ID Authentication(Department ID and PIN Login, Function Level Login), uniFLOW Online*(PIN Login, Picture Login, Picture and PIN Login, Card Login, Card and PIN Login, Username and Password Login, Department ID and PIN Login, Function Level Login), Access Management System(Access Control)
--	---

Document Security

Print Security(Secure Print, Encrypted SecurePrint, Forced Hold Printing, uniFLOW Secure Print*1), Receive Data Security(Confidential Fax Inbox Forwarding Received Documents Automatically), Scan Security (Encrypted PDF, Device Signature PDF/XPS, User Signature PDF/XPS, Adobe LiveCycle* Rights Management ES2.5 Integration), Scan Security (Encrypted PDF, Device Signature PDF/XPS, User Signature PDF/XPS*2), Send Data Security (Setting for requesting password input per transmission, Restricted E-mail/File send functions, Confirming FAX number, Allow/Restrict Fax Driver Transmissions, Allow/Restrict Sending from History, S/MIME Support), Document Tracking (Secure Watermark)

*1 Requires optional uniFLOW Online / uniFLOW

*2 Requires optional Universal Send Digital User Signature Kit-C1

Network Security

TLS1.3, IPsec, IEEE802.1X authentication (LAN/WLAN), SNMPv3, Firewall Functionality(IP/MAC Address Filtering), WPA3 support, Dual Network Support (Wired LAN/Wireless LAN, Wired LAN/Wired LAN), Disabling Unused Functions (Enabling/Disabling Protocols/Applications, Enabling/Disabling Remote UI, Enabling/Disabling USB Interface), Communication Line Separation (G3 FAX, USB Port, Advanced Space, Scan and Send -Virus Concerns for E-mail Reception)

Device Security

Standard Storage Initialize, Job Log Conceal Function, Protecting MFP Software Integrity, Checking MFD Software Integrity & Platform Firmware Resiliency (NIST SP800-193) with Automatic System Recovery (Verify System at Start-up, Runtime Intrusion Detection enabled with Trelix Embedded Control)

Device Management and Auditing

Administrator Password, Digital Certificate and Key Management, Audit Log, Cooperating with External Security Audit System (Security Information and Event Management), Security Policy Setting

ENVIRONMENTAL SPECIFICATIONS

Operating Environment

Temperature: 10 to 30 °C
Humidity: 20 to 80% RH (Relative Humidity)
220-240V 50/60Hz 10A

Power source

Power consumption

Maximum: Approx. 1,500 W
Active printing
C1538iF II: Approx. 701W
C1533iF II: Approx. 678W
Standby: Approx. 40.6 W*1
Sleep mode: Approx. 0.9 W*2

*1 Reference value: measured one unit

*2 Sleep mode is not available in all circumstances due to certain settings.

Typical Electricity Consumption (TEC)* :

C1538iF II: 0.37kWh

C1533iF II: 0.34kWh

*As per US ENERGY STAR version 3.2

Noise levels (BW/CL)

Sound Power Level (LWA,m)

C1538iF II

Active(1-sided): 6.2B*1, Kv 0.3B*1

*1 Reference value: measured only one unit with ISO7779, described with ISO9296:2017

C1533iF II

Active(1-sided): 6.1B*1, Kv 0.3B*1

*1 Reference value: measured only one unit with ISO7779, described with ISO9296:2017

Sound Pressure Level (LpAm)

Bystander's position:

Active (1-sided): 50 dB*1

*1 Reference value: measured only one unit with ISO7779, described with ISO9296:2017

Standards

Blue Angel (Applied for)

TECHNICAL SPECIFICATIONS

i-SENSYS X C1530i II Series

CONSUMABLES

Toner Cartridges

T10 TONER BK/C/M/Y
T10L TONER BK/C/M/Y

Toner Yield (Estimated @ 5% Coverage)

T10 TONER BK: 13,000 pages
T10 TONER C/M/Y: 10,000 pages
T10L TONER BK: 6,000 pages
T10L TONER C/M/Y: 5,000 pages

SOFTWARE AND PRINTER MANAGEMENT

Tracking and reporting

uniFLOW Online (optional)

Remote management tools

iW Enterprise Management Console
eMaintenance
Content Delivery System

Scanning software

Network ScanGear2

PAPER SUPPLY OPTIONS

Cassette Feeding Unit-AV1

Paper Capacity: 550 sheets x 1 (80 gsm)
Paper Type: Thin, Plain, Heavy, Recycled, color, Pre-punched, Bond, Labels
Paper Size: A4R, A5, A5R, A6R, B5R, B6R
Custom Size: 101.6 x 148.0mm-216.0 x 355.6mm
Paper Weight: 60 to 163 gsm
Dimensions (W x D x H): 597 x 635 x 225 mm
Weight: Approx. 15.5 kg

Paper Feeder PF-D1

Paper Capacity: 550 sheets x 1 (80 gsm)
Paper Type: Thin, Plain, Heavy, Recycled, color, Pre-punched, Bond, Labels
Paper Size: A4R, A5, A5R, A6R, B5R, B6R
Custom Size: 101.6 x 148.0mm-216.0 x 355.6mm
Paper Weight: 60 to 163 gsm
Dimensions (W x D x H): 458 x 464 x 130 mm
Weight: Approx. 6.1 kg

HARDWARE ACCESSORIES

OTHERS

MiCARD Attachment Kit-B1
Plain Pedestal-AA1
Plain Pedestal-P2

SYSTEM AND CONTROLLER OPTIONS

Print Accessories

PCL International Font Set-A1

SEND OPTIONS

Universal Send Trace & Smooth PDF Kit-A1
Universal Send Digital User Signature Kit-C1

Barcode Printing

Barcode Printing Kit-D1

OTHER OPTIONS

Accessibility Accessories

ADF Access Handle-A1
TELEPHONE 6 KIT Long cord Cool White

Software & Solutions



Compatibility



Canon

Canon Inc.
canon.com

Canon Europe
canon-europe.com

English edition
© Canon Europa N.V., 2026