



i-SENSYS X C1530iF II Series

ONE OF THE MOST SECURE, SUSTAINABLE AND PRODUCTIVE MULTIFUNCTION DEVICES IN i-SENSYS X RANGE



PRODUCTIVITY



SECURITY



CONNECTIVITY



COMPACT DESIGN



CONTROL &
MAINTENANCE



SUSTAINABILITY

Canon

i-SENSYS X C1530iF II Series

PRODUCTIVITY

- Fast print and scan speeds
- Automatic double-sided printing
- Up to 2,300 sheets paper input

CONNECTIVITY

- Connect to cloud directly from the device for simple storage solutions or through Canon's uniFLOW Online for secure advanced scan workflows
- Print and scan from mobile devices wherever you are

CONTROL AND MAINTENANCE

- Cloud based output management for centralised control
- Flexible user management solutions
- Remote access to device control functions
- Toner status tool reduces downtime

SECURITY

- Embedded User Authentication secures access to device
- Encrypted Secure Print function prevents unauthorised viewing of printed material
- Verify System at Start-up enhances device integrity

COMPACT DESIGN

- Small footprint, ideal as a desktop configuration
- All-in-one cartridge with increased toner yield
- Optional cassettes for enhanced input capacity
- Easy access to replace consumables

SUSTAINABILITY

- Low TEC (Typical Electrical Consumption) decreases power consumption to save energy and lower running costs
- Sleep mode and low melting point toner reduce energy consumption further
- Auto Duplex Print saves on paper wastage

I-SENSYS X C1530iF II SERIES DETAILS

i-SENSYS X C1538iF II :

- Print, Copy, Scan, Send and Fax
- Intuitive 7-inch colour touch screen
- Print Speed: 38ppm (A4) (colour/BW)
- Scan speed: up to 190ipm
- uniFLOW online option
- Wi-Fi as standard
- 4.0 second machine warm up time

i-SENSYS X C1533iF II :

- Print, Copy, Scan, Send and Fax
- Intuitive 7-inch colour touch screen
- Print Speed: 33ppm (A4) (colour/BW)
- Scan speed: up to 190ipm
- uniFLOW online option
- Wi-Fi as standard
- 4.0 second machine warm up time

TAILORED SOLUTIONS TO MEET EVERY CHALLENGE

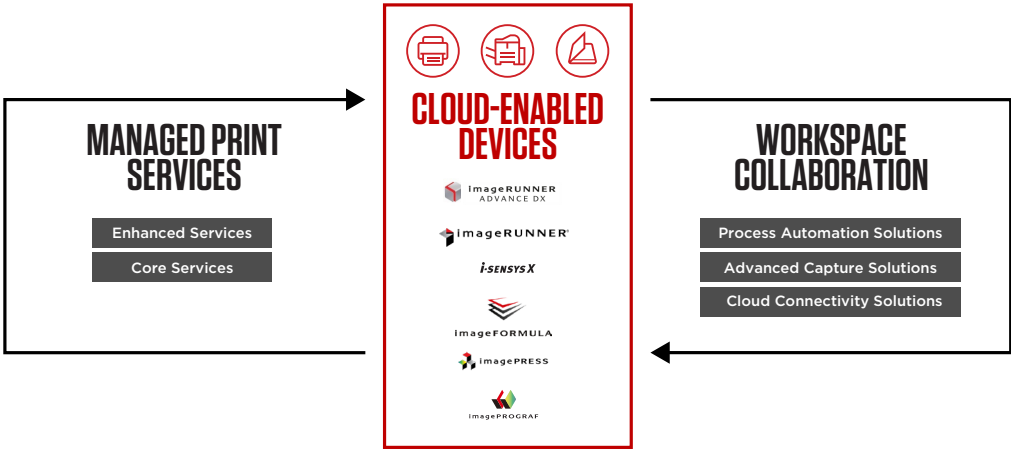

Canon's Digital Transformation Services (DTS), bring together our leading hardware and software into an integrated technology ecosystem, designed to support your transformation journey. This offering combines Managed Print Services and Workspace Collaboration solutions, to help you gain transparency and control over the entire document lifecycle.



TECHNICAL SPECIFICATIONS

i-SENSYS X C1530iF II Series

MAIN UNIT		Multiple Copies	Up to 999 copies
Machine type	A4 Color Laser Multifunctional	Copy Density	Automatic or Manual (9 Levels)
Core functions	Print, Copy, Scan, Send and Fax	Magnification	25% - 400% (1% Increments) Preset reduction/enlargement: 25%, 50%, 70%, 100%, 141%, 200%, 400%
Processor	1.6GHz Dual Core Processor		
Control Panel	17.8 cm/7 inch TFT LCD WVGA color Touch panel	Copy Features	Preset R/E Ratios by Area, Two-Sided, Density Adjustment, Original Type Selection, Interrupt Mode, Two-sided Original, Sort, Job Build, N on 1, Sharpness, Erase Frame, Copy ID Card, Skip Blank Pages, Color Mode, Reserved copy, Copy Sample
Memory	Standard: 2.0GB RAM		
Storage	Standard: 64GB eMMC (available space 30GB)		
Interface Connection	NETWORK Standard: 1000Base-T/100Base-TX/10Base-T, Wireless LAN (IEEE 802.11 b/g/n) OTHERS Standard: USB 2.0 (Host) x2, USB 2.0 (Device) x1	SCAN SPECIFICATION	
	Standard: 650 sheets Maximum: 2300 sheets (with Cassette Feeding Unit-AV1+Paper Feeder PF-D1 x2)	Type	Standard: Single-pass Duplexing Automatic Document Feeder (2-sided to 2-sided) up to 100sheets
Paper Supply Capacity (A4, 80gsm)		Document Feeder Paper Capacity (80 gsm)	
Paper output capacity (A4, 80gsm)	Standard: 200 sheets Maximum: 200 sheets	Acceptable Originals and weights	Platen: Sheet, Book Document Feeder media weight : 1-sided scanning: 42 to 128 gsm (BW), 64 to 128 gsm (CL) 2-sided scanning: 50 to 128 gsm (BW), 64 to 128gsm (CL)
Finishing capabilities	Collate, Group		
Supported media types	Multi-purpose Tray: Thin, Plain, Recycled, Color, Heavy, Bond, Pre-punched, Envelope, PostCard Paper Cassette: Thin, Plain, Recycled, Color, Heavy, Pre-punched, Bond, Labels	Supported media sizes	Platen: max. scanning size: 216.0 x 355.6 mm Document Feeder media size: A4R, A5R, A6R, B5R Custom size: 48.0 x128.0 mm to 216.0 x355.6 mm
		Scan Speed (ipm: BW/CL, A4)	DADF: 1-sided Scanning: 95/95 (300 dpi, send), 50/95 (600 dpi, copy) 2-sided Scanning: 190/190 (300 dpi, send), 140/100 (600 dpi, copy)
Supported media sizes	Multi-purpose tray: Standard size: A4R, A5, A5R, A6R, B5R, Envelopes [No. 10(COM10), Monarch, ISO-C5, DL] Custom Size/Free Size: Min.76.2 x127.0 mm up to 216.0 x355.6 mm Paper Cassette: Standard size: A4R, A5, A5R, A6R, B5R	Scan Resolution (dpi)	Scan for Copy: up to 600 x 600 Scan for Send: (Push,BW) up to 600 x 600, (Pull,BW) up to 600 x 600 (Push,CL) up to 300 x 300, (Pull,CL) up to 300 x 300 Scan for Fax: up to 600 x 600
Supported media weights	Multi-purpose tray: 60 to 216 gsm Paper Cassettes: 60 to 163 gsm Duplex: 60 to 163 gsm	Pull Scan Specifications	Color Network ScanGear2. For both TWAIN and WIA Supported OS: Windows® 10/ 11/ Server 2016/ Server 2019/ Server 2022
Warm-up Time	4 Seconds or Less* *Time from device power-on to when key operations can be performed on the touch panel display. From Sleep Mode: 10 Seconds or Less* *Time from device power on, until copy ready (not print reservation)	Scan Method	Push Scan, Pull Scan, Scan to Network, Scan to USB Memory Key, Scan to Mobile Device, Scan to cloud-based services(UniFLOW Online/Online Express)
Dimensions (W x D x H)	500 x 556 x 640 mm	SEND SPECIFICATIONS	
Installation Space(W x D)	717 x785 mm (with Multipurpose Tray extended and Cassette door open)	Destination	Standard: E-mail/Internet FAX (SMTP), Super G3 FAX, SMB3.1.1, FTP, WebDAV
Weight	Approx. 41.0 kg including toner	Address Book	LDAP (2,000)/ Local (1,600) /Speed dial (200)
		Send resolution (dpi)	Push: 100 x 100, 150 x 150, 200 x 100 (Normal), 200 x 200 (Fine), 200 x 400*(SuperFine), 300 x 300, 400 x400*(UltraFine), 600 x 600* Pull: 75 x 75, 100 x 100, 150 x 150, 200 x 200, 300 x 300, 400 x 400*, 600 x 600* *color mode is black and white only
PRINT SPECIFICATIONS		Communication protocol	File: FTP (TCP/IP), SMB (TCP/IP), WebDAV Email/iFax: SMTP(send), POP3(receive)
Print Speed (BW/CL)	C1538iF II: Up to 38/38 ppm (A4R), Up to 40/40 ppm (A5R), Up to 59/59 ppm (A5) Double sided: Up to 38 ipm (A4) from Cassette, 21 ipm (A4) from Multi Purpose Tray C1533iF II: Up to 33/33 ppm (A4R), Up to 40/40 ppm (A5R), Up to 55/55 ppm (A5) Double sided: Up to 33 ipm (A4) from Cassette, 21 ipm (A4) from Multi Purpose Tray	File Format	Standard: TIFF (MMR), JPEG *, PDF (Compact, Searchable, PDF/A-1b, Encrypted), XPS (Compact, Searchable), PDF/XPS (Device Signature), Office Open XML (PowerPoint, Word) Optional: PDF (Trace & Smooth), PDF/XPS (User Signature) *Single page only
Print Resolution (dpi)	1200 × 1200 dpi		
Page description languages	Standard: UFRn, PCL6, Adobe® PostScript®3™	Universal Send Features	Original Type Selection, Two-sided Original, Density Adjustment, Sharpness, Erase Frame, Job Build, Delayed Send, Preview, Job Done Notice, File Name, Subject/ Message, Reply-to, E-mail Priority, TX Report, Original Content Orientation
Direct Print	Supported file types: RUI: PDF, EPS, TIFF/JPEG, XPS USB Memory: PDF, TIFF/JPEG, XPS Network Place: PDF, TIFF/JPEG, XPS AirPrint, Mopria, Universal Print by Microsoft		
Printing from mobile and cloud	AirPrint, Mopria, Canon Business PRINT and uniFLOW Online A range of software solutions is available to provide printing from mobile devices and cloud-based services depending on your requirements. Please contact your sales representative for further information	FAX SPECIFICATIONS	
		Maximum Number of Connection Lines	1
Fonts	PS fonts: 136 Roman PCL fonts: 93 Roman, 10 Bitmap fonts, 2 OCR fonts, Andale Mono WT J/K/S/T*1 (Japanese, Korean, Simplified and Traditional Chinese), Barcode fonts*2 *1Requires optional PCL INTERNATIONAL FONT SET-A1 *2Require optional BARCODE PRT KIT-D1	Modem Speed	Super G3: 33.6 kbps G3: 14.4 kbps MH, MR, MMR, JBIG
		Compression Method	
Print Features	Secure Print, Secure Watermark, Header/Footer, Page Layout, Two-sided Printing, Mixed Paper Sizes/ Orientations, Toner Reduction, Poster Printing, Forced hold printing, Print Date, Scheduled Printing, Printing Using a Virtual Printer	Resolution (dpi)	400 x 400 (Ultrafine), 200 x 400 (Superfine), 200 x 200 (Fine), 200 x 100 (Normal)Content Delivery System: Server platform enables automatic firmware update to the device.
Operating System	UFRn/PCL/PS: Windows® 10/11/Server 2016/Server 2019/Server 2022, MAC OS X (10.13 or later) PPD: Windows® 10/11, MAC OS X (10.13 or later)	Sending/Receiving Size	Sending: A4, A5*1, A6*1, B5*1 Receiving: A4, A5, B5 *1 Sent as A4
		FAX memory	Up to 30,000 pages
COPY SPECIFICATION		Speed dials	Max. 200
Copy Speed (BW/CL)	C1538iF II: Up to 38/38 ppm (A4R), Up to 40/40 ppm (A5R), Up to 59/59 ppm (A5) Double sided: Up to 38 ipm (A4) C1533iF II: Up to 33/33 ppm (A4R), Up to 40/40 ppm (A5R), Up to 55/55 ppm (A5) Double sided: Up to 33 ipm (A4) from Cassette, 21 ipm (A4) from Multi Purpose Tray	Group dials/destinations	Max. 199 dials
		Sequential broadcast	Max. 256 addresses
First-Copy-Out Time (A4, BW/CL)	Approx. 5.9 /6.9 seconds or less	Memory backup	Yes
Copy resolution (dpi)	600 x 600	Fax Features	Sender's Name (TTI), Direct Send, Delayed Send, Preview, Job Done Notice, TX Report, Interrupt Transmission, Sequential Broadcasting, Password/ Subaddress Sending, Confidential Mailbox
		STORE SPECIFICATIONS	
		Memory Media	Standard: USB Memory



TECHNICAL SPECIFICATIONS

i-SENSYS X C1530iF II Series

SECURITY SPECIFICATIONS		Standards	Blue Angel (Applied for)
Authentication and Access Control	User Authentication(Picture Login, Picture and PIN Login, Username and Password Login, Function Level Login, Mobile Login), Department ID Authentication(Depertment ID and PIN Login, Function Level Login), uniFLOW Online Express(PIN Login, Picture Login, Picture and PIN Login, Card Login, Card and PIN Login, Username and Password Login, Depertment ID and PIN Login, Function Level Login), Access Management System(Access Control)	CONSUMABLES	
		Toner Cartridges	T10 TONER BK/C/M/Y T10L TONER BK/C/M/Y
		Toner Yield (Estimated @ 5% Coverage)	T10 TONER BK: 13,000 pages T10 TONER C/M/Y: 10,000 pages T10L TONER BK: 6,000 pages T10L TONER C/M/Y: 5,000 pages
Document Security	Print Security(Secure Print, Encrypted SecurePrint, Forced Hold Printing, uniFLOW Secure Print*), Recieve Data Security(Confidential Fax Inbox Forwarding Received Documents Automatically), Scan Security (Encrypted PDF, Device Signature PDF/XPS, User Signature PDF/XPS, Adobe LiveCycle® Rights Management ES2.5 Integration), Scan Security (Encrypted PDF, Device Signature PDF/XPS, User Signature PDF/XPS*), Send Data Security (Setting for requesting password input per transmission, Restricted E-mail/File send functions, Confirming FAX number, Allow/Restrict Fax Driver Transmissions, Allow/Restrict Sending from History, S/MIME Support), Document Tracking (Secure Watermark)	SOFTWARE AND PRINTER MANAGEMENT	
	*1 Requires optional uniFLOW Online / uniFLOW	Tracking and reporting	uniFLOW Online
	*2 Requires optional Universal Send Digital User Signature Kit-C1	Remote management tools	iW Enterprise Management Console eMaintenance Content Delivery System
Network Security	TLS1.3, IPsec, IEEE802.1X authentication (LAN/WLAN), SNMPv3, Firewall Functionality(IP/MAC Address Filtering), WPA3 support, Dual Network Support (Wired LAN/Wireless LAN, Wired LAN/Wired LAN), Disabling Unused Functions (Enabling/Disabling Protocols/Applications, Enabling/Disabling Remote UI, Enabling/Disabling USB Interface), Communication Line Separation (G3 FAX, USB Port, Advanced Space, Scan and Send -Virus Concerns for E-mail Reception)	Scanning software	Network ScanGear2
Device Security	Standard Storage Initialize, Job Log Conceal Function, Protecting MFP Software Integrity, Checking MFD Software Integrity & Platform Firmware Resiliency (NIST SP800-193) with Automatic System Recovery (Verify System at Start-up, Runtime Intrusion Detection enabled with Trelix Embedded Control)	PAPER SUPPLY OPTIONS	
Device Management and Auditing	Administrator Password, Digital Certificate and Key Management, Audit Log, Cooperating with External Security Audit System (Security Information and Event Management), Security Policy Setting	Cassette Feeding Unit-AV1	Paper Capacity: 550 sheets x 1 (80 gsm) Paper Type: Thin, Plain, Heavy, Recycled, color, Pre-punched, Bond, Labels Paper Size: A4R, A5, A5R, A6R, B5R, B6R Custom Size: 101.6 × 148.0mm-216.0 × 355.6mm Paper Weight: 60 to 163 gsm Dimensions (W x D x H): 597 x 635 x 225 mm Weight: Approx. 15.5 kg
ENVIRONMENTAL SPECIFICATIONS		Paper Feeder PF-D1	Paper Capacity: 550 sheets x 1 (80 gsm) Paper Type: Thin, Plain, Heavy, Recycled, color, Pre-punched, Bond, Labels Paper Size: A4R, A5, A5R, A6R, B5R, B6R Custom Size: 101.6 × 148.0mm-216.0 × 355.6mm Paper Weight: 60 to 163 gsm Dimensions (W x D x H): 458 x 464 x 130 mm Weight: Approx. 6.1 kg
Operating Environment	Temperature: 10 to 30 °C Humidity: 20 to 80% RH (Relative Humidity)	HARDWARE ACCESSORIES	
Power source	220-240V 50/60Hz 10A	OTHERS	MiCARD Attachment Kit-B1 Plain Pedestal-AA1 Plain Pedestal-P2
Power consumption	Maximum: Approx. 1,500 W Active printing C1538iF II: Approx. 701W C1533iF II: Approx. 678W Standby: Approx. 40.6 W*1 Sleep mode: Approx. 0.9 W*2	SYSTEM AND CONTROLLER OPTIONS	
	*1 Reference value: measured one unit *2Sleep mode is not available in all circumstances due to certain settings.	Print Accessories	PCL International Font Set-A1
	Typical Electricity Consumption (TEC)* :	SEND OPTIONS	Universal Send Trace & Smooth PDF Kit-A1 Universal Send Digital User Signature Kit-C1
	C1538iF II: 0.37kWh C1533iF II: 0.34kWh	Barcode Printing	Barcode Printing Kit-D1
	*As per US ENERGY STAR version 3.2	OTHER OPTIONS	
Noise levels (BW/CL)	Sound Power Level (LWA,m) C1538iF II Active(1-sided): 6.2B*1 , Kv 0.3B*1 *1 Reference value: measured only one unit with ISO7779, described with ISO9296:2017 C1533iF II Active(1-sided): 6.1B*1 , Kv 0.3B*1 *1 Reference value: measured only one unit with ISO7779, described with ISO9296:2017 Sound Pressure Level (LpAm) Bystander's position: Active (1-sided): 50 dB*1 *1 Reference value: measured only one unit with ISO7779, described with ISO9296:2017	Accessibility Accessories	ADF Access Handle-A1 TELEPHONE 6 KIT Long cord Cool White

Software & Solutions



Compatibility



Canon Inc.
canon.com

Canon Europe
canon-europe.com

English edition
© Canon Europa N.V.,2024

i-SENSYS X C1530iF II Series

ONE OF THE MOST SECURE, SUSTAINABLE AND PRODUCTIVE MULTIFUNCTION DEVICES IN I-SENSYS X RANGE

MAIN CONFIGURATION OPTIONS

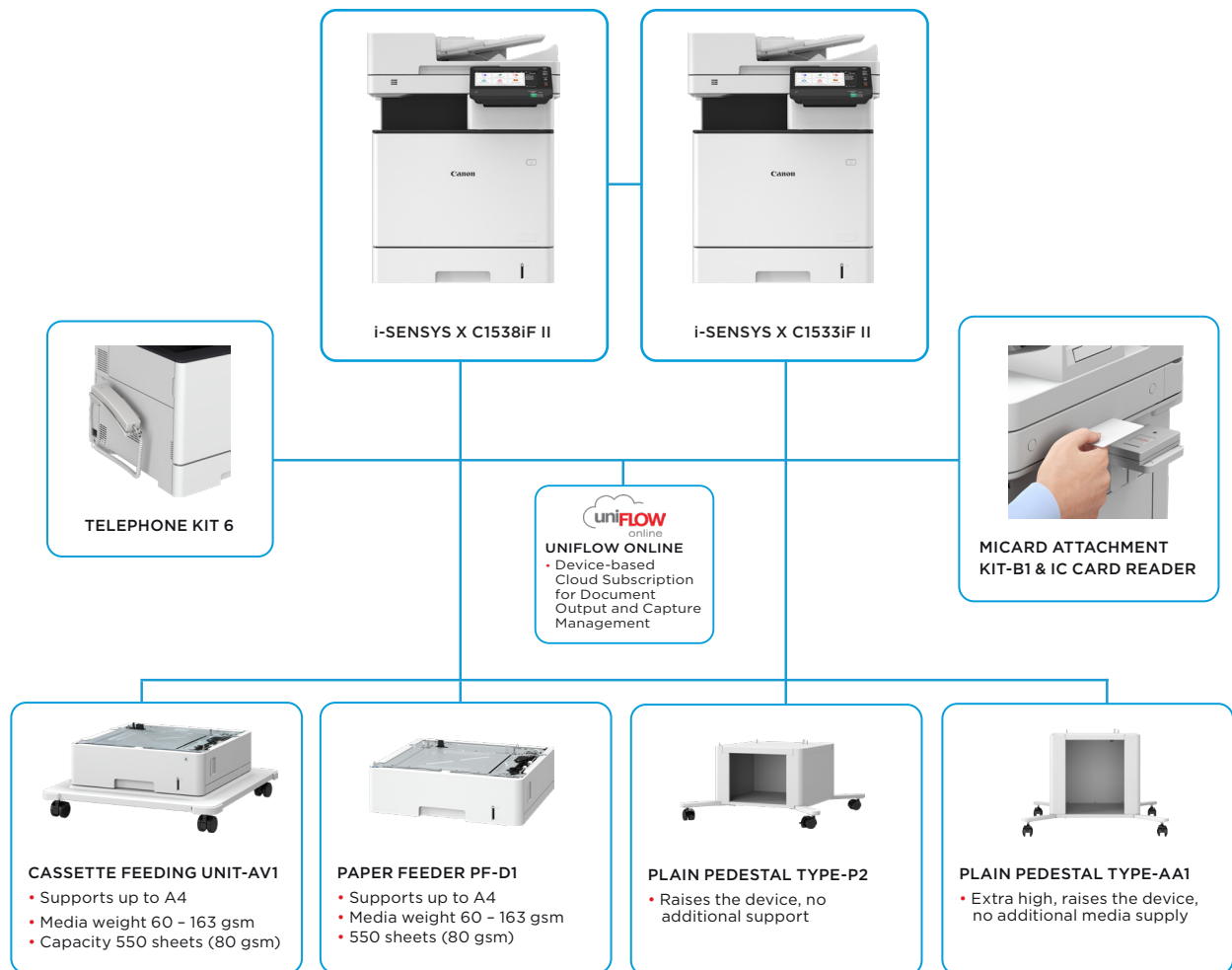

This flat configuration is for illustration purpose only. For a complete list of options and the exact compatibility relationships, please refer to the [online product configurator](#)

